

CERTIFIED LAND CORNER RESTORATION

Index No. 0-17

State of Wisconsin }
County of LINCOLN } ss.

I WILLIAM IMMICH, do hereby certify that on the 5th day of DECEMBER, 1984, I found evidence of the WEST 1/4 corner of SECTION 23 Township 33, North, Range 5 EAST, Fourth, Principal Meridian, as described hereon; and that from this evidence I established a new monument and accessories as described hereon to perpetuate the original location of this corner.

Resident witnesses:

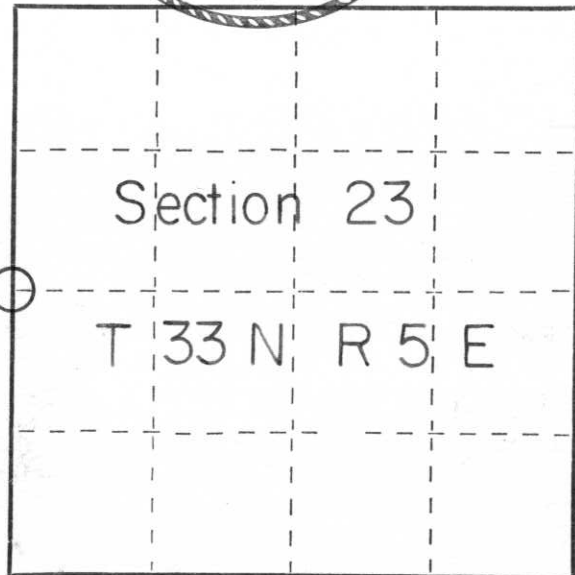
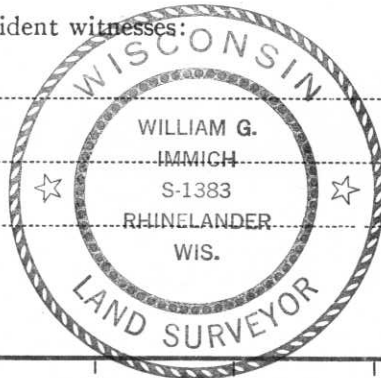

○ = Corner monument restored.

History of original corner establishment:

1854 - JACKSON PRENTICE, GOVERNMENT SURVEYOR, SET 1/4 POST AT 40.00 CHAINS MADE BEARING TREES - BIRCH 8 S40 E 121K; MAPLE 12 N28W 281K
1937 - F. FOX RAN SOUTH BETWEEN 22-23, 2731.5 SET 1/4 EAST 29.9' (GRANITE MONUMENT) NOTHING TO WITNESS 38' NORTH TO OLD ROAD TO CAMP

Description of corner evidence found:

FOUND SQUARE GRANITE MONUMENT SET BY F. FOX, DISTANCE NORTH TO SECTION CORNER 2681.11' (2731.5)

Description of monument and accessories I established to perpetuate the original location of this corner.

MONUMENT IN GOOD CONDITION - MADE NEW BEARING TREES*:
E1M 10" N 88° W 71.20'
OAK 2" S 16° W 35.95'
W. SPRUCE 3" S 34° W 29.40'

* BEARINGS MAG. - DISTANCE TO FACE OF BLAZE

Dated at RHINELANDER, Wis., this 5th day of DECEMBER, 1984

Signature William Immich Title REGISTERED LAND SURVEYOR Registration No. 1383
(County Surveyor, Registered Land Surveyor, or other duly authorized official)

Office of Register of Deeds, County of _____, I hereby certify that the within instrument was filed in this office for record on the _____ day of _____, 19____ at _____ o'clock _____ M.

(Register of Deeds)

By _____ Deputy









