

CERTIFIED LAND CORNER RESTORATION

Index No. Q-15

State of Wisconsin }
County of Lincoln } ss.

I Edwin R. Abendroth, do hereby certify that on the 9th day of May, 19 85, I found evidence of the South 1/4 corner of Section 22 Township 32, North, Range 8 East, Fourth, Principal Meridian, as described hereon; and that from this evidence I established a new monument and accessories as described hereon to perpetuate the original location of this corner.

Resident witnesses:

.....
.....
.....

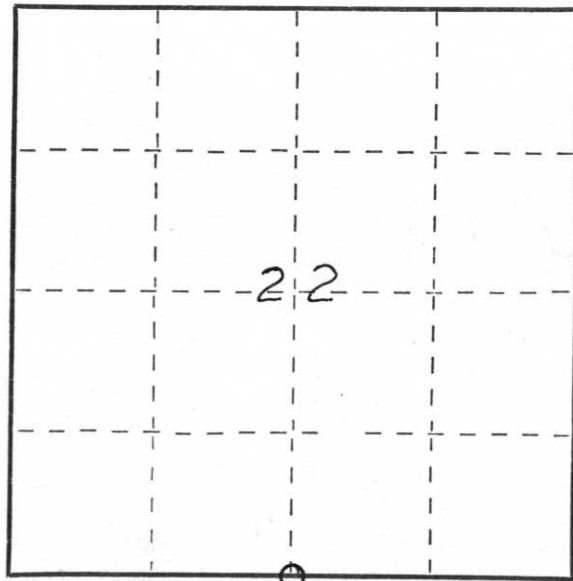

○ = Corner monument restored.

History of original corner establishment:

Wood post set by original Government survey.

Description of corner evidence found:

Found 8" X 8" granite stone in place and in good condition.
Set iron pipe on top of stone to aid in location.

Description of monument and accessories I established to perpetuate the original location of this corner.

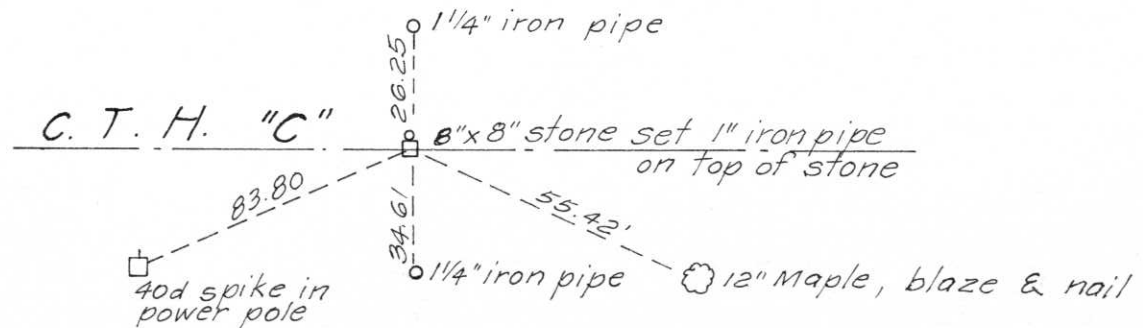

Dated at Wausau, Wis., this 13th day of May, 19 85

Signature Edwin R. Abendroth Title surveyor Registration No. S-798
(County Surveyor, Registered Land Surveyor, or other duly authorized official)

Office of Register of Deeds, County of _____, I hereby certify that the within instrument was filed in this office for record on the _____ day of _____, 19 _____ at _____ o'clock _____ M.

.....
(Register of Deeds)
By _____ Deputy

