

# LINCOLN COUNTY U.S. PUBLIC LAND SURVEY MONUMENT LOCATION RECORD

CORNER NUMBER \_\_\_\_\_  
 SECTION 35  
 TOWNSHIP 32 NORTH  
 RANGE 7 EAST

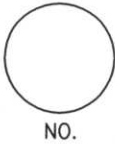

LANDMARK       BENCHMARK \_\_\_\_\_  
 CORNER IDENTITY: 6"X6" SCRIBED GRANITE STONE  
 FOUND  SET   
 RESET   
 RE-TIED

SCHLEY  
 CITY, VILLAGE, TOWN

LINCOLN COUNTY COORDINATE: N: \_\_\_\_\_  
 E: \_\_\_\_\_

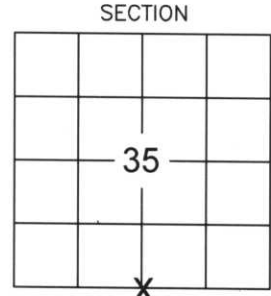

ELEVATION-(FEET): \_\_\_\_\_ DATUM: \_\_\_\_\_

WEATHER: CLOUDY AND WINDY

DATE OF SURVEY: NOVEMBER 29, 2007 TEMPERATURE: 20 °F

SURVEY PARTY: K.J.W./N.J.W.

## BASIS FOR MONUMENT LOCATION:

(DESCRIBE METHOD OF SURVEY AND CORNER AUTHENTICATION)

WE FOUND A 6"X6" SCRIBED GRANITE STONE AS SHOWN ON RECORD TIE SHEET, BUT ALL TIES WERE DESTROYED. WE THEN SET FOUR NEW LINCOLN COUNTY TIES AND PERPETUATED AS SHOWN BELOW.



CERTIFIED CORRECT:  
NATHAN J WINCENTZEN  
Nathan J Wincentzen  
 Registered Land Surveyor  
 DATE: 12-6-07

FIELD BOOK NO. 15 PAGE NO. 31  
 COMPANY RIVERSIDE LAND SURVEYING LLC

## TIE SKETCH:

SHOW MINIMUM OF FOUR (4) HORIZONTAL TIE DISTANCES TO FIXED WITNESS MONUMENTS. DESCRIBE ALL MONUMENTS FOUND OR SET. CORRECT ALL DISTANCES SHOWN TO STANDARD TEMPERATURE OF 68° F.

- 6"X6" SCRIBED GRANITE STONE
- 3/4"X30" REBAR WITH ALUMINUM CAP

**NOTE**  
 - ALL BEARINGS ARE FROM A HAND HELD MAGNETIC COMPASS  
 - THIS DRAWING IS NOT TO SCALE

RECEIVED BY LINCOLN COUNTY SURVEYOR THIS 7<sup>TH</sup> DAY OF December 20 07  
Tommy Wall  
 COUNTY SURVEYOR

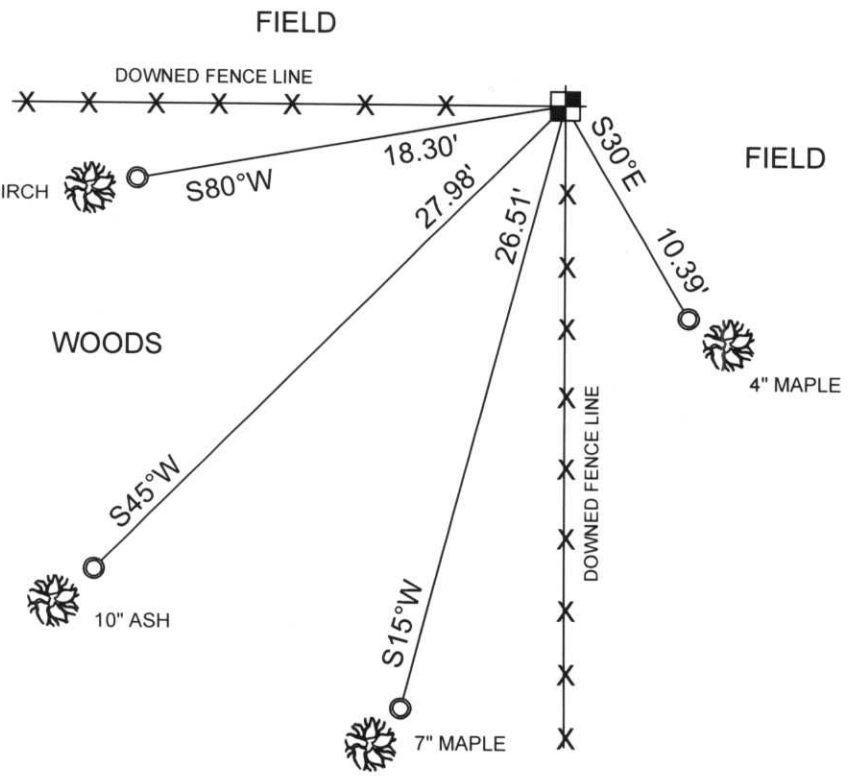

61-19

CERTIFIED LAND CORNER RESTORATION

Index No. A-19

State of Wisconsin }  
County of Lincoln } ss.

History of original corner establishment:

Wood post set by original Government Surveyor.

I, Sheridan D. Schwark, do hereby certify that on the 20th day of November, 1980, I found evidence of the N 1/4 corner of Section 2 Township 31, North, Range 7 East, Fourth, Principal Meridian, as described hereon; and that from this evidence I established a new monument and accessories as described hereon to perpetuate the original location of this corner.

Resident witnesses:

.....  
.....  
.....

Description of corner evidence found:

We found a 6" x 6" red granite stone monument at a fence corner. The stone was scribed 1/4 S and was up approximately 1' above grade. The stone was tipped westerly. We straightened the stone and set the witness monuments shown below.



Description of monument and accessories I established to perpetuate the original location of this corner.

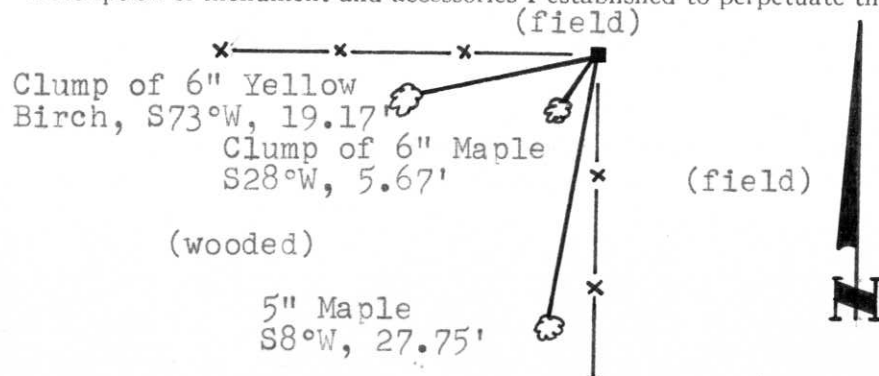

NOTE: All ties are P.K. nails set in blazed trees.

Dated at Merrill, Wis., this 26<sup>th</sup> day of November, 1980.

Signature Sheridan D. Schwark Title Registered Land Surveyor Registration No. S-1205  
(County Surveyor, Registered Land Surveyor, or other duly authorized official)

Office of Register of Deeds, County of \_\_\_\_\_, I hereby certify that the within instrument was filed in this office for record on the \_\_\_\_\_ day of \_\_\_\_\_, 19\_\_\_\_ at \_\_\_\_\_ o'clock \_\_\_\_\_ M.

(Register of Deeds)

By \_\_\_\_\_ Deputy

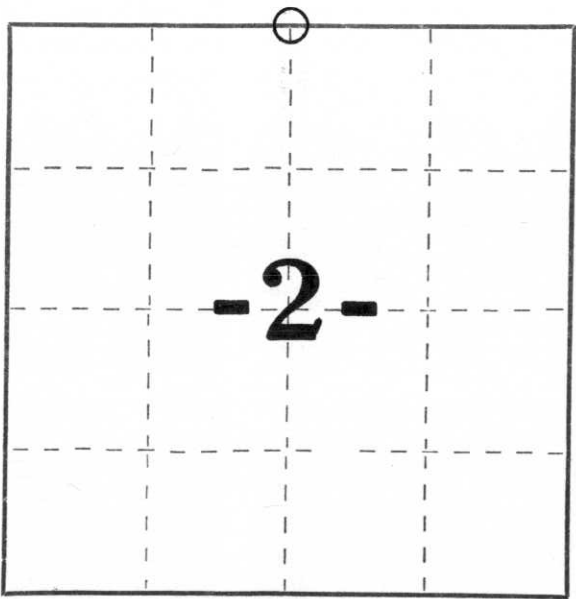

○ = Corner monument restored.