

CERTIFIED LAND CORNER RESTORATION

Index No. E-21

State of Wisconsin }
 County of Lincoln } ss.

I, Sheridan D. Schwark, do hereby certify that on the 7th day of November, 1979, I found evidence of the Southwest corner of Section 1 Township 32, North, Range 7 East, Fourth, Principal Meridian, as described hereon; and that from this evidence I established a new monument and accessories as described hereon to perpetuate the original location of this corner.

Resident witnesses:

.....

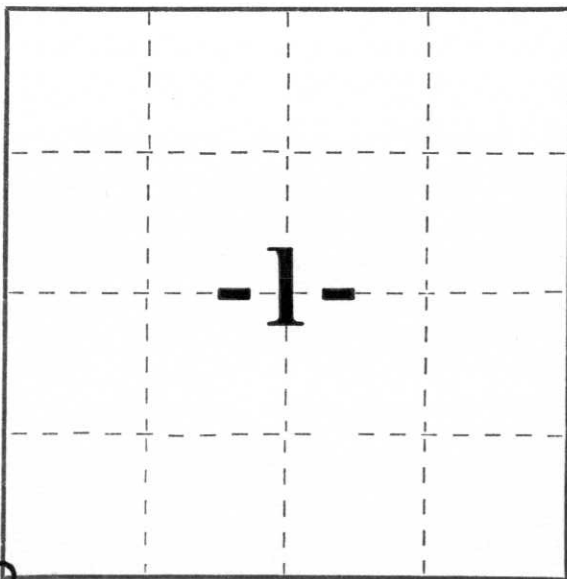

○ = Corner monument restored.

History of original corner establishment:

Date: April, 1852
 Surveyor: A.G. and F.S. Ellis
 Monument: Wood Post
 Witnesses: 10" Hemlock, S.32°W., 11 links
 8" Hemlock, N.53°E., 24 links

Description of corner evidence found:

We searched at a North - South fenceline just north of the centerline of Heineman Road with a backhoe operated by Arnold Wyland Jr. We searched in this area due to testimony by Mrs. Tom Kennedy (life long resident of the property Northwest of the corner). We found a 7" x 7" x 30" granite stone with a scribed X on the top. The stone was tipped northeasterly, however the bottom looked to be in its original position. The stone was in line with the fenceline and about 4 feet north of the road centerline. Mrs. Kennedy had remembered buggies driving around the south side of the stone when she was a small girl, which is why she felt we'd find it North of the intersection.

Description of monument and accessories I established to perpetuate the original location of this corner.

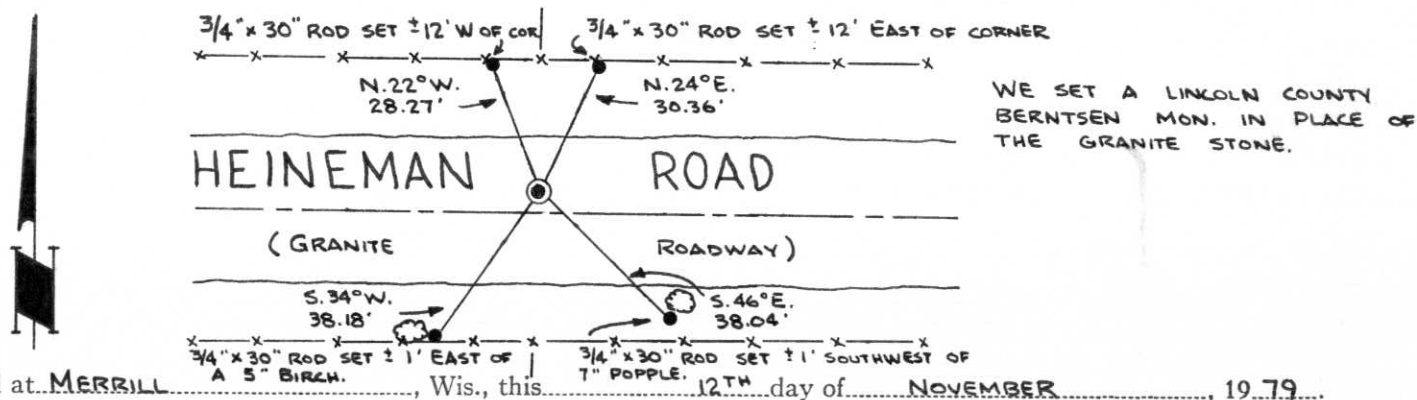

Dated at MERRILL, Wis., this 12th day of NOVEMBER, 1979.

Signature Sheridan D. Schwark Title Registered Land Surveyor Registration No. S-1205
 (County Surveyor, Registered Land Surveyor, or other duly authorized official)

Office of Register of Deeds, County of _____, I hereby certify that the within instrument was filed in this office for record on the _____ day of _____, 19____ at _____ o'clock _____ M.

(Register of Deeds)

By _____ Deputy