

CERTIFIED LAND CORNER RESTORATION

Index No. C-5

State of Wisconsin }
County of Lincoln } ss.

I Sheridan D. Schwark, do hereby certify that on the 24th day of November, 1983, I found evidence of the West one-quarter corner of Section 5 Township 32, North, Range 7 East, Fourth, Principal Meridian, as described hereon; and that from this evidence I established a new monument and accessories as described hereon to perpetuate the original location of this corner.

Resident witnesses:

.....
.....
.....

History of original corner establishment:
Wood post set by original Government Surveyor

Description of corner evidence found:

I found a 6"x6" red granite monument up approximately .5'. There was a fenceline running southerly and easterly from the corner. The corner is situated in a Tamarack swamp approximately 200' from high ground.

I blazed and scribed the trees shown below.

Description of monument and accessories I established to perpetuate the original location of this corner.

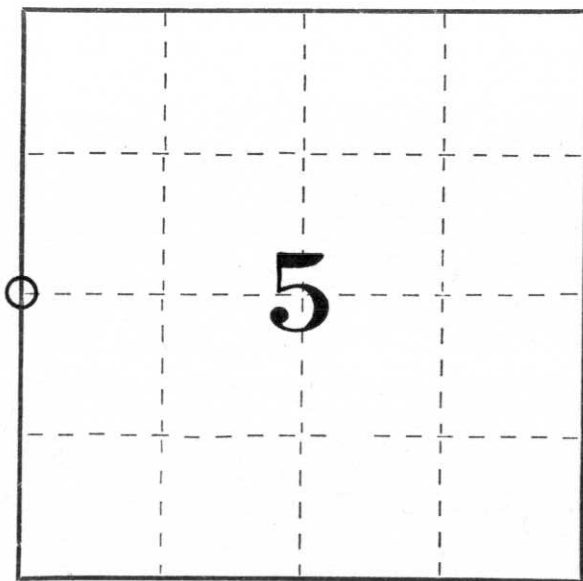

○ = Corner monument restored.

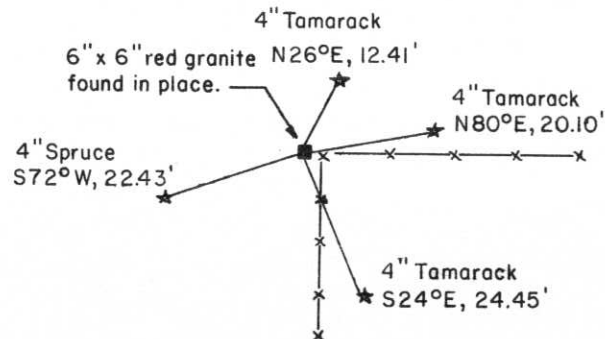

Dated at Merrill, Wis., this 28th day of November, 1983

Signature Sheridan D. Schwark Title Registered Land Surveyor Registration No. S-1205
(County Surveyor, Registered Land Surveyor, or other duly authorized official)

Office of Register of Deeds, County of....., I hereby certify that the within instrument was filed in this office for record on the.....day of....., 19..... at.....o'clock..... M.

.....
(Register of Deeds)

By.....Deputy