

# U.S. PUBLIC LAND SURVEY MONUMENT RECORD

Note: This form is intended and designed to fulfill all requirements of Wisconsin Administrative Code, Chapter A-E 5.02, U.S. Public Land Survey Monument Record (3) (a) (b) (c) (d) (e) (f) (g) (h) (i). An additional sheet may be added if necessary to conform with said requirements.

(a) Corner location: Township 32 North

Range 6 East

Town/City/Village MERRILL

County LINCOLN

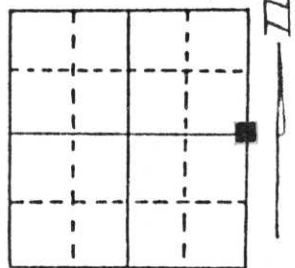

Section 33

(b) (f) (g) (h) Description of monument found at this corner and if it was accepted, state all evidence (material, testimonial, occupational, plats, records, other monuments) used as a basis for accepting. If not accepted or if nothing was found, state evidence used as basis for establishing location. If reestablished through lost corner proportionate methods, indicate all monuments, distances and directions used to establish.

Excavated at center of road and fence line did not find any monument.  
Tied corner into section traverse calculated corner location fit well. Set corner on fence line and center of road.

(c) (d) (e) Plan view of corner with ties to at least 4 witness monuments. If in disagreement with previously established corner, show the distances between the two corners and also indicate the ties to the disputed corner.

Set 3/4" X 30" iron bars with caps at witness corners. Bearings referenced to section summary.

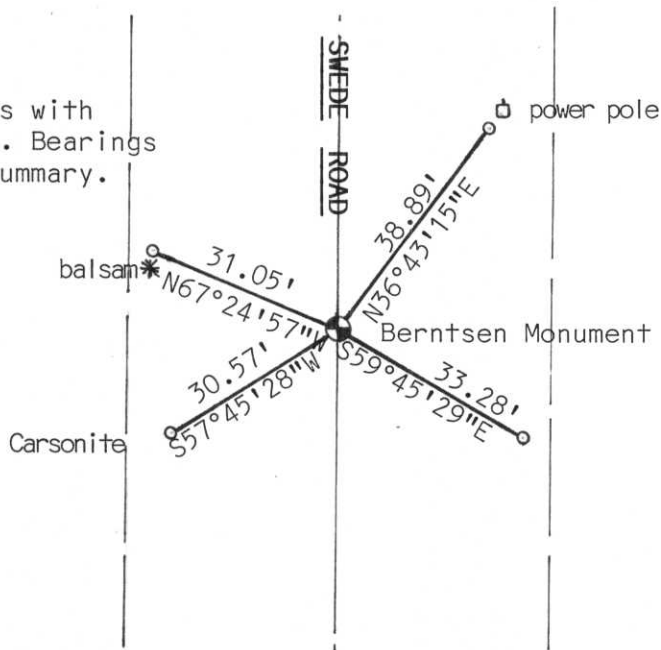

RECEIVED AT LINCOLN COUNTY  
 COURTHOUSE THIS 21st DAY  
 OF July 1997  
 OF Edwin R. Abendroth  
 TAX DESCRIPTION OFFICE

(i) I, Edwin R. Abendroth  
 (type or print name) certify that the corner location on this record was determined by me or under my direction and control and that this U.S. Public Land Survey Monument Record is correct and complete to the best of my knowledge and belief.

*Edwin R. Abendroth* July 18, 1997

Signature

Date

Index No. M-13