

U.S. PUBLIC LAND SURVEY MONUMENT RECORD

Note: This form is intended and designed to fulfill all requirements of Wisconsin Administrative Code, Chapter A-E 5.02, U.S. Public Land Survey Monument Record (3) (a) (b) (c) (d) (e) (f) (g) (h) (l). An additional sheet may be added if necessary to conform with said requirements.

(a) Corner location: Township 32 North
 Range 6 East
 Town/City/Village ROCK FALLS
 County Lincoln

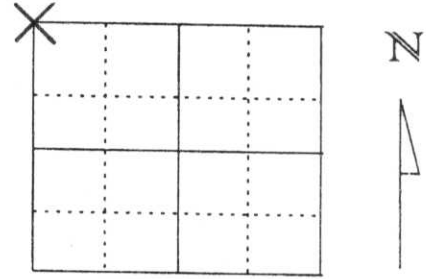

Section 18

(b) (f) (g) (h) Description of monument found at this corner and if it was accepted, state all evidence (material, testimonial, occupational, plats, records, other monuments) used as a basis for accepting. If not accepted or if nothing was found, state evidence used as basis for establishing location. If reestablished through lost corner proportionate methods, indicate all monuments, distances and directions used to establish.

IN JULY OF 1851 JAMES M. MARSH SET POST FOR SECTION CORNER WITH THE FOLLOWING TIES: SUGAR 14 S47°E 18 LINKS, BIRCH 12 S14°W 43 LINKS, SUGAR 12 N55°W 20 LINKS, SUGAR 12 N50°E 51 LINKS. IN 1943 FRANCIS FOX SET STONE MONUMENT FOR NORTHWEST CORNER. WE SURVEYED INTO CORNER LOCATION BASED ON HIS MAP AND NOTES. FOUND 6" x 6" GREY GRANITE MONUMENT WITH POLISHED TOP. STONE WAS HEAVED UP AND TIPPED. RE-SET MONUMENT FLUSH WITH GROUND AND SURROUNDED WITH ROCKS. STONE HAS "X" CUT ON TOP AND ENGRAVED SECTION NUMBERS. TIED OUT AS SHOWN BELOW.
 APPROXIMATE LATITUDE 45°15'54"N, LONGITUDE 89°47'49"W.

RECEIVED BY LINCOLN COUNTY
 SURVEYOR THIS 15TH DAY
 OF February 20 06
Tony Dalt
 COUNTY SURVEYOR

(c) (d) (e) Plan view of corner with ties to at least 4 witness monuments. If in disagreement with previously established corner, show the distances between the two corners and also indicate the ties to the disputed corner.

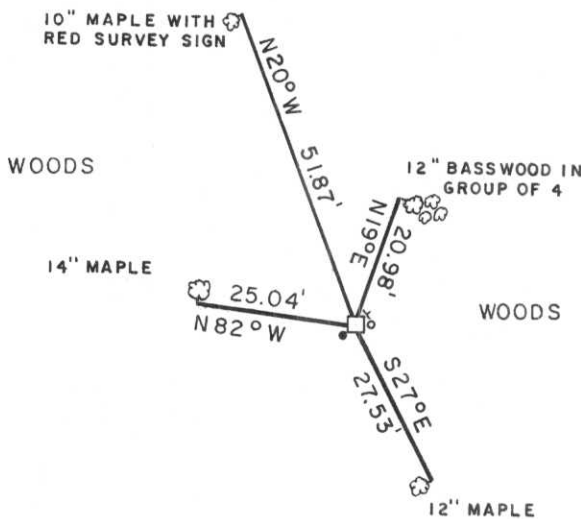

LEGEND

- EXISTING 6" X 6" BLACK AND GRAY GRANITE MONUMENT WITH POLISHED TOP AND ENGRAVED NUMBERS
- + WHITE WITNESS POST SET 0.6' NE OF GRANITE MONUMENT
- o EXISTING 2" IRON PIPE 2' HIGH WITH 3" X 3" SCRIBED PLATE
- EXISTING 1/2" IRON PIPE

NOTE: ALL POINTS MEASURED TO ON TREES ARE A PK NAIL IN BLAZE. BEARINGS SHOWN ARE BY COMPASS.

(I) I, DAVID J. GOSLIN
 (type or print name) certify that the corner location on this record was determined by me or under my direction and control and that this U.S. Public Land Survey Monument Record is correct and complete to the best of my knowledge and belief.

David J. Goslin
 Signature

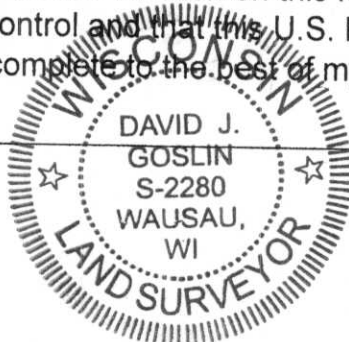

1-10-06
 Date

Index No. I-2











