

U.S. PUBLIC LAND SURVEY MONUMENT RECORD

Note: This form is intended and designed to fulfill all requirements of Wisconsin Administrative Code, Chapter A-E 5.02, U.S. Public Land Survey Monument Record (3) (a) (b) (c) (d) (e) (f) (g) (h) (i). An additional sheet may be added if necessary to conform with said requirements.

(a) Corner location: Township 32 North

Range 4 East

Town/City/Village CORNING

County LINCOLN

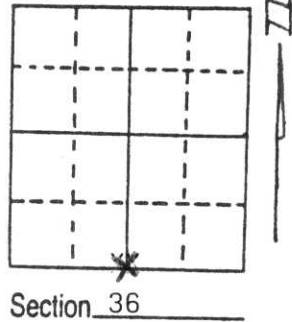

(b) (f) (g) (h) Description of monument found at this corner and if it was accepted, state all evidence (material, testimonial, occupational, plats, records, other monuments) used as a basis for accepting. If not accepted or if nothing was found, state evidence used as basis for establishing location. If reestablished through lost corner proportionate methods, indicate all monuments, distances and directions used to establish.

Set corner at split distance on straight line from SW corner to SE corner.
This location was determined from extensive work done throughout Sections 35 & 36 of T32N, R4E; and Section 1 & 2 of T31N, R1E.

Set 1" x 30" Iron Bar

(c) (d) (e) Plan view of corner with ties to at least 4 witness monuments. If in disagreement with previously established corner, show the distances between the two corners and also indicate the ties to the disputed corner.

SET PK IN TREE
PAINTED TREE RED W/ BLAZE MARKS
AND RED RIBBON ON TREE

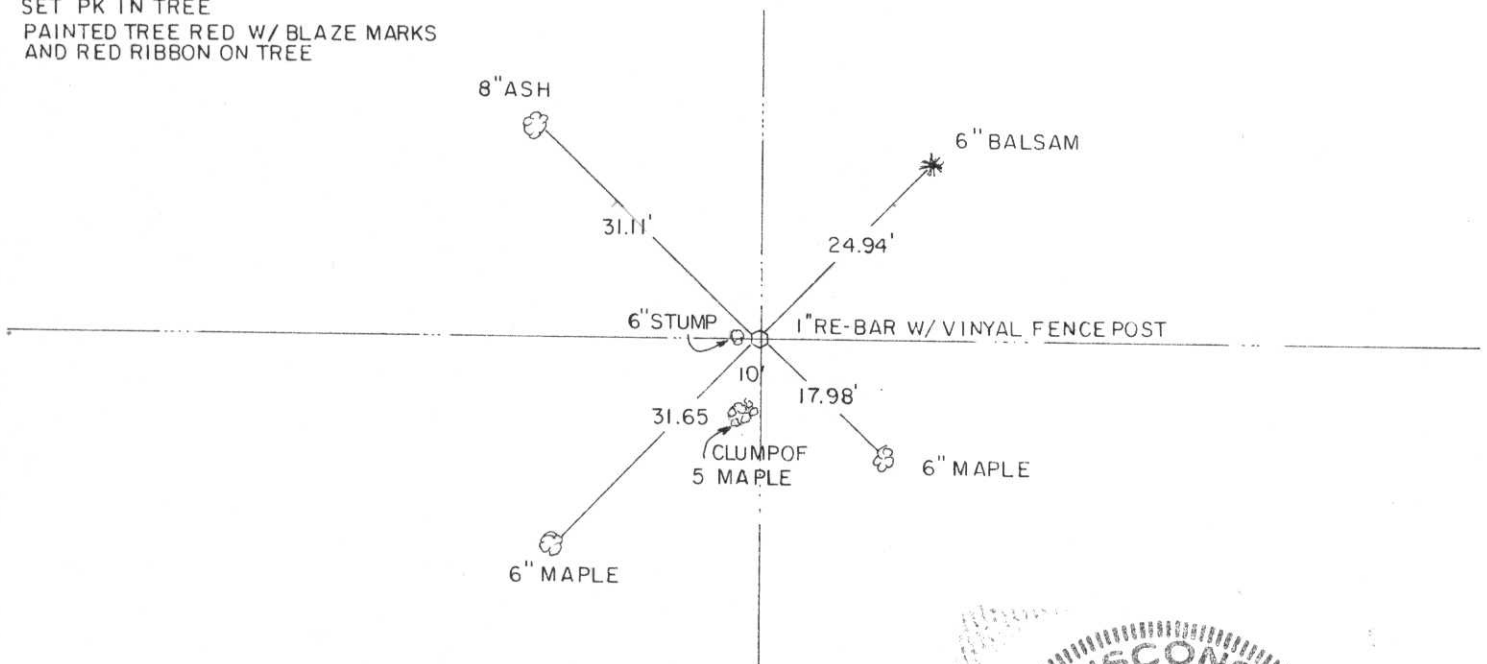

(i) I, Gary R. Krueger RLS NO. 1619
(type or print name) certify that the corner location on this record was determined by me or under my direction and control and that this U.S. Public Land Survey Monument Record is correct and complete to the best of my knowledge and belief.

Gary R. Krueger 2-20-95
Signature Date

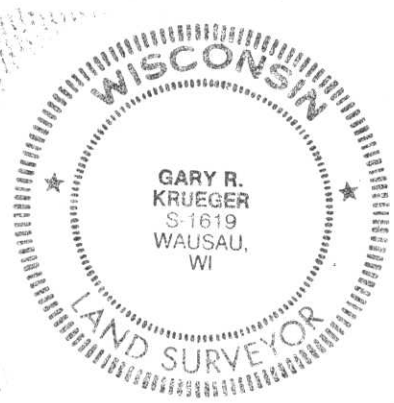

Index No. 1-23

received
2/21/95





