

CERTIFIED LAND CORNER RESTORATION

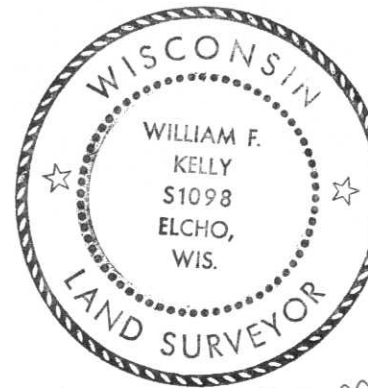

Index No. M-7

State of Wisconsin }
 County of LINCOLN } ss.

I WILLIAM F. KELLY, do hereby certify that on the 22nd day of JANUARY, 1975, I found evidence of the SOUTH 1/4 corner of SECTIONS 17 & 20 Township 32, North, Range 4 EAST, Fourth, Principal Meridian, as described hereon; and that from this evidence I established a new monument and accessories as described hereon to perpetuate the original location of this corner.

Resident witnesses:

.....

History of original corner establishment:

Description of corner evidence found:

LOCATED A SQUARED POST MARKED 1/4 S 5 17 20. POST WAS DOWN.
OLD BEARING TREES SCRIBED.

William F. Kelly

Description of monument and accessories I established to perpetuate the original location of this corner.

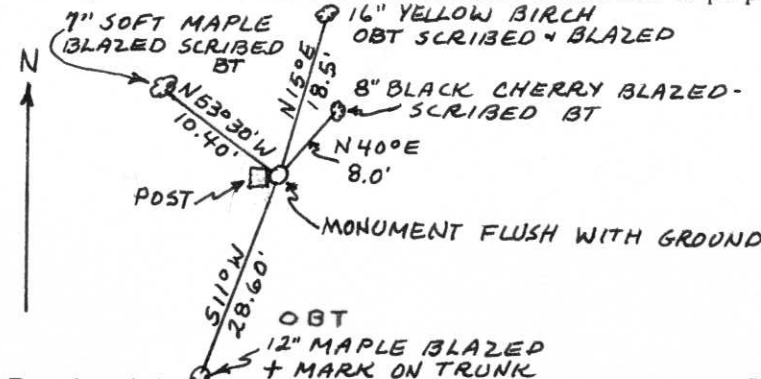

POST RESET FROM BEARING TREES AS REF. TO NEW MONUMENT.

NEW MONUMENT MARKED:

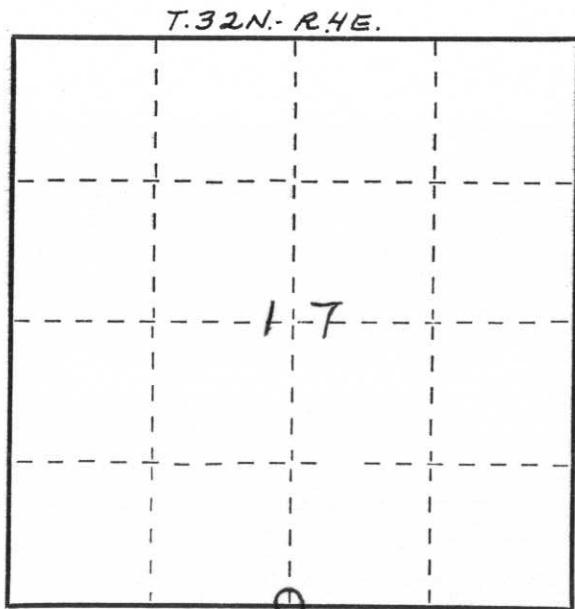

○ = Corner monument restored.

Dated at ELCHO, Wis., this 22nd day of JANUARY, 1975.

Signature William F. Kelly Title REGISTERED LAND SURVEYOR Registration No. 51098
 (County Surveyor, Registered Land Surveyor, or other duly authorized official)

Office of Register of Deeds, County of _____, I hereby certify that the within instrument was filed in this office for record on the _____ day of _____, 19____ at _____ o'clock _____ M.

.....
 (Register of Deeds)

By _____ Deputy





