

LINCOLN COUNTY U.S. PUBLIC LAND SURVEY MONUMENT LOCATION RECORD

CORNER NUMBER 113182

SECTION 11

TOWNSHIP 31 NORTH

RANGE 8 EAST

PINE RIVER

CITY, VILLAGE, TOWN

LANDMARK BENCHMARK _____ FOUND SET
 CORNER IDENTITY: NORTH 1/4 CORNER RESET
 RE-TIED

LINCOLN COUNTY COORDINATE: N: 126750.86
 E: 452454.07

ELEVATION-(FEET): _____ DATUM: _____

WEATHER: MOSTLY CLOUDY

DATE OF SURVEY: 12-10-05 TEMPERATURE: 20 °F

SURVEY PARTY: NATHAN WINCENTSEN, KEITH WALKOWSKI

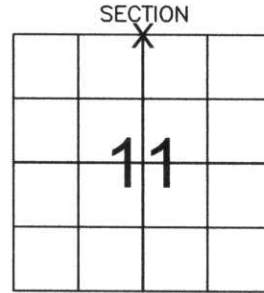

LOCATION (Indicated By X)



BASIS FOR MONUMENT LOCATION:

(DESCRIBE METHOD OF SURVEY AND CORNER AUTHENTICATION)

SEARCHED FOR NORTH 1/4 CORNER ALONG NORTH-SOUTH FENCE LINE. FOUND GRANITE STONE LAYING DOWN. RESET STONE IN HOLE FOUND AT THE BASE OF STONE. ACCEPTED STONE AS THE NORTH 1/4 CORNER AND PERPETUATED AS SHOWN BELOW.

CERTIFIED CORRECT:

Keith J. Walkowski
KEITH J. WALKOWSKI

Registered Land Surveyor

DATE: Jan. 3RD, 2006

FIELD BOOK NO. PINE RIVER PAGE NO. 42

COMPANY RIVERSIDE LAND SURVEYING LLC

TIE SKETCH:

SHOW MINIMUM OF FOUR (4) HORIZONTAL TIE DISTANCES TO FIXED WITNESS MONUMENTS. DESCRIBE ALL MONUMENTS FOUND OR SET. CORRECT ALL DISTANCES SHOWN TO STANDARD TEMPERATURE OF 68° F.

- FOUND GRANITE STONE
- SET 3/4" REBAR WITH ALUMINUM CAPS
- VINYL SURVEY MARKER POST

NOTE

- ALL BEARINGS ARE FROM A HAND HELD MAGNETIC COMPASS
- THIS DRAWING IS NOT TO SCALE

TAG ALDERS

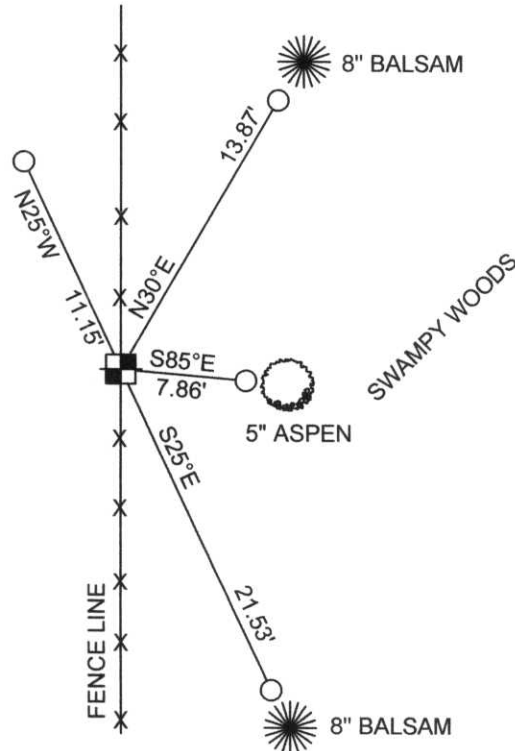

RECEIVED BY LINCOLN COUNTY SURVEYOR THIS 6TH DAY OF January 20 06
Tommy Daller
 COUNTY SURVEYOR

113182

Chicago Steel Rope