

MARATHON COUNTY

SURVEY MONUMENT LOCATION RECORD

SECTION 1
TOWNSHIP 30 N
RANGE 7 E
TEXAS
CITY, VILLAGE, TOWN

12
NO.

LANDMARK BENCHMARK _____ FOUND
CORNER IDENTITY: 6" X 6" STONE SET
STATE PLANE COORDINATE: N: _____ RE-SET
ZONE: _____ E: _____ RE-TIED
ELEVATION - (FEET): _____ DATUM: _____
THETA ANGLE: _____ WEATHER: _____
DATE OF SURVEY: 2-7-1975 TEMPERATURE: _____ °F
SURVEY PARTY: R.S. & C.N.

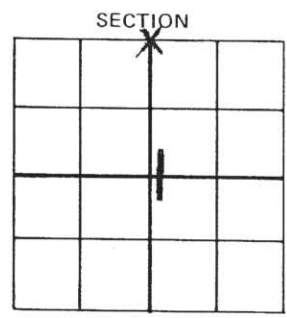

BASIS FOR MONUMENT LOCATION:
(DESCRIBE METHOD OF SURVEY AND CORNER AUTHENTICATION)

SEAL

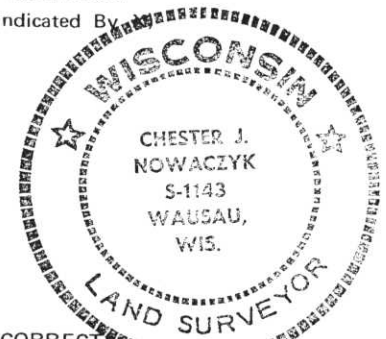

CERTIFIED CORRECT
Chester J. Nowaczyk
Registered Land Surveyor
DATE: 6-MARCH 29, 1982

FIELD BOOK NO. _____ PAGE NO. _____
COMPANY _____

TIE SKETCH: SHOW MINIMUM OF THREE (3) HORIZONTAL TIE DISTANCES TO FIXED WITNESS MONUMENTS. DESCRIBE ALL MONUMENTS FOUND OR SET. CORRECT ALL DISTANCES SHOWN TO STANDARD TEMPERATURE OF 68° F.

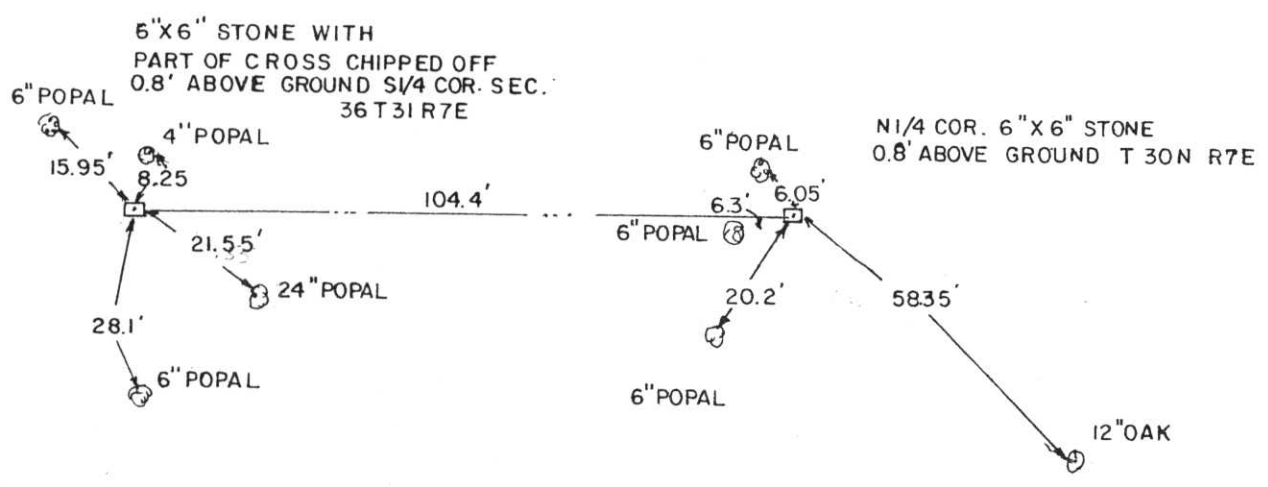

12
NO. 4-11-12