

**MARATHON COUNTY U.S. PUBLIC LAND
SURVEY MONUMENT LOCATION RECORD**

SECTION 4
TOWNSHIP 30
RANGE 7

6
NO.

LANDMARK BENCHMARK
CORNER IDENTITY: N 1/4 COR. 6"X6" STONE
STATE PLANE COORDINATE: N: _____
ZONE: _____ E: _____
ELEVATION - (FEET): _____ DATUM: _____
THETA ANGLE: _____ WEATHER: _____
DATE OF SURVEY: 5-16-88 TEMPERATURE: _____ °F
SURVEY PARTY: Nowaczyk, Krueger

FOUND
SET
RE-SET
RE-TIED

MAINE

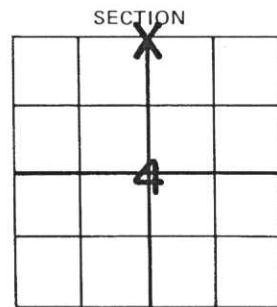

BASIS FOR MONUMENT LOCATION:

(DESCRIBE METHOD OF SURVEY AND CORNER AUTHENTICATION)

Found existing stone monument.

SEAL

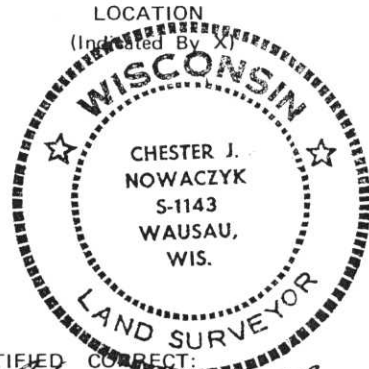

CERTIFIED CORRECT:

Maine #1 129
FIELD BOOK NO. _____ PAGE NO. _____
COMPANY SURVEYING SPECIALISTS

Chester J. Nowaczyk
Chester J. Nowaczyk RLS NO. 1143
Registered Land Surveyor
DATE: 5-20-88

TIE SKETCH:

SHOW MINIMUM OF FOUR (4) HORIZONTAL TIE DISTANCES TO FIXED WITNESS MONUMENTS. DESCRIBE ALL MONUMENTS FOUND OR SET. CORRECT ALL DISTANCES SHOWN TO STANDARD TEMPERATURE OF 68° F.

ALL TREES ARE BLAZED WITH PLAQUE IN BLAZE PK IN PLAQUE

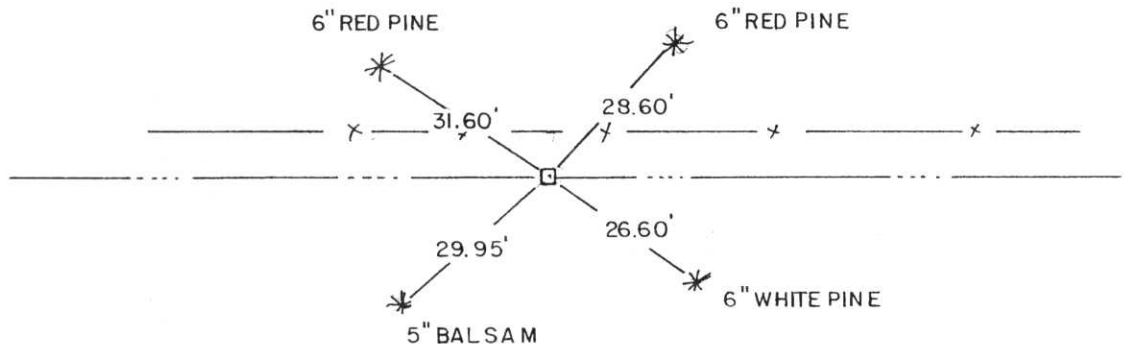

6
NO. 4-23, 24