

# MARATHON COUNTY U.S. PUBLIC LAND SURVEY MONUMENT LOCATION RECORD

SECTION 4  
TOWNSHIP 30  
RANGE 7

5  
NO.

LANDMARK  BENCHMARK  FOUND  SET

CORNER IDENTITY: 8" X 8" LIMESTONE NW COR RE-SET  RE-TIED

STATE PLANE COORDINATE: N: \_\_\_\_\_

ZONE: \_\_\_\_\_ E: \_\_\_\_\_

ELEVATION - (FEET): \_\_\_\_\_ DATUM: \_\_\_\_\_

THETA ANGLE: \_\_\_\_\_ WEATHER: \_\_\_\_\_

DATE OF SURVEY: 5-11-88 TEMPERATURE: \_\_\_\_\_ °F

SURVEY PARTY: Nowaczyk, Krueger

**MAINE**

~~CITY, TOWNSHIP, RANGE~~, TOWN

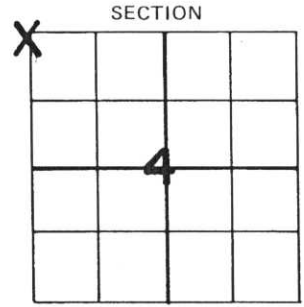

## BASIS FOR MONUMENT LOCATION:

(DESCRIBE METHOD OF SURVEY AND CORNER AUTHENTICATION)

Found existing stone monument. SEAL

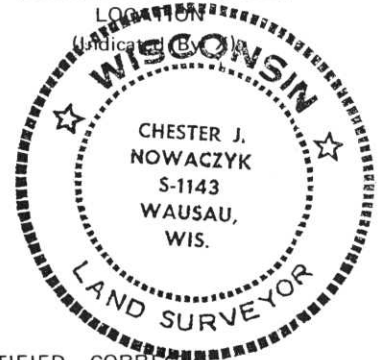

CERTIFIED CORRECT.

*Chester J. Nowaczyk*  
Chester J. Nowaczyk RLS NO. 1143

Registered Land Surveyor

DATE: 5-11-88

REVISED 9-1-98 C.J.N.

FIELD BOOK NO. Maine #1 PAGE NO. 126

COMPANY SURVEYING SPECIALISTS

## TIE SKETCH:

SHOW MINIMUM OF FOUR (4) HORIZONTAL TIE DISTANCES TO FIXED WITNESS MONUMENTS. DESCRIBE ALL MONUMENTS FOUND OR SET. CORRECT ALL DISTANCES SHOWN TO STANDARD TEMPERATURE OF 68° F.

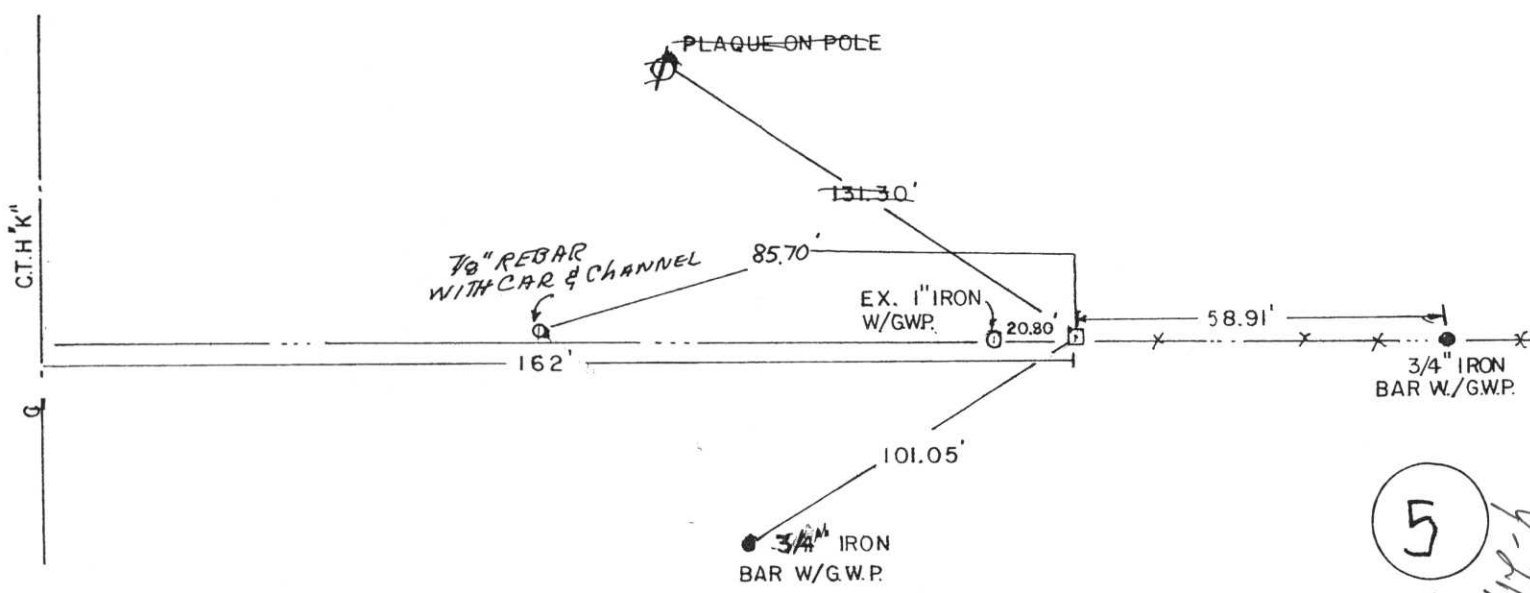

5  
NO.

4-11-88