

MARATHON COUNTY

SURVEY MONUMENT LOCATION RECORD

SECTION 1  
TOWNSHIP 30  
RANGE 5E

12

LANDMARK  BENCHMARK

FOUND   
SET   
RE-SET   
RE-TIED

HAMBURG  
CITY, VILLAGE, TOWN

NO.

CORNER IDENTITY: N 1/4 COR. (RAILROAD SPIKE)

STATE PLANE COORDINATE: N: \_\_\_\_\_

ZONE: \_\_\_\_\_ E: \_\_\_\_\_

ELEVATION - (FEET): \_\_\_\_\_ DATUM: \_\_\_\_\_

THETA ANGLE: \_\_\_\_\_ WEATHER: CLEAR CALM

DATE OF SURVEY: Nov 4, '77 TEMPERATURE: 52 °F

SURVEY PARTY: D. TLUSTY - J. FRYE

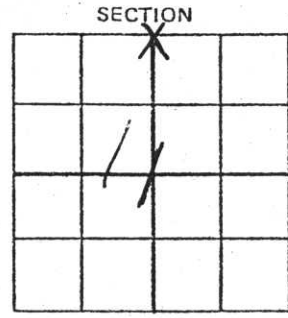

LOCATION  
(Indicated By X)



BASIS FOR MONUMENT LOCATION:

(DESCRIBE METHOD OF SURVEY AND CORNER AUTHENTICATION)

CORNER ESTABLISHED BY SINGLE PROPORTIONATE MEASUREMENT BETWEEN NW COR OF SECTION 1 + NE COR SECTION 1

SEAL



CERTIFIED CORRECT: David E. Tlusty 5-1390

FIELD BOOK NO. \_\_\_\_\_ PAGE NO. \_\_\_\_\_

COMPANY MIK CAPITAL SURVEYING INC  
MEDFORD WISCONSIN

Registered Land Surveyor

DATE: Nov 9, 1977  
Re-tied 6-26-87 CJN

TIE SKETCH:

SHOW MINIMUM OF THREE (3) HORIZONTAL TIE DISTANCES TO FIXED WITNESS MONUMENTS. DESCRIBE ALL MONUMENTS FOUND OR SET. CORRECT ALL DISTANCES SHOWN TO STANDARD TEMPERATURE OF 68° F.

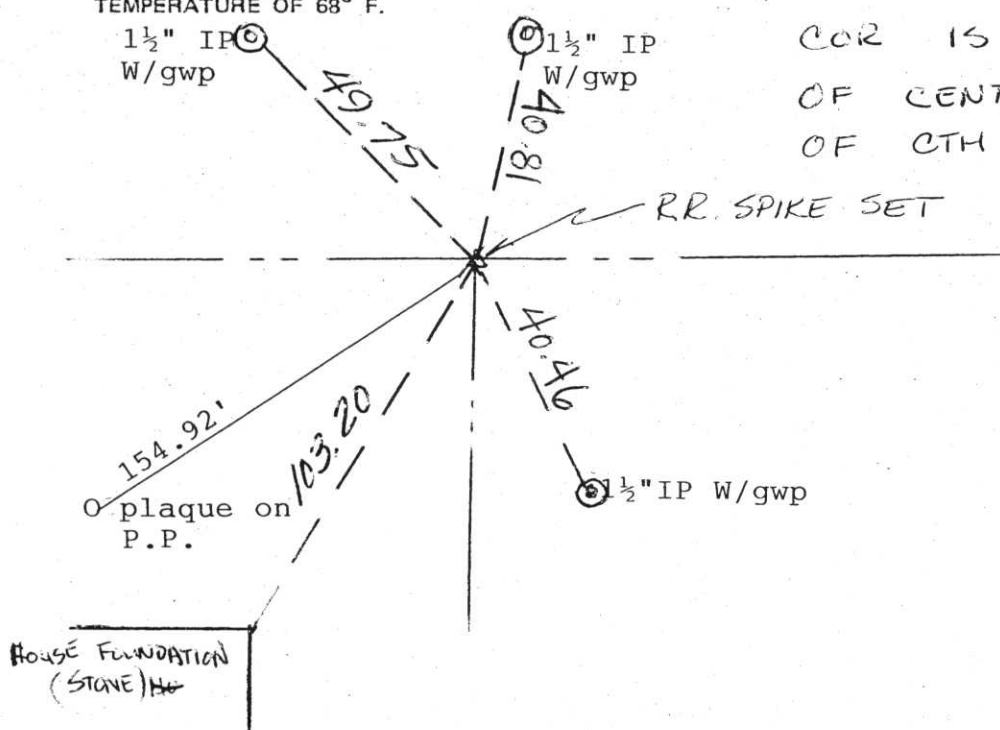

COR IS 4' ± NORTH OF CENTERLINE STRIPE OF CTH "FF".

12

4-13,14

NO.

CERTIFIED LAND CORNER RESTORATION

Index No. 4-13,14

State of Wisconsin }  
County of LINCOLN } ss.

History of original corner establishment:

I FRANCIS X FOX do hereby certify that on the \_\_\_\_\_ day of \_\_\_\_\_, 19 71, I found NO evidence of the NORTH 1/4 SECTION corner of SECTION 1 Township 30, North, Range 5 EAST, Fourth, Principal Meridian, as described hereon; and that from this evidence I established a new monument and accessories as described hereon to perpetuate the original location of this corner.

Description of corner evidence found:

NONE

Resident witnesses:

\_\_\_\_\_  
\_\_\_\_\_  
\_\_\_\_\_

Description of monument and accessories I established to perpetuate the original location of this corner.

DID NOT RELOCATE

DID EXTENSIVE DIGGING WITH BACKHOE

22.

MISSING (Sec 34 ~~36~~-31-5)

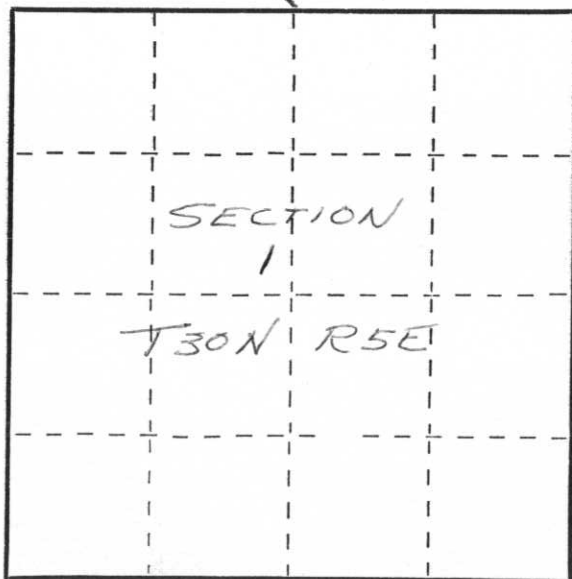

Dated at MERRILL, Wis., this 6TH day of DECEMBER, 19 72.

Signature Francis X Fox Title Highway Commissioner Registration No. 50046  
(County Surveyor, Registered Land Surveyor, or other duly authorized official)

Office of Register of Deeds, County of \_\_\_\_\_, I hereby certify that the within instrument was filed in this office for record on the \_\_\_\_\_ day of \_\_\_\_\_, 19 \_\_\_\_\_ at \_\_\_\_\_ o'clock \_\_\_\_\_ M.

\_\_\_\_\_  
(Register of Deeds)

By \_\_\_\_\_ Deputy

○ = Corner monument restored.