

MARATHON COUNTY

SURVEY MONUMENT LOCATION RECORD

SECTION 4
TOWNSHIP 30
RANGE 5

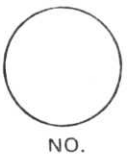

LANDMARK BENCHMARK

FOUND

SET

RE-SET

RE-TIED

CORNER IDENTITY: _____

STATE PLANE COORDINATE: N: _____

ZONE: _____ E: _____

ELEVATION - (FEET): _____ DATUM: _____

THETA ANGLE: _____ WEATHER: _____

DATE OF SURVEY: _____ TEMPERATURE: _____ °F

SURVEY PARTY: _____

Hamburg
CITY, VILLAGE, TOWN

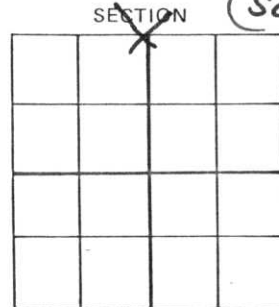

LOCATION
(Indicated By X)



BASIS FOR MONUMENT LOCATION:

(DESCRIBE METHOD OF SURVEY AND CORNER AUTHENTICATION)

Dug for corner in large area, SEAL found nothing. Set corner proportionate measure from east & west in center of road. 11-16-78

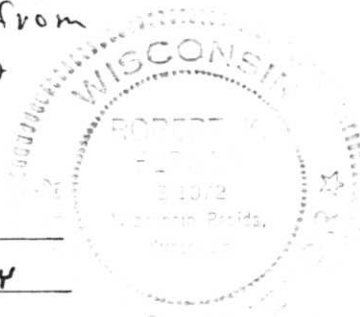

CERTIFIED CORRECT:

Robert K. Fergal

FIELD BOOK NO. FF PAGE NO. _____

COMPANY MARATHON CO. HWY

DATE: Sept. 20, 1979 Registered Land Surveyor

TIE SKETCH:

SHOW MINIMUM OF THREE (3) HORIZONTAL TIE DISTANCES TO FIXED WITNESS MONUMENTS. DESCRIBE ALL MONUMENTS FOUND OR SET. CORRECT ALL DISTANCES SHOWN TO STANDARD TEMPERATURE OF 68° F.

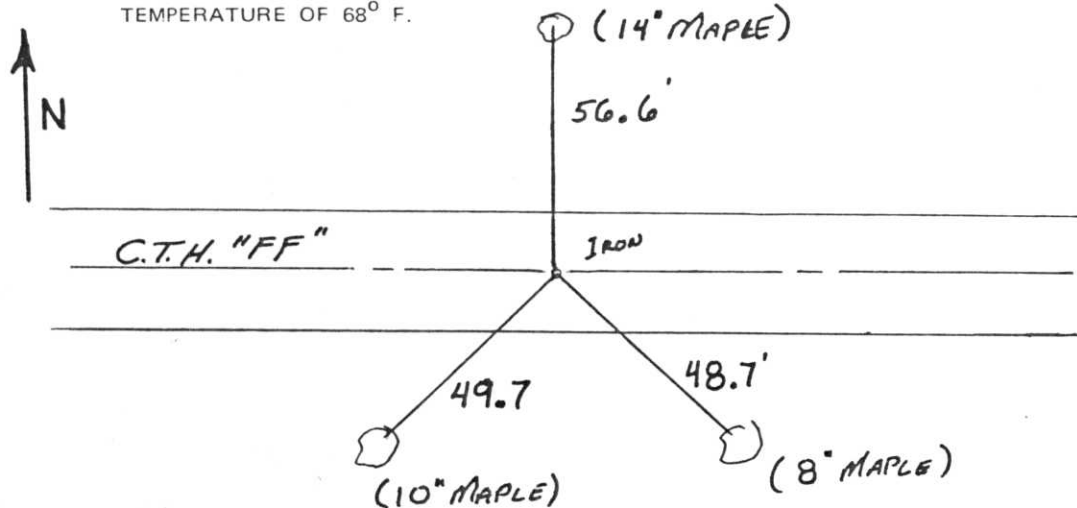

MARATHON COUNTY U.S. PUBLIC LAND SURVEY MONUMENT LOCATION RECORD

SECTION 4
TOWNSHIP 30
RANGE 5

6
NO.

LANDMARK BENCHMARK _____
CORNER IDENTITY: N¹/₄ Cor; PK Nail
STATE PLANE COORDINATE: N: _____
ZONE: _____ E: _____
ELEVATION - (FEET): _____ DATUM: _____
THETA ANGLE: _____ WEATHER: _____
DATE OF SURVEY: 1-30-86 TEMPERATURE: _____ °F
SURVEY PARTY: Nowaczyk, Krueger

FOUND
SET
RE-SET
RE-TIED

HAMBURG
~~WINDY LAKE~~ TOWN

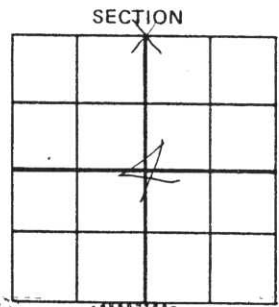

BASIS FOR MONUMENT LOCATION:

(DESCRIBE METHOD OF SURVEY AND CORNER AUTHENTICATION)

Re-tied corner and checked remaining ties. Added new ties. Had been tied by Fergot in 1979. SEAL

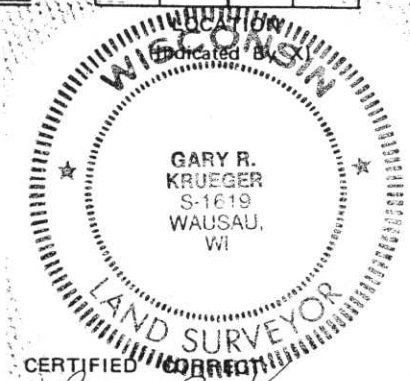

FIELD BOOK NO. _____ PAGE NO. _____
COMPANY Surveying Specialists

Gary R. Krueger RLS NO. 1619
Registered Land Surveyor
DATE: 1-31-86

TIE SKETCH:

SHOW MINIMUM OF FOUR (4) HORIZONTAL TIE DISTANCES TO FIXED WITNESS MONUMENTS. DESCRIBE ALL MONUMENTS FOUND OR SET. CORRECT ALL DISTANCES SHOWN TO STANDARD TEMPERATURE OF 68° F.

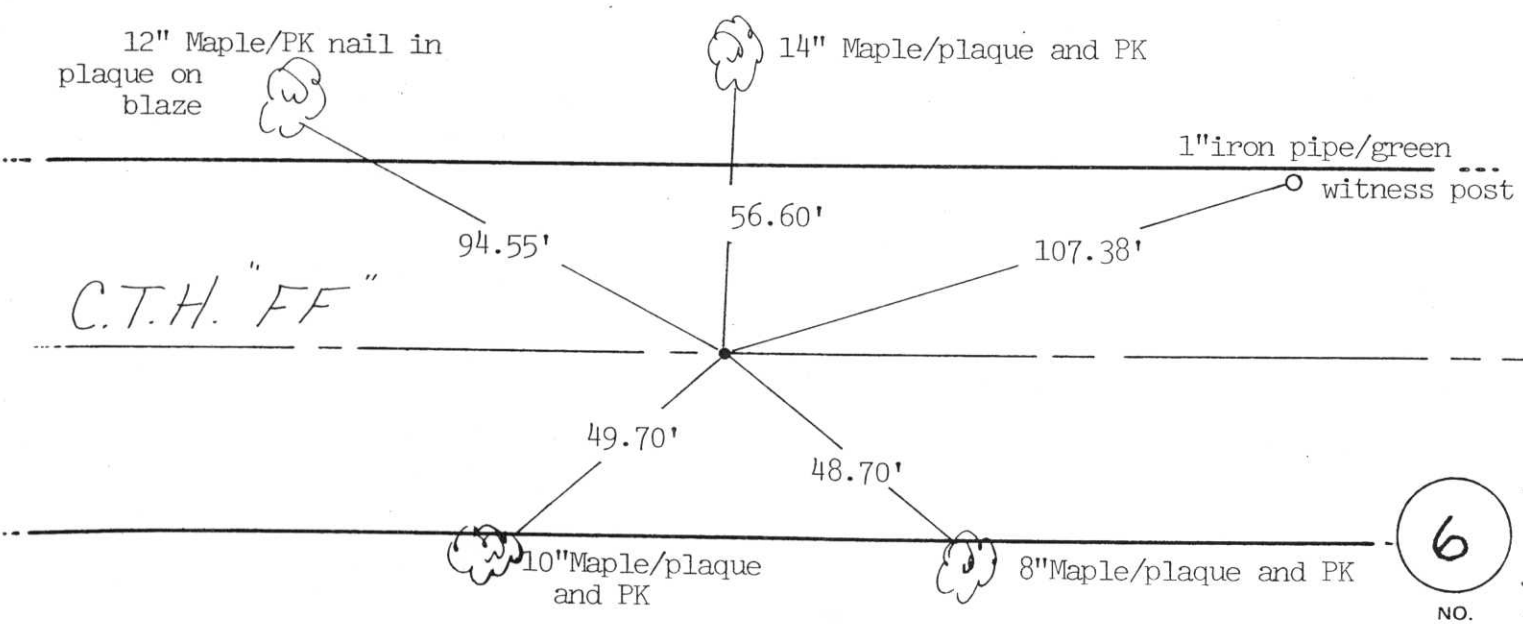

6
NO.

1-12

MARATHON COUNTY

SURVEY MONUMENT LOCATION RECORD

SECTION 4
TOWNSHIP 30 - N
RANGE 5 - E



LANDMARK BENCHMARK

FOUND
SET
RE-SET
RE-TIED

CORNER IDENTITY: N 1/4 CORNER

STATE PLANE COORDINATE: N: _____

ZONE: _____ E: _____

ELEVATION - (FEET): _____ DATUM: _____

THETA ANGLE: _____ WEATHER: _____

DATE OF SURVEY: 11-16-78 TEMPERATURE: _____ °F

SURVEY PARTY: RKF, R.W.

HAMBURG
CITY, VILLAGE, TOWN

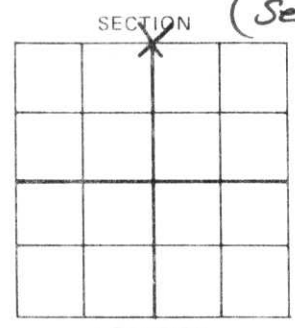

31
(Sec ~~33~~-31-5)



LOCATION
(Indicated By X)

BASIS FOR MONUMENT LOCATION:

(DESCRIBE METHOD OF SURVEY AND CORNER AUTHENTICATION)

Dug 10'x20', found nothing.
Set corner proportionate
measurement E & W

SEAL



FIELD BOOK NO. "FF" PAGE NO. _____

COMPANY MARATHON CO. HWY.

CERTIFIED CORRECT:

Robert K. Fergat

DATE: Nov 12, 1978 Registered Land Surveyor

TIE SKETCH:

SHOW MINIMUM OF THREE (3) HORIZONTAL TIE DISTANCES TO FIXED WITNESS MONUMENTS. DESCRIBE ALL MONUMENTS FOUND OR SET. CORRECT ALL DISTANCES SHOWN TO STANDARD TEMPERATURE OF 68° F.

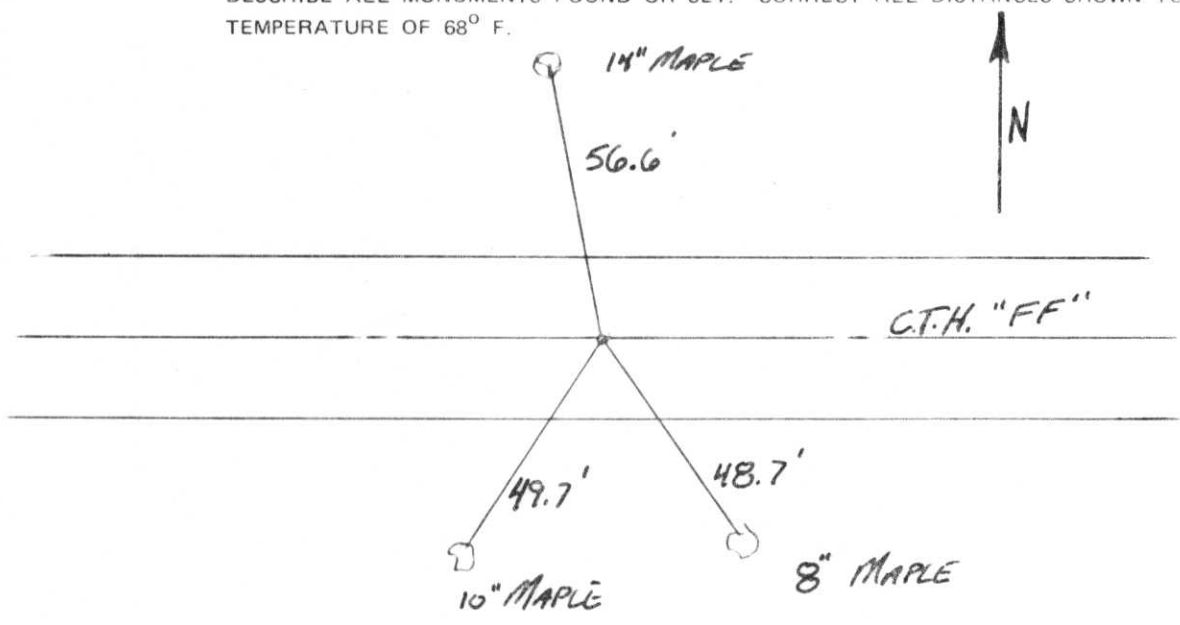

1-112

