

MARATHON COUNTY

SURVEY MONUMENT LOCATION RECORD

SECTION 5  
TOWNSHIP 30 - N  
RANGE 5 - E



LANDMARK  BENCHMARK

FOUND   
SET

CORNER IDENTITY: N 1/4 CORNER

RE-SET

RE-TIED

HAMBURG  
CITY, VILLAGE, TOWN

STATE PLANE COORDINATE: N: \_\_\_\_\_

ZONE: \_\_\_\_\_ E: \_\_\_\_\_

ELEVATION - (FEET): \_\_\_\_\_ DATUM: \_\_\_\_\_

THETA ANGLE: \_\_\_\_\_ WEATHER: \_\_\_\_\_

DATE OF SURVEY: 11-16-78 TEMPERATURE: \_\_\_\_\_ °F

SURVEY PARTY: RKF. R.W

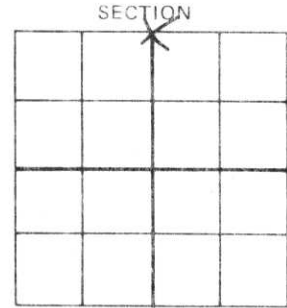

BASIS FOR MONUMENT LOCATION:

(DESCRIBE METHOD OF SURVEY AND CORNER AUTHENTICATION)

FOUND SQUARE CUT GRANITE STONE 2 1/2' BELOW SURFACE.

SEAL

36-31-4  
Sec ~~32-28-5~~ (5 1/4 cr)



FIELD BOOK NO. "FF" PAGE NO. \_\_\_\_\_

CERTIFIED, CORRECT:  
Robert K. Ferguson

COMPANY MARATHON CO HWY

Registered Land Surveyor  
DATE: Nov. 12, 1979

TIE SKETCH:

SHOW MINIMUM OF THREE (3) HORIZONTAL TIE DISTANCES TO FIXED WITNESS MONUMENTS. DESCRIBE ALL MONUMENTS FOUND OR SET. CORRECT ALL DISTANCES SHOWN TO STANDARD TEMPERATURE OF 68° F.

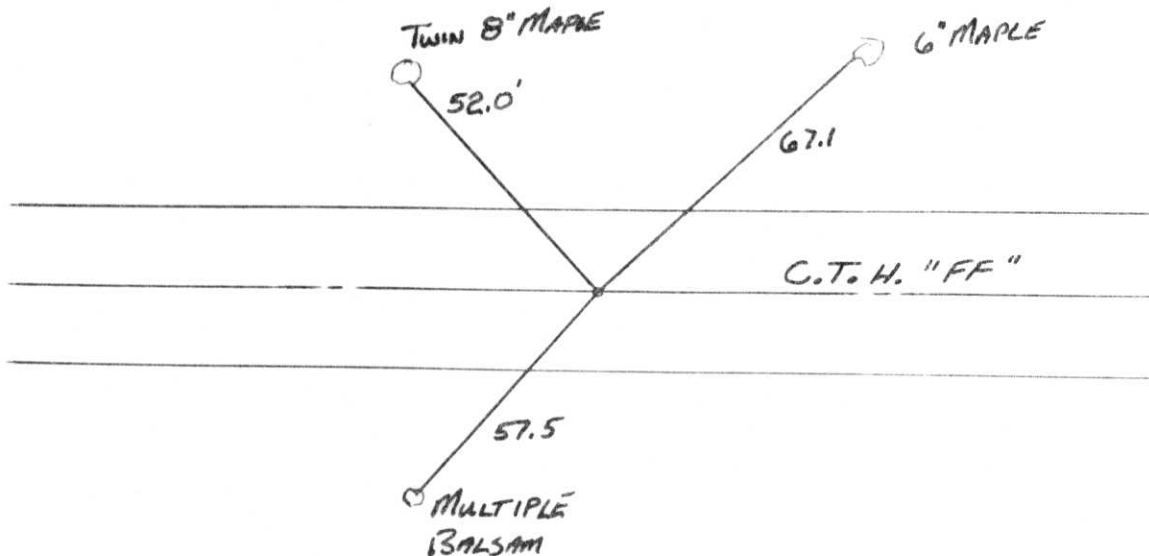

4-21,22

MARATHON COUNTY

SURVEY MONUMENT LOCATION RECORD

SECTION 5  
TOWNSHIP 30  
RANGE 5

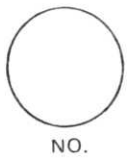

LANDMARK  BENCHMARK \_\_\_\_\_

FOUND

SET

RE-SET

RE-TIED

CORNER IDENTITY: N 1/4 CORNER

Hamburg  
CITY, VILLAGE, TOWN

36-31-4  
(Sec ~~32-31-5~~)

STATE PLANE COORDINATE: N: \_\_\_\_\_

ZONE: \_\_\_\_\_ E: \_\_\_\_\_

ELEVATION - (FEET): \_\_\_\_\_ DATUM: \_\_\_\_\_

THETA ANGLE: \_\_\_\_\_ WEATHER: \_\_\_\_\_

DATE OF SURVEY: \_\_\_\_\_ TEMPERATURE: \_\_\_\_\_ °F

SURVEY PARTY: \_\_\_\_\_

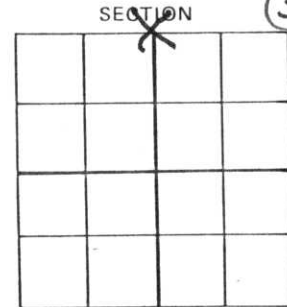

**BASIS FOR MONUMENT LOCATION:**

(DESCRIBE METHOD OF SURVEY AND CORNER AUTHENTICATION)

Found cut granite stone -  
top broken. 11-16-78

SEAL

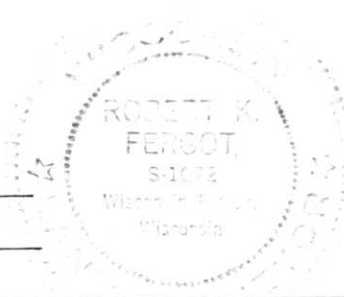

CERTIFIED CORRECT:

Robert K. Fergot

FIELD BOOK NO. FF PAGE NO. \_\_\_\_\_

COMPANY MARATHON CO. HWY

DATE: Sept. 20 1979 Registered Land Surveyor

**TIE SKETCH:**

SHOW MINIMUM OF THREE (3) HORIZONTAL TIE DISTANCES TO FIXED WITNESS MONUMENTS. DESCRIBE ALL MONUMENTS FOUND OR SET. CORRECT ALL DISTANCES SHOWN TO STANDARD TEMPERATURE OF 68° F.

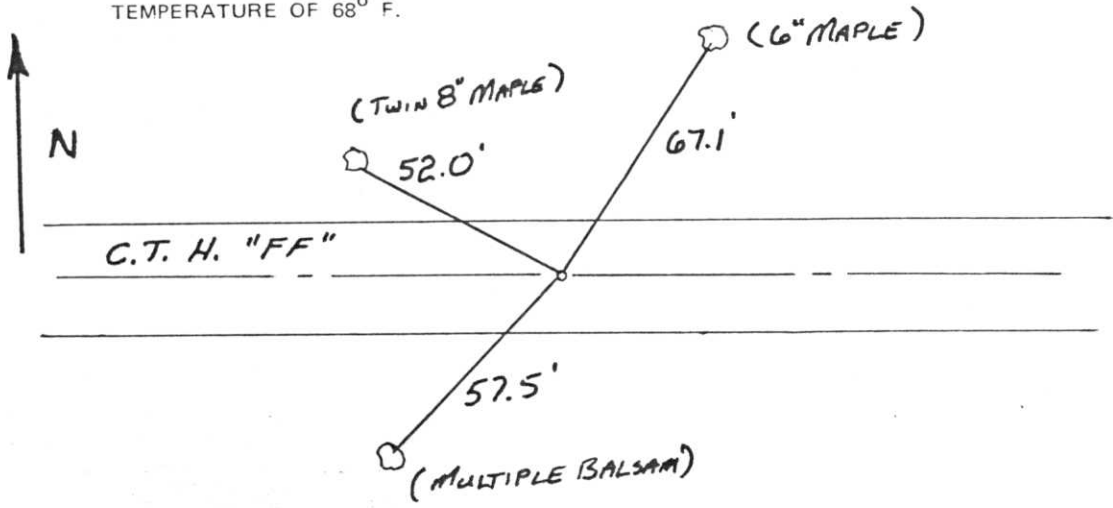

1-21-22  
NO.

# MARATHON COUNTY U.S. PUBLIC LAND SURVEY MONUMENT LOCATION RECORD

SECTION 5  
 TOWNSHIP 30  
 RANGE 5

4  
 NO.

LANDMARK       BENCHMARK  
 FOUND  SET   
 RE-SET  RE-TIED   
 CORNER IDENTITY: N<sub>4</sub> Cor; PK nail  
 STATE PLANE COORDINATE: N: \_\_\_\_\_  
 ZONE: \_\_\_\_\_ E: \_\_\_\_\_  
 ELEVATION - (FEET): \_\_\_\_\_ DATUM: \_\_\_\_\_  
 THETA ANGLE: \_\_\_\_\_ WEATHER: \_\_\_\_\_  
 DATE OF SURVEY: 1-30-86 TEMPERATURE: \_\_\_\_\_ °F  
 SURVEY PARTY: Nowaczyk, Krueger

Hamburg  
 TOWN

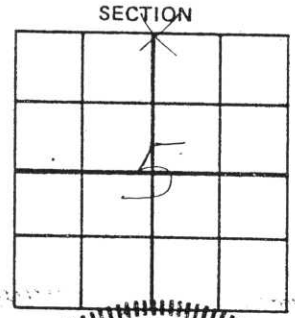

## BASIS FOR MONUMENT LOCATION:

(DESCRIBE METHOD OF SURVEY AND CORNER AUTHENTICATION)

Set PK nail from remaining ties.      SEAL  
 Had been tied by Fergot in 1979.  
 Added new ties to update.



CERTIFIED CORRECT:  
Gary R. Krueger  
 Gary R. Krueger RLS NO. 1619  
 Registered Land Surveyor  
 DATE: 1-31-86

FIELD BOOK NO. \_\_\_\_\_ PAGE NO. \_\_\_\_\_  
 COMPANY Surveying Specialists

**TIE SKETCH:** SHOW MINIMUM OF FOUR (4) HORIZONTAL TIE DISTANCES TO FIXED WITNESS MONUMENTS. DESCRIBE ALL MONUMENTS FOUND OR SET. CORRECT ALL DISTANCES SHOWN TO STANDARD TEMPERATURE OF 68° F.

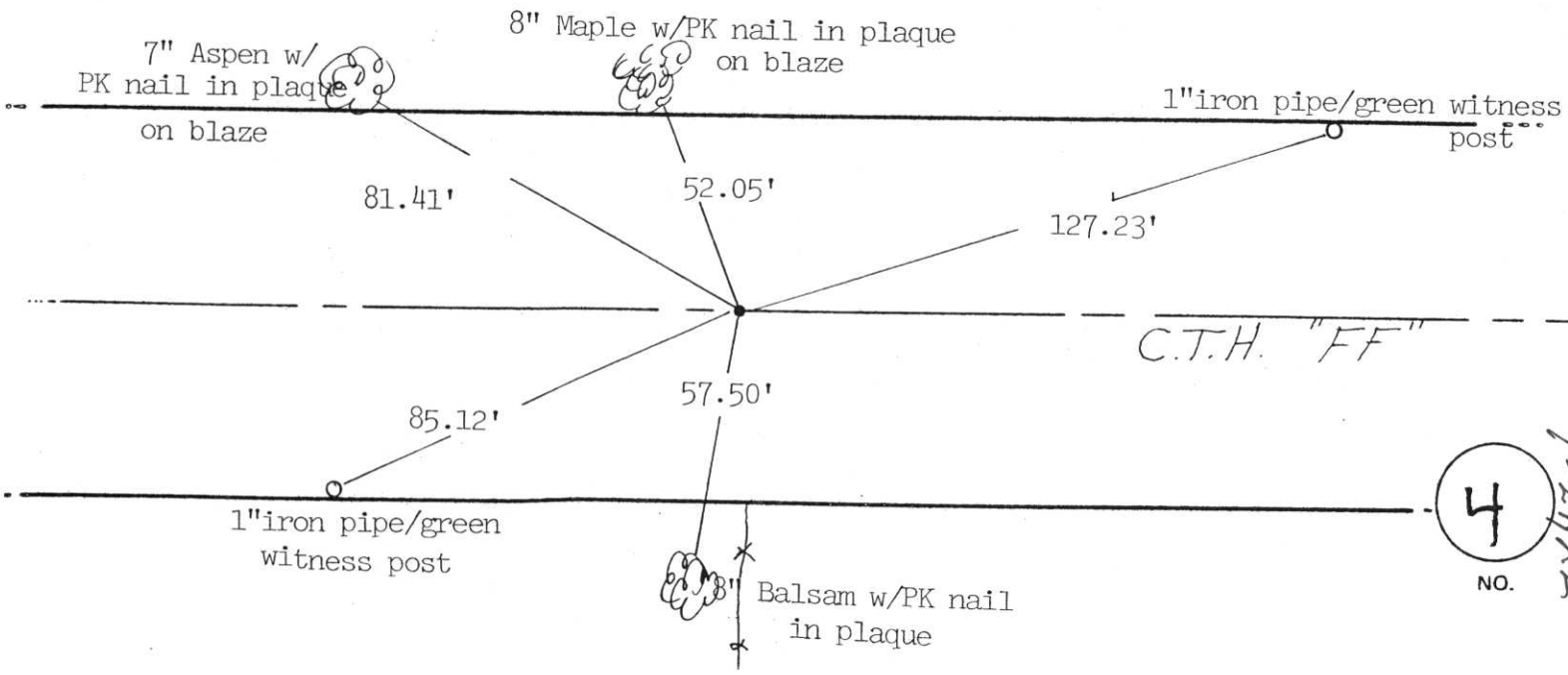

4  
 NO.