

LINCOLN COUNTY SECTION SUMMARY

LEGEND

SECTION SUMMARY

36 SECTION

34N TOWNSHIP

8E RANGE

HARRISON TOWN

☑ FOUND GRANITE MONUMENT

⊕ FOUND LINCOLN COUNTY MONUMENT

⊙ SET LINCOLN COUNTY MONUMENT

⊙ FOUND LANGLADE COUNTY MONUMENT



N 200805.89
E 460360.21

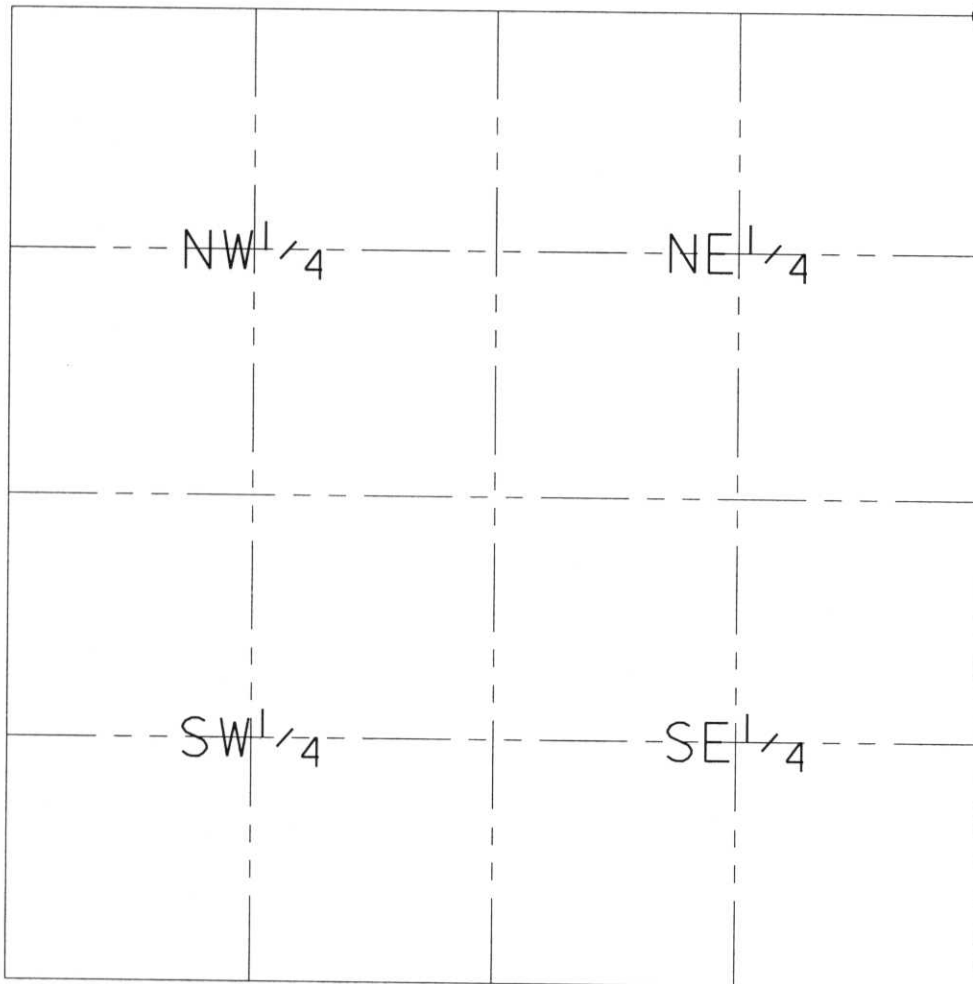

RECEIVED AT LINCOLN COUNTY
COURTHOUSE THIS 11TH DAY
OF December 20 02
Jerry Dallen
LAND INFORMATION OFFICE



NOTES:
COORDINATES AND BEARINGS ARE REFERENCED TO THE LINCOLN COUNTY COORDINATE SYSTEM AS DEVELOPED BY THE WISCONSIN DEPARTMENT OF TRANSPORTATION AND WERE DETERMINED BY GPS OBSERVATIONS ON CONTROL POINTS AS SUPPLIED BY THE COUNTY SURVEYOR.

CERTIFIED CORRECT:

Dennis B. Roberts
Signature

12-06-02
Date

Index No. 44-2125

LINCOLN COUNTY SECTION SUMMARY

LEGEND

SECTION SUMMARY 36 SECTION 34N TOWNSHIP 8E RANGE
HARRISON
TOWN

- FOUND GRANITE MONUMENT
- FOUND LINCOLN COUNTY MONUMENT
- SET LINCOLN COUNTY MONUMENT
- FOUND LANGLADE COUNTY MONUMENT

RECEIVED AT LINCOLN COUNTY
 COURTHOUSE THIS 29th DAY
 OF December 20 03
Tony A. Roanman
 LAND INFORMATION OFFICE



N 200805.90
 E 460360.21

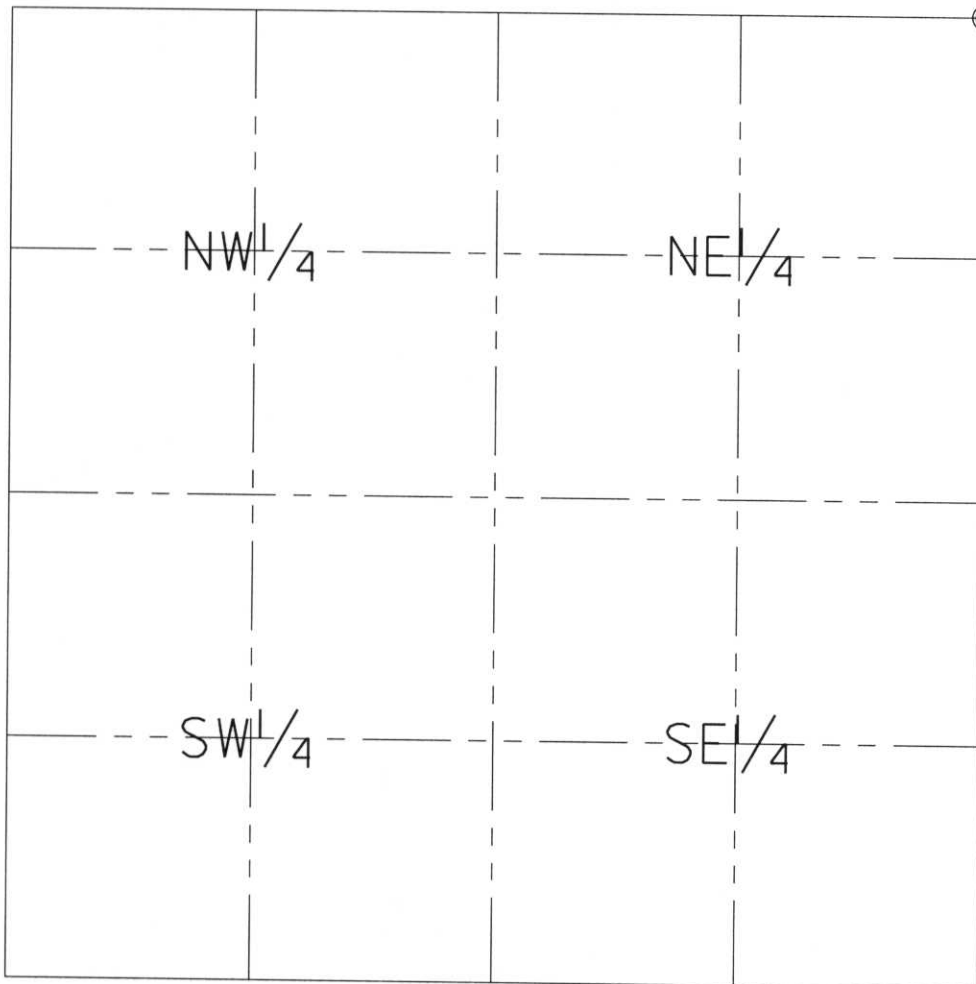

NOTES:
 COORDINATES AND BEARINGS ARE REFERENCED TO THE LINCOLN COUNTY
 COORDINATE SYSTEM AS DEVELOPED BY THE WISCONSIN DEPARTMENT
 OF TRANSPORTATION AND WERE DETERMINED BY GPS OBSERVATIONS ON
 CONTROL POINTS AS SUPPLIED BY THE COUNTY SURVEYOR.



CERTIFIED CORRECT:

Jeffrey L. Demuth
 Signature

12/22/03
 Date

Index No. 07-21,25