



LINCOLN
**county
surveyor**

**SECTION
SUMMARY**

9 - 34
Section - Town - Range
HARRISON
Township

Sec 9-34-8

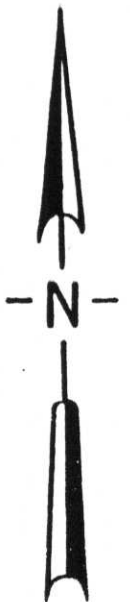
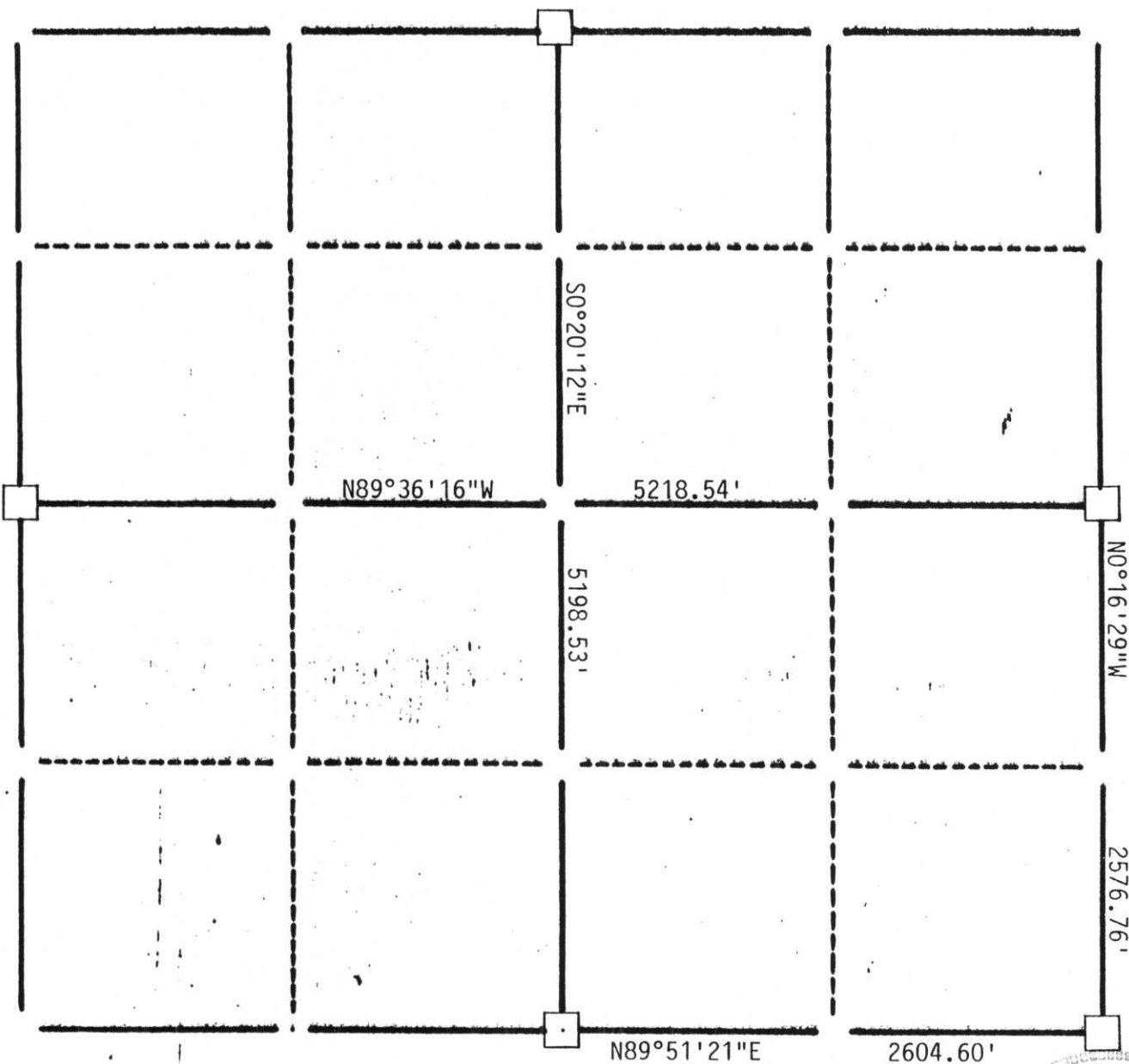

LEGEND

- ⊕ Berntsen Aluminum Monument
- Stone or Concrete Monument
- 2" Iron Pipe
- 1" Iron Pipe
- Iron Bar
- Other

RECEIVED AT LINCOLN COUNTY
COURTHOUSE THIS 24th DAY
OF Oct. 19 96

Pat Priebe
TAX DESCRIPTION OFFICE

CERTIFIED CORRECT:

David L. Osterbrink

David L. Osterbrink RLS No. S-2014

DATE: 10-27-96

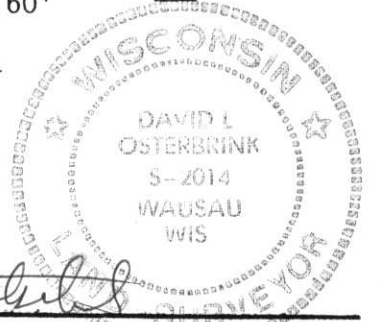

E.I.-913

LINCOLN COUNTY SECTION SUMMARY

LEGEND

SECTION SUMMARY

9 SECTION

34N TOWNSHIP

8E RANGE

HARRISON TOWN

FOUND GRANITE MONUMENT

FOUND LINCOLN COUNTY MONUMENT

SET LINCOLN COUNTY MONUMENT

FOUND LANGLADE COUNTY MONUMENT



N 221918.87
E 439205.52

N 221828.00
E 444433.87

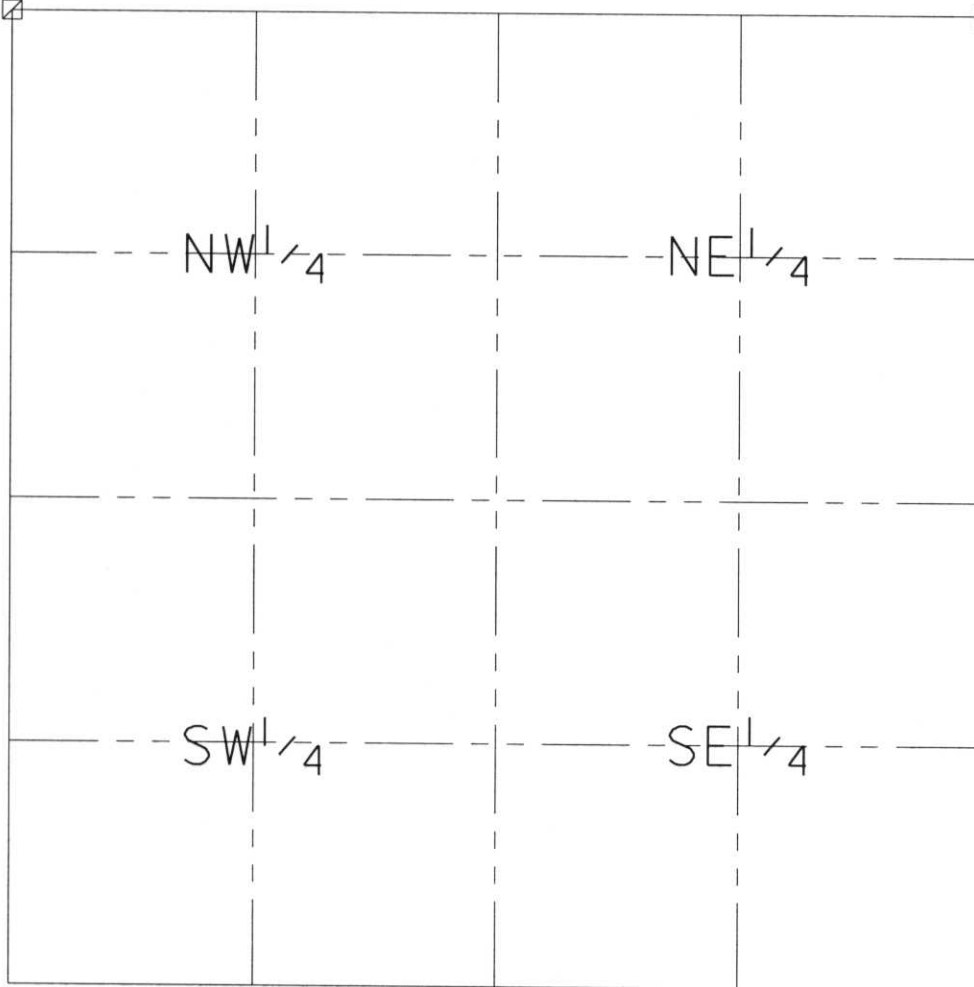

RECEIVED AT LINCOLN COUNTY
COURTHOUSE THIS 11TH DAY
OF December 20 02
Tony Walker
LAND INFORMATION OFFICE

NOTES:
COORDINATES AND BEARINGS ARE REFERENCED TO THE LINCOLN COUNTY COORDINATE SYSTEM AS DEVELOPED BY THE WISCONSIN DEPARTMENT OF TRANSPORTATION AND WERE DETERMINED BY GPS OBSERVATIONS ON CONTROL POINTS AS SUPPLIED BY THE COUNTY SURVEYOR.

CERTIFIED CORRECT:

Dennis B. Roberts
Signature

12-06-02
Date



Index No. E1-9.13