

NO.	DATE	DESCRIPTION	BY	SCALE	DATE	BY
1.	October 15, 1905	Original Plan Co.	C. & N. W. Ry. Co.	1:25,000	Oct. 1, 1898	Boer
	1905	Revised Plan Co.	"	"	Nov. 17, 1904	425
	"	"	"	"	Nov. 13, 1901	425
	"	"	"	"	Nov. 23, 1911	425

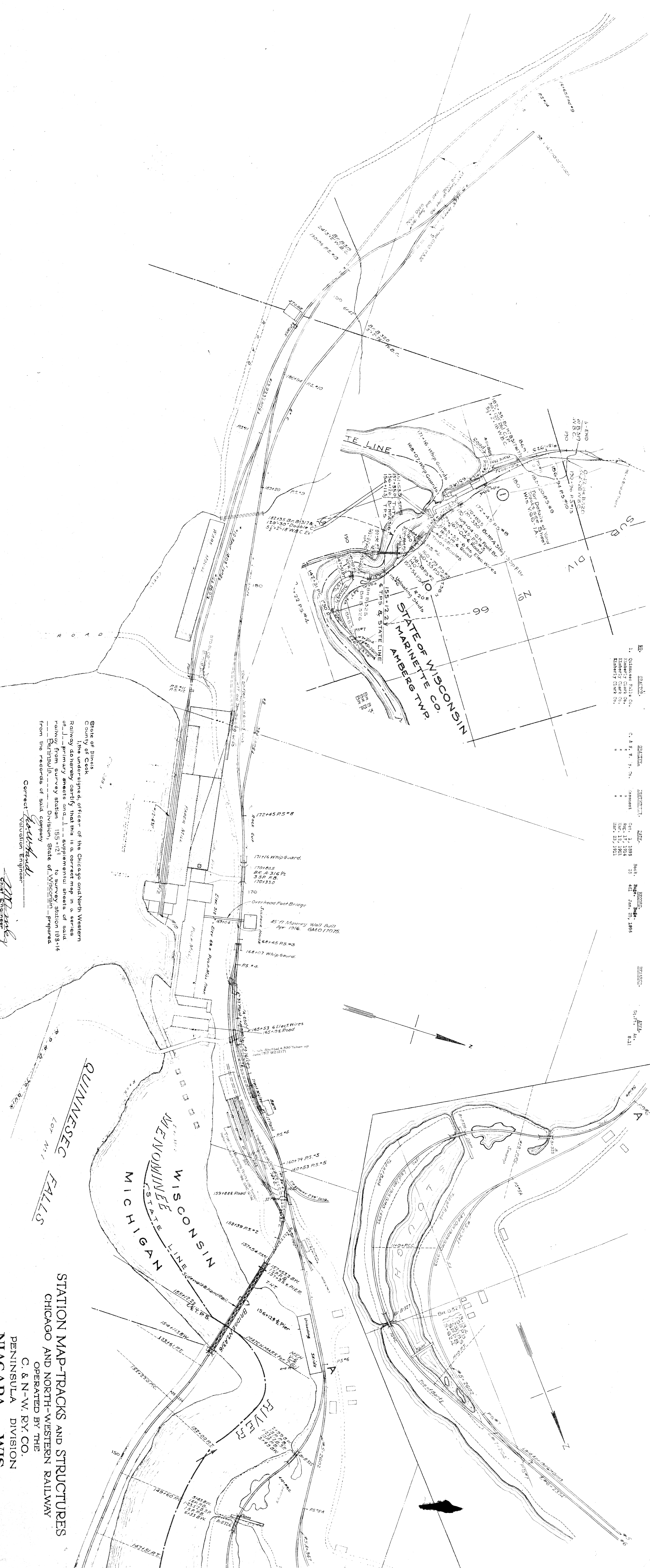

State of Illinois
County of Cook

I, the undersigned, officer of the Chicago and North Western Railway do hereby certify that this is a correct map in a series of primary sheets and supplemental sheets of said railway from survey station 155+12.7 to survey station 198+14.7 Peninsula, Division, State of Wisconsin prepared from the records of said company

Correct Valuation Engineer
Carlsford

Chief Engineer
W. H. M. M. M. M.

Subscribed and sworn to before me, this 25 day of June 1917
Notary Public in and for the County of Cook State of Illinois
W. H. M. M. M. M.

My commission expires April 29, 1922.

**STATION MAP-TRACKS AND STRUCTURES
CHICAGO AND NORTH-WESTERN RAILWAY
OPERATED BY THE
C. & N.-W. RY. CO.
PENINSULA DIVISION
NIAGARA, WIS.**

SCALE 1-IN. = 100 FT.
OFFICE OF CHIEF ENGINEER
CHICAGO, ILL.
JUNE 30 1917.

