



Block	Page	Date	Ac. Feet
1	213	Feb. 22, 1892	8,000
2	214	Jan. 29, 1894	27,640
3	438	Jan. 29, 1894	19,900
4	438	Apr. 26, 1894	3,660
5	275	Apr. 29, 1894	26,020
6	473	Sept. 8, 1894	43,180
7	463	Sept. 8, 1894	21,590
8	466	Sept. 11, 1894	27,078
9	471	Sept. 11, 1894	12,880
10	482	Sept. 11, 1894	15,400
11	384	Dec. 1, 1894	4,980
12	384	Dec. 1, 1894	28,400
13	472	Sept. 6, 1895	6,120
14	440	Sept. 6, 1895	17,750
15	440	Sept. 6, 1895	12,750
16	472	Sept. 6, 1895	36,980

State of Wisconsin
County of Brown
I, the undersigned officer of the Green Bay and Western Railroad Co., do hereby certify that the above and foregoing plat and map are true and correct copies of the original plat and map on file in my office, and that the same were prepared from the records of said company.

[Signature]
Chief Engineer

RIGHT OF WAY AND TRACK MAP
GREEN BAY AND WESTERN R. R.
OPERATED BY
GREEN BAY AND WESTERN R. R.
STATION 0.00
STATION 211.20
SCALE: 1 INCH = 400 FEET
OFFICE OF CHIEF ENGINEER
GREEN BAY, WIS.
JUNE 20, 1916

STATION 0.00
STATION 211.20
SCALE: 1 INCH = 400 FEET
OFFICE OF CHIEF ENGINEER
GREEN BAY, WIS.
JUNE 20, 1916

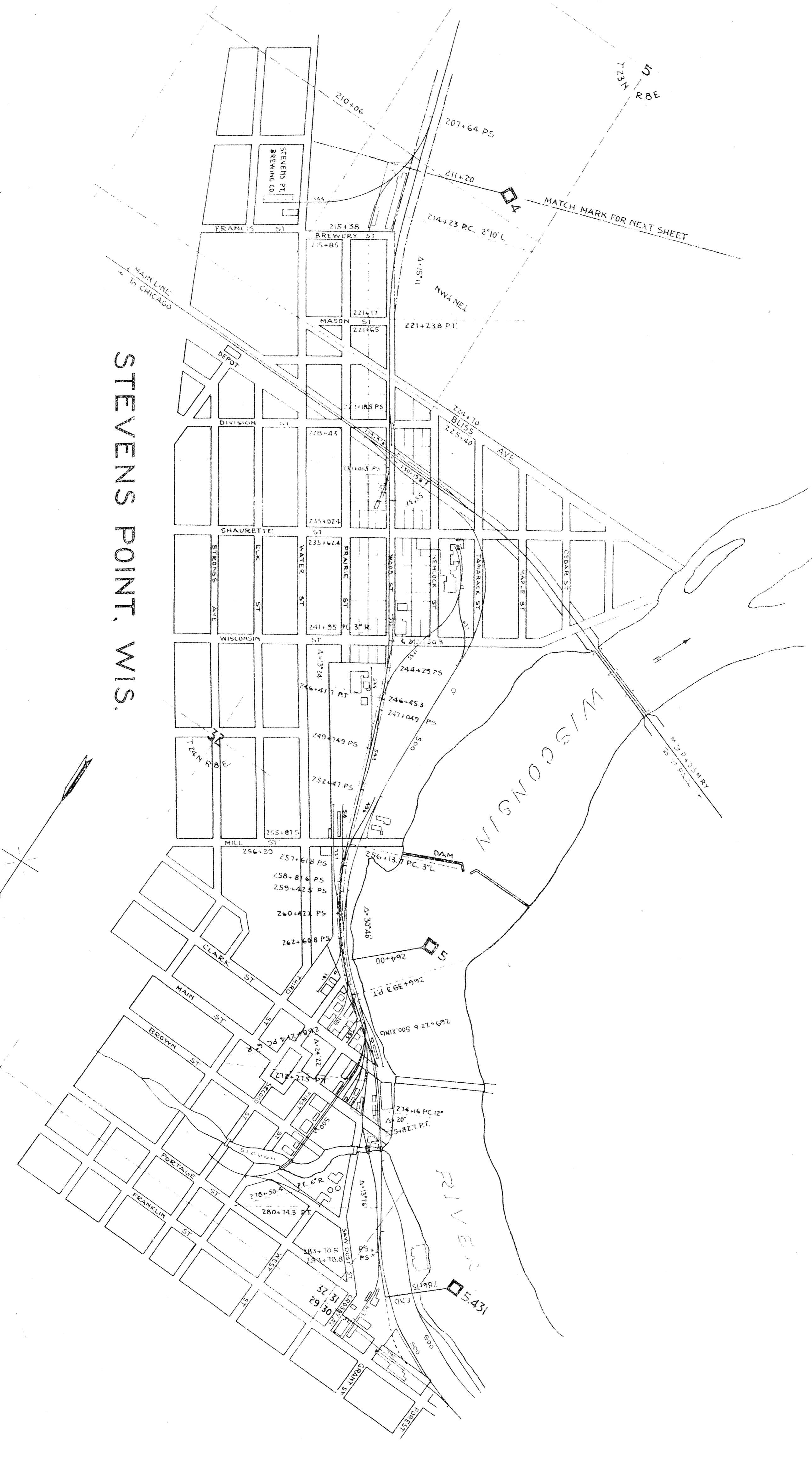

STEVENS POINT, WIS.

LINE	OWNER	SECTION	DATE	ACRES	sq. Feet
1	Madison State		Sept. 19, 1881	1.290	17,941
2	Western Mail Printing Co.		Sept. 19, 1881		
3	Stevens Point Printing Co.		Sept. 19, 1881		
4	James H. Brown		Sept. 19, 1881		
5	Elizabeth A. Lee		Sept. 19, 1881		
6	Wm. Chapman		Sept. 19, 1881		
7	Wm. Chapman		Sept. 19, 1881		
8	Wm. Chapman		Sept. 19, 1881		
9	Wm. Chapman		Sept. 19, 1881		
10	Wm. Chapman		Sept. 19, 1881		
11	Wm. Chapman		Sept. 19, 1881		
12	Wm. Chapman		Sept. 19, 1881		
13	Wm. Chapman		Sept. 19, 1881		
14	Wm. Chapman		Sept. 19, 1881		
15	Wm. Chapman		Sept. 19, 1881		
16	Wm. Chapman		Sept. 19, 1881		
17	Wm. Chapman		Sept. 19, 1881		
18	Wm. Chapman		Sept. 19, 1881		
19	Wm. Chapman		Sept. 19, 1881		
20	Wm. Chapman		Sept. 19, 1881		
21	Wm. Chapman		Sept. 19, 1881		
22	Wm. Chapman		Sept. 19, 1881		
23	Wm. Chapman		Sept. 19, 1881		
24	Wm. Chapman		Sept. 19, 1881		
25	Wm. Chapman		Sept. 19, 1881		
26	Wm. Chapman		Sept. 19, 1881		
27	Wm. Chapman		Sept. 19, 1881		
28	Wm. Chapman		Sept. 19, 1881		
29	Wm. Chapman		Sept. 19, 1881		
30	Wm. Chapman		Sept. 19, 1881		

RIGHT OF WAY AND TRACK MAP

GREEN BAY AND WESTERN R.R.
OPERATED BY
GREEN BAY AND WESTERN R.R.

STEVENS POINT BRANCH
TO STATION 21+20

OFFICE OF CHIEF ENGINEER
GREEN BAY WIS.

