

Sheet Number	Total Sheets
4	

Index of Sheets

- Sheet No. 4.0 TITLE
- Sheet No. 4.1 SCHEDULE OF LANDS & INTERESTS REQUIRED
- Sheet No. 4.2 LAYOUT OF PROPERTY OWNERS
- Sheet No. 4.10 PLAN & PARCEL SHEET

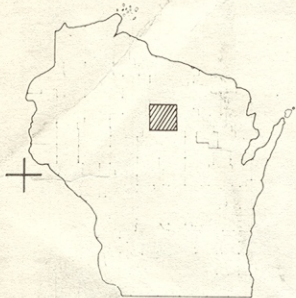

STATE OF WISCONSIN
DEPARTMENT OF TRANSPORTATION
DIVISION OF HIGHWAYS

PLAT OF RIGHT OF WAY REQUIRED FOR

SOUTH LINCOLN COUNTY LINE - MERRILL
 U.S.H. 51
 LINCOLN COUNTY

PROJECT IDENTIFICATION NUMBER
 1173 - 2 - 21

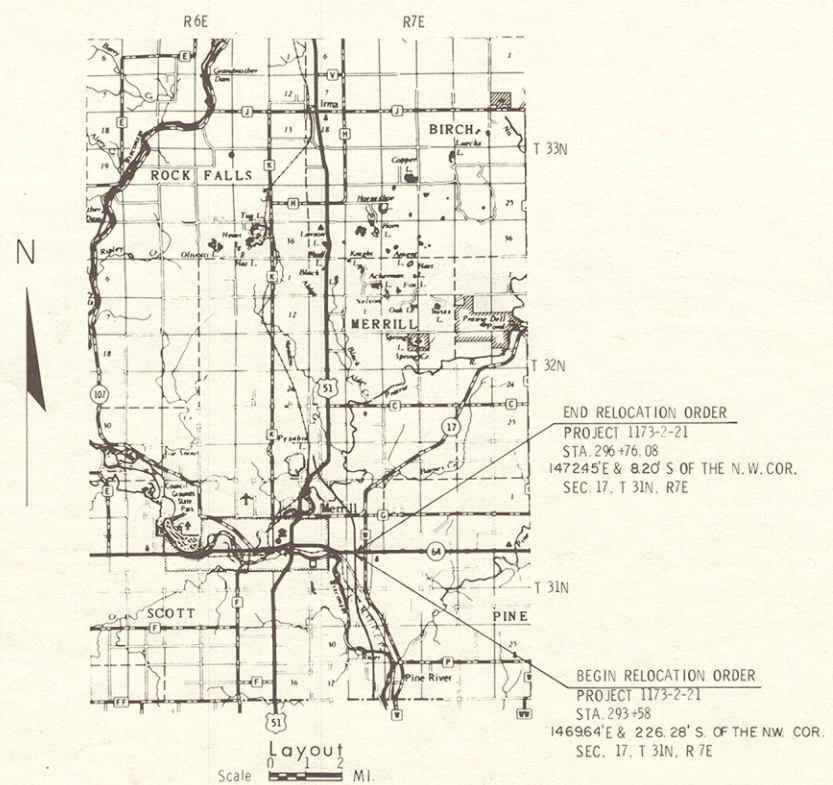

END RELOCATION ORDER
 PROJECT 1173-2-21
 STA. 296+76.08
 147245'E & 820' S OF THE N.W. COR.
 SEC. 17, T 31N, R 7E

BEGIN RELOCATION ORDER
 PROJECT 1173-2-21
 STA. 293+58
 146964'E & 226.28' S OF THE NW. COR.
 SEC. 17, T 31N, R 7E

Total Net Length of Centerline = 0.060 Mi.

REVISION DATE	STATE OF WISCONSIN DEPARTMENT OF TRANSPORTATION DIVISION OF HIGHWAYS
	Date: <u>3-8-71</u> <i>R.D. Schindelhof</i> District Engineer
	Recommended for Approval:
	Date: _____ Approved: _____ Chief Design Engineer
	Date: _____ Approved: _____ Director, Bureau of Right of Way
	STATE OF WISCONSIN DEPARTMENT OF TRANSPORTATION FEDERAL HIGHWAY ADMINISTRATION BUREAU OF PUBLIC ROADS WISCONSIN DIVISION
	Approved:
	Date: _____ Division Engineer

PROJECT TO: 1173-2-21
 FEDERAL PROJECT DESIGNATION: 4, 10
 PLAT OF RIGHT OF WAY REQUIRED
 SOUTH COUNTY LINE - MERRILL
 U.S.H. 51
 COUNTY: LINCOLN
 SCALE: 1" = 100'
 DATE: MARCH 18, 1971

REVISION: _____
 DATE: _____
 TOTAL SHEETS: _____
 SHEET NUMBER: 4, 10

