

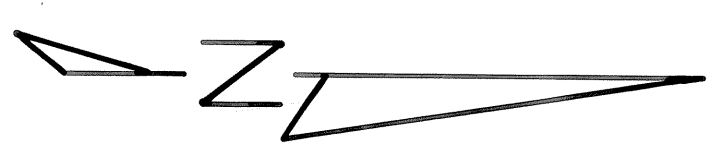



PROJECT I.D. NO. 33/6/18 & 19E  
 TITLE: 1986 RECONSTRUCTION OF CTH "E"  
 SCALE: 1"=50' HORIZONTAL ; 1"=2' VERTICAL  
 SHEET NO. 8 OF



GARY PETERSON, et al

MAX PETERSON

PLAN  
 SURVEYED BY: \_\_\_\_\_ DATE: \_\_\_\_\_  
 PLOTTED BY: \_\_\_\_\_  
 CHECKED BY: \_\_\_\_\_  
 RT. OF WAY CHECKED BY: \_\_\_\_\_

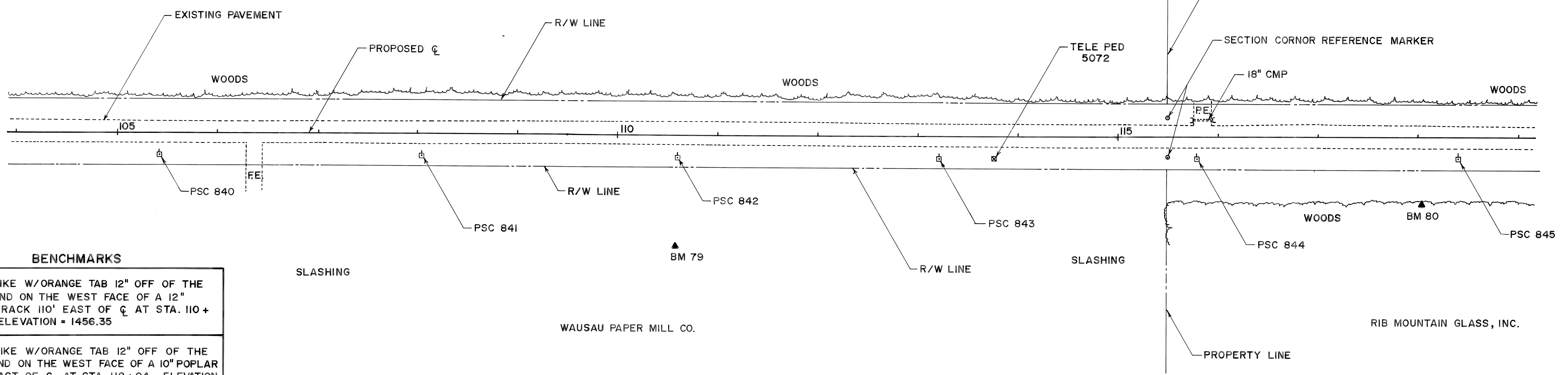

**BENCHMARKS**

79	4" SPIKE W/ORANGE TAB 12" OFF OF THE GROUND ON THE WEST FACE OF A 12" TAMERACK 110' EAST OF CL AT STA. 110 + 57. ELEVATION = 1456.35
80	4" SPIKE W/ORANGE TAB 12" OFF OF THE GROUND ON THE WEST FACE OF A 10" POPLAR 65' EAST OF CL AT STA. 118 + 04. ELEVATION = 1453.29 .

PROFILE  
 SURVEYED BY: \_\_\_\_\_ DATE: \_\_\_\_\_  
 PLOTTED BY: \_\_\_\_\_  
 CHECKED BY: \_\_\_\_\_  
 STRUCTURE NOTATIONS CHKD BY: \_\_\_\_\_

