

B. P. R. DIVISION	PROJECT	SHEET NUMBER	TOTAL SHEETS
	T 0565(I)	1	2

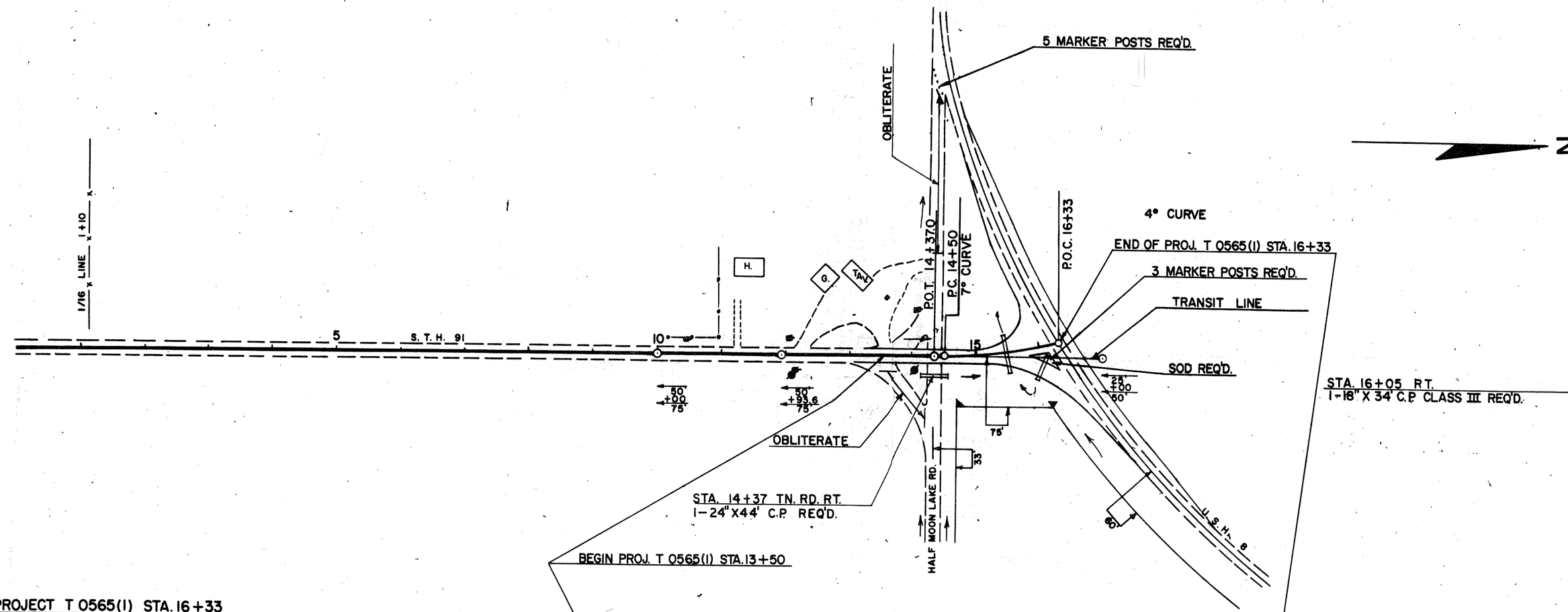

BENCH MARKS			
NO.	STATION	DESCRIPTION	ELEV.
918	14+10	SPIKE IN 10" JACK PINE	110.00

**U.S.H. 8 & 91 INTERSECTION
S.T.H. 91
LINCOLN COUNTY
PROJECT T 0565(I)**

STATE HIGHWAY
COMMISSION OF WISCONSIN
MADISON, WIS.

SURVEYOR: H. OHM NOTE BOOK: IBM 217-228
DIVISION COMPUTER: E. SEIDLER M. G. CHECKER
DISTRICT CHECKER: G. FUNK CORRECT

CORRECT:
DATE: DISTRICT ENGINEER

RECOMMENDED FOR APPROVAL:
DATE: 4/15/65 E. J. Byrd
ENGINEER OF DESIGN

APPROVED:
DATE: 4/15/65 E. C. Rustum
STATE HIGHWAY ENGINEER

DEPARTMENT OF COMMERCE
BUREAU OF PUBLIC ROADS

APPROVED: DATE

DIVISION ENGINEER

PLOTTED: E.S.
NOTE BOOK NO. 217
CHECKED: S.E.
RT. OF WAY CHECKED

PLOTTED: E.S.
NOTE BOOK GRADES CHECKED: E.S.
NO. 228
ENGINEER: ROYALTS CIVIL

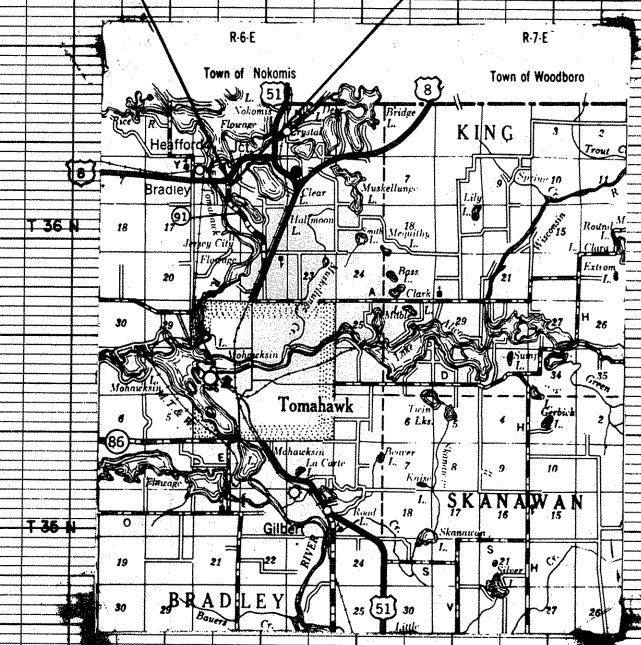

LAYOUT
SCALE 1" = 2 MILES
NET LENGTH OF CENTERLINE = 0.05 MI.

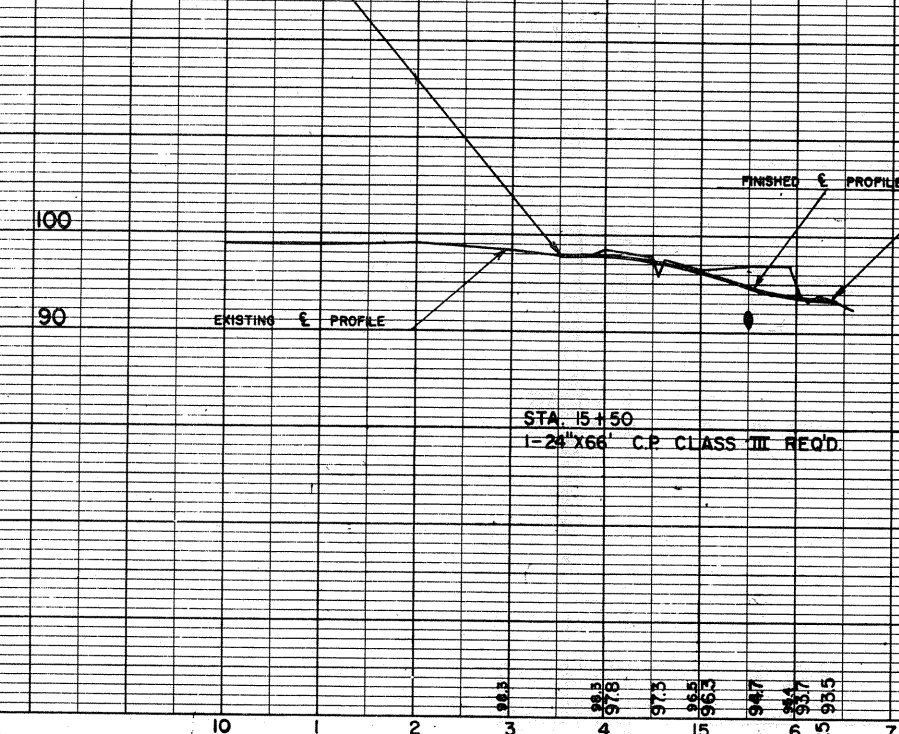

PROJECT	SHEET NUMBER	TOTAL SHEETS
T 0565(1)	2	2

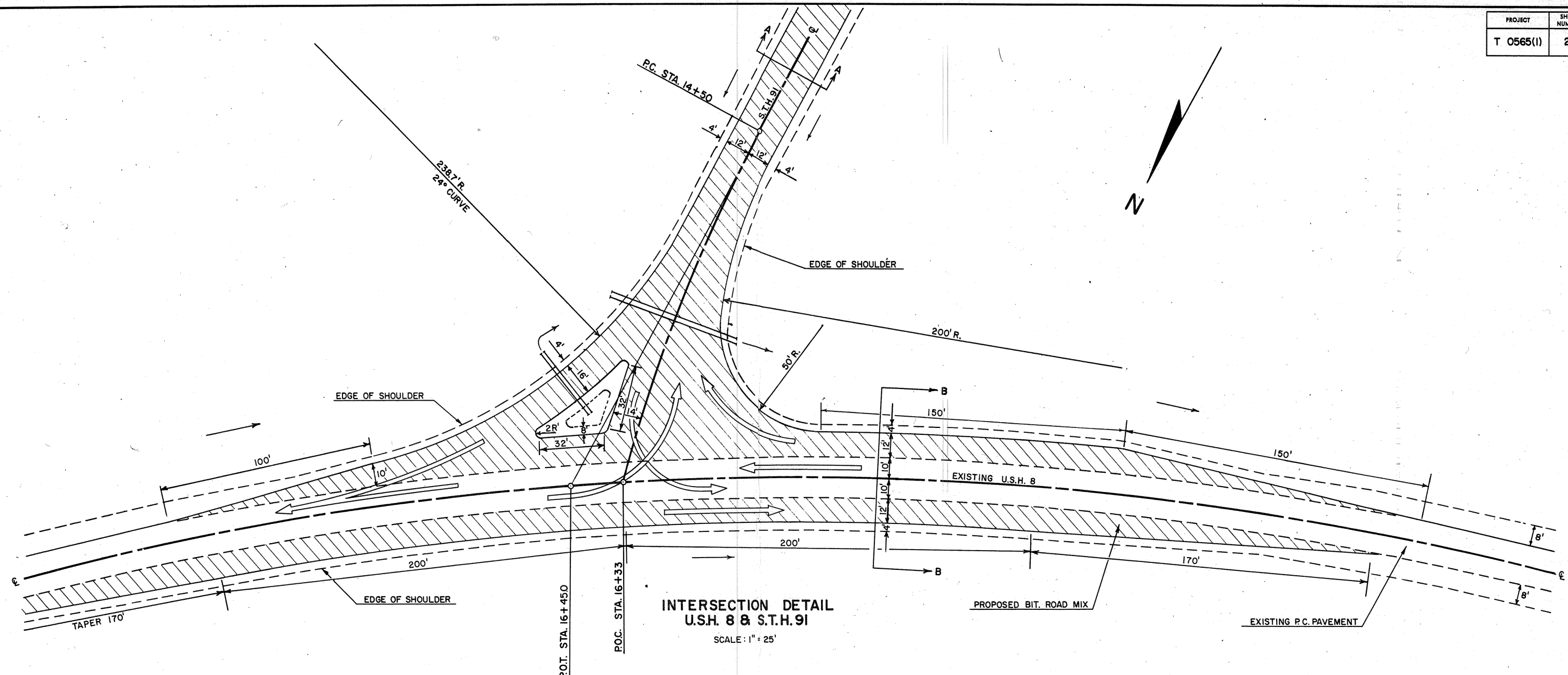

**INTERSECTION DETAIL
U.S.H. 8 & S.T.H. 91**
SCALE: 1" = 25'

