

Index of Sheets

Sheet No.	1	Title
Sheet No.	2-2.4	Typical Sections and Details
Sheet No.	3-3.2	Estimate of Quantities
Sheet No.	3A	Miscellaneous Quantities
Sheet No.	-	Right of Way Plat
Sheet No.	5-5.4	Plan and Profile
Sheet No.	6-6.13	Standard Detail Drawings
Sheet No.	-	Standard Sign Plates
Sheet No.	-	Structure Plans
Sheet No.	9-9.22	Computer Earthwork Data
Sheet No.	9.23-9.77	Cross Sections

TOTAL SHEETS = 109

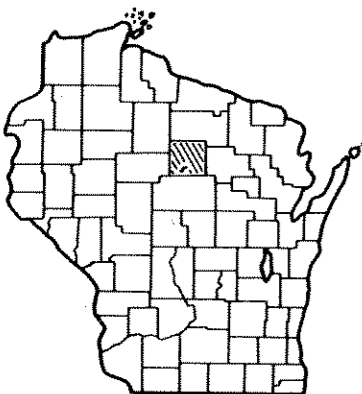

STATE OF WISCONSIN DEPARTMENT OF TRANSPORTATION

PLAN OF PROPOSED IMPROVEMENT

S.T.H. 107—MERRILL

S.T.H. 64

LINCOLN COUNTY

STATE PROJECT NUMBER
9000-01-70

STATE PROJECT	FEDERAL PROJECT	
	PROJECT	CONTRACT
9000-01-70	FO36 (29)	1

Design Designation

A.D.T. 1987	=	1340
A.D.T. 2007	=	1660
D.H.V. 2007	=	270
D.	=	60-40
T.	=	10%
V.	=	55 M.P.H.

**BEGIN PROJECT
STA. 10+00**
X 2,040,500 (+200)*
Y 479,700 (+200)

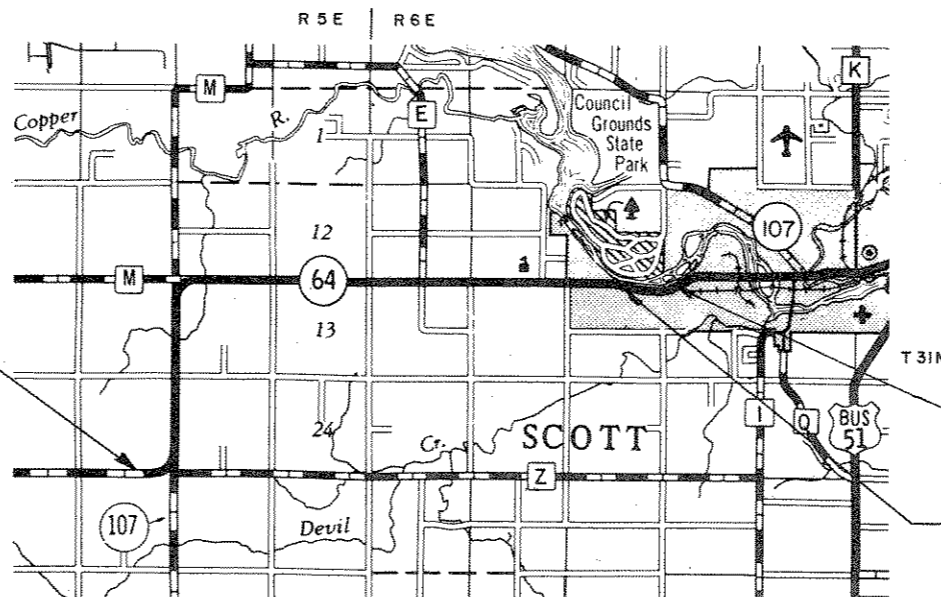

**STA. 399+00
END CONSTRUCTION**

**END PROJECT
STA. 388+25**

Conventional Signs

County Line	-----
Township or Range Line	-----
Section Line	-----
Corporate or City Limits	//////
Property line	-----
Lot Line	-----
Existing Right of Way Line	-----
New Right of Way Line	-----
Base or Survey Line	-----
Slope Intercept	-----
Existing Roadway or Private Entrance	-----

Caution Symbol (Combustible fluids under pressure)	
Railroads	-----
Fence	-----
Culverts in Place	-----
Culverts Required	-----
Power Pole	-----
Telephone or Telegraph Pole	-----
Right of Way Markers	-----
Marsh	-----
Wooded Area	-----
Grade Elevation	-----

Layout
Scale 0 1/2 1 MILE

Total Net Length of Centerline = 7.164 Mi.
6.174 Mi RURAL
.990 Mi URBAN

*COORDINATES SHOWN ON THIS PLAN ARE SCALED FROM ALEXANDER LAKE, WISCONSIN, QUADRANGLE FOR IDENTIFICATION ONLY.

STATE OF WISCONSIN DEPARTMENT OF TRANSPORTATION	
Surveyor <u>J.R.W.</u>	District Checker <u>D.L.J.</u>
Designer <u>P.A.H.</u>	C. O. Checker <u>Rlo</u>
District Supervisor <u>P.M.J.</u>	C. O. Coordinator <u>J.W.</u>
Approved: _____	
Date <u>1/9/87</u>	<u>R.D. Schindler</u> District Transportation Director
Approved: _____	
Date <u>2-2-87</u>	<u>D.D. Strand</u> Chief Design Engineer
Approved: _____	
Date <u>2/11/87</u>	<u>E.J. Byrkit</u> Director of Development
U. S. DEPARTMENT OF TRANSPORTATION FEDERAL HIGHWAY ADMINISTRATION REGION 5 WISCONSIN DIVISION	
Approved: _____	
Date _____	Division Administrator

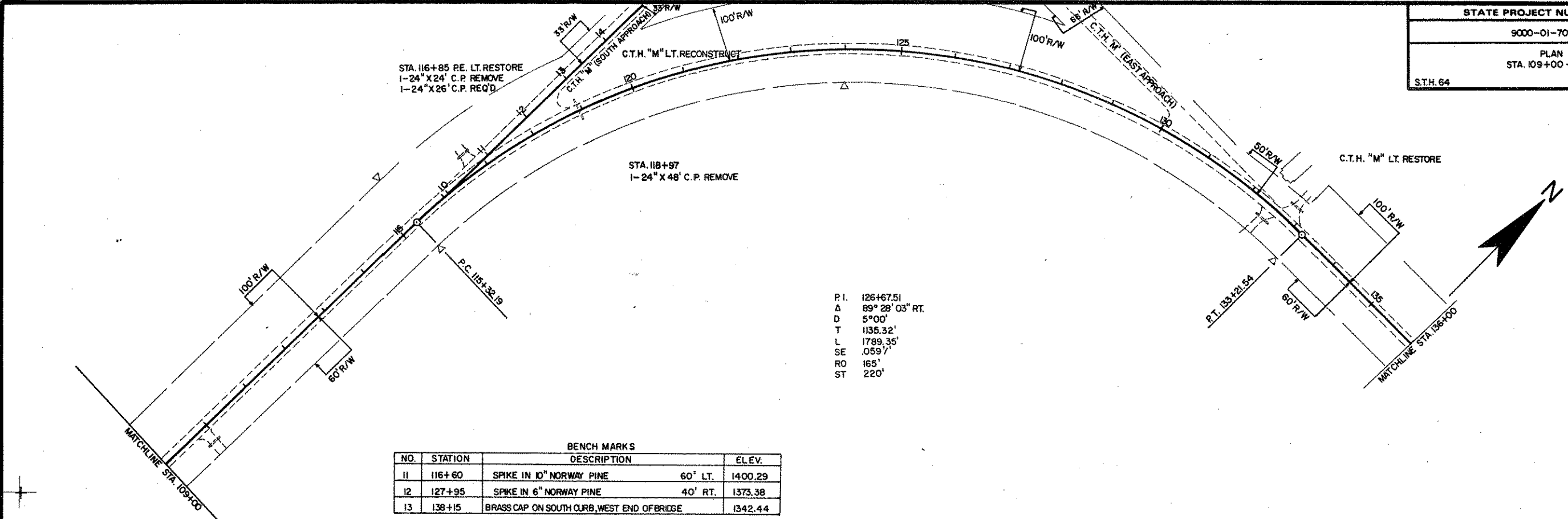

P.I. 126+67.51
 A 89° 28' 03" RT.
 D 5° 00'
 T 1135.32'
 L 1789.35'
 SE .059 1/2
 RO 165'
 ST 220'

BENCH MARKS				
NO.	STATION	DESCRIPTION		ELEV.
11	116+60	SPIKE IN 10" NORWAY PINE	60' LT.	1400.29
12	127+95	SPIKE IN 6" NORWAY PINE	40' RT.	1373.38
13	138+15	BRASS CAP ON SOUTH CURB, WEST END OF BRIDGE		1342.44

