

INDEX OF SHEETS

SHEET NO.	TITLE
1	TYPICAL CROSS SECTIONS
2	ESTIMATE OF QUANTITIES
3	MISCELLANEOUS QUANTITIES
4	RIGHT OF WAY PLAT
5	PLAN AND PROFILE STA. TO STA.
6-8	STANDARD DETAILS
9-21	DRAINAGE STRUCTURES
22	CROSS SECTIONS

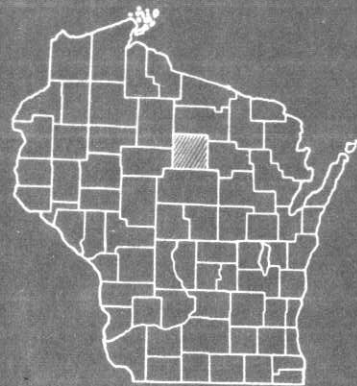

STATE OF WISCONSIN
STATE HIGHWAY COMMISSION OF WISCONSIN

PLAN AND PROFILE OF PROPOSED
WISCONSIN RIVER BRIDGE
CITY OF TOMAHAWK
U.S.H. "51"
LINCOLN COUNTY
PROJECT F05-4(43)

COUNTY AND HIGHWAY	ROUTE AND SECTION	CLASS AND AGREEMENT		S.P.R. REGION DIVISION	SHEET NUMBER	TOTAL SHEETS
		STATE	FEDERAL			
35.1	5.4		12.43	4 WIS.	1	21

PLAN 1 IN. = 100 FT.
PROFILE HOR. 1 IN. = 100 FT. VERT. 1 IN. = 10 FT.
CROSS SECTIONS HOR. 1 IN. = 5 FT. VERT. 1 IN. = 5 FT.

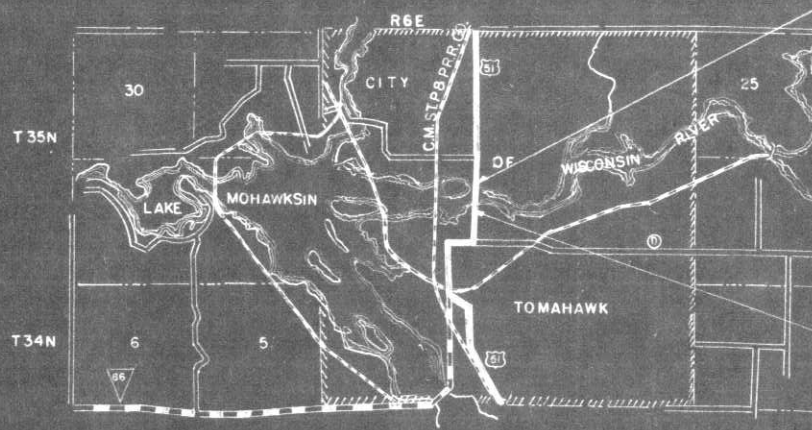

STA. 309+32.68 END OF PROJECT F 05-4(43)
1124' S. & 1320' E. OF N.W. SEC. COR.
SEC. 34, T.35N., R.6E.

STA. 304+77.52 BEGINNING OF PROJECT F 05-4(43)
1620' S. & 1320' E. OF N.W. SEC. COR.
SEC. 34, T.35N. R.6E.

CONVENTIONAL SIGNS

STATE LINE	-----	CULVERTS IN PLACE	-----
COUNTY LINE	-----	CULVERTS REQUIRED	-----
TOWNSHIP OR RANGE LINE	-----	DROP INLET	-----
SECTION LINE	-----	POWER POLE	-----
NEW RIGHT OF WAY LINE	-----	TELEPHONE OR TELEGRAPH POLE	-----
PRESENT RIGHT OF WAY LINE	-----	RIGHT OF WAY MARKERS	-----
WIRE FENCE { WOVEN	-----	REFERENCE STAKE FOR HUBS ONLY	-----
{ BARBED	-----	MARSH	-----
LOT LINE	-----	HEDGE	-----
CORPORATE OR CITY LIMITS	-----	TREES	-----
PROPERTY LINE	-----	GROUND ELEVATION	DATUM LINE 73.9
TRAVELED WAY OR P.E.	-----	GRADE ELEVATION	DATUM LINE 75.16
RAILROADS	-----		
BASE OR SURVEY LINE	-----		

LAYOUT

SCALE 1 MILE

TOTAL NET LENGTH OF CENTERLINE = 0.086 MI.

STATE HIGHWAY COMMISSION OF WISCONSIN MADISON, WIS.	
SURVEYOR C.W.	NOTE BOOK I.B.M.
DIVISION COMPUTER E.S.	M. D. CHECKER
DISTRICT CHECKER J.M.	CORRECT
CORRECT:	
DATE	<i>Max Smith</i> DISTRICT ENGINEER
RECOMMENDED FOR APPROVAL	
DATE 3/1/60	<i>J. S. Pitt</i> ENGINEER OF DESIGN
APPROVED:	
DATE 3/1/60	<i>E. C. Rustigan</i> STATE HIGHWAY ENGINEER
DEPARTMENT OF COMMERCE BUREAU OF PUBLIC ROADS	
APPROVED:	
DATE	
DIVISION ENGINEER	

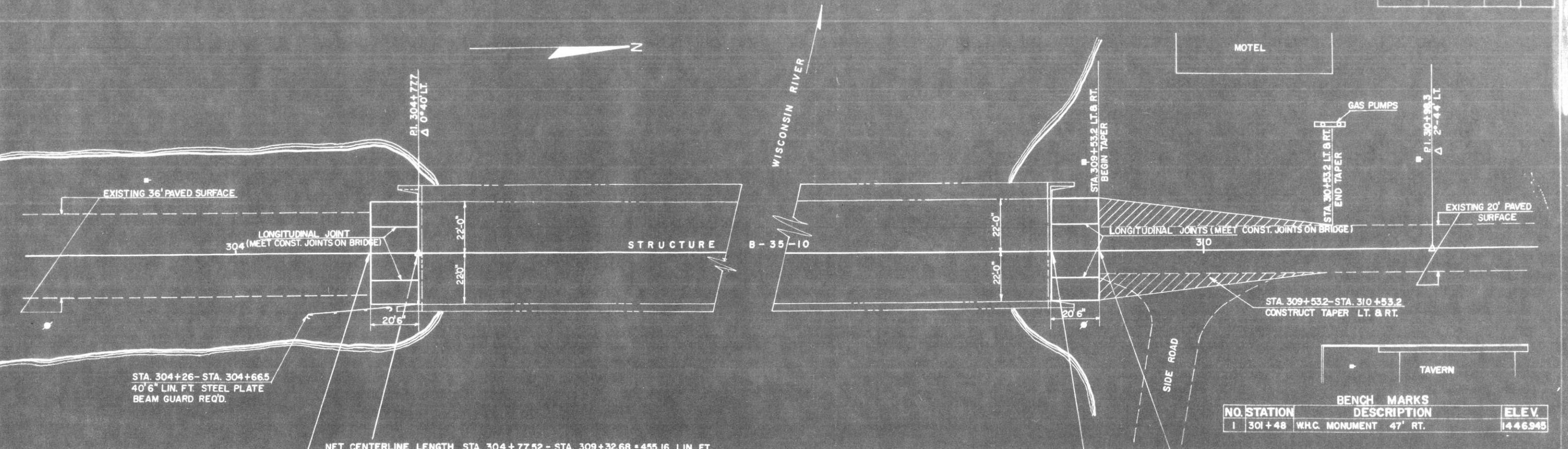

BENCH MARKS

NO.	STATION	DESCRIPTION	ELEV.
1	301+48	WHC. MONUMENT 47' RT.	1446.945

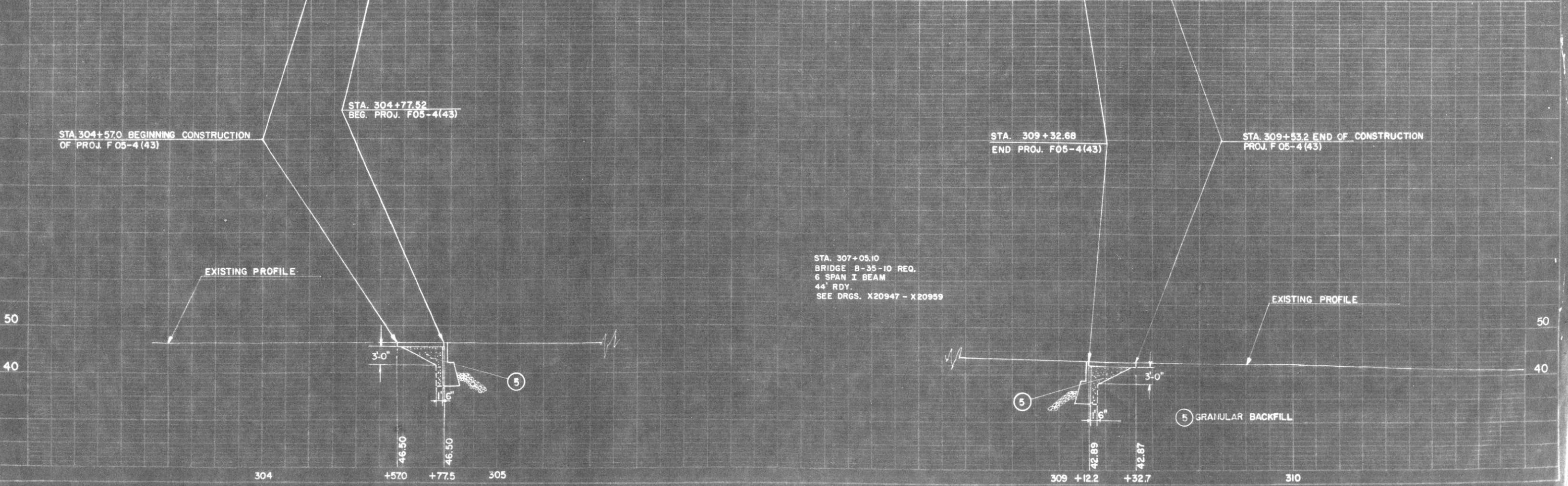

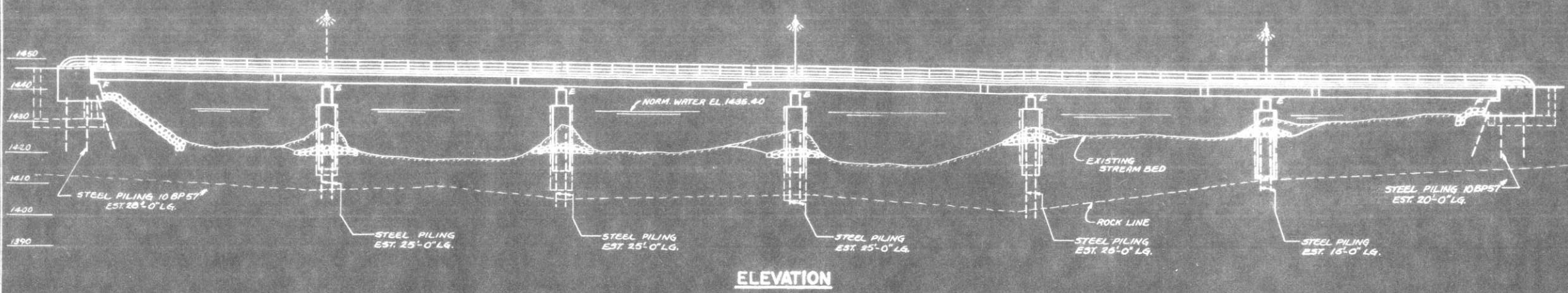

ELEVATION

GENERAL NOTES

DRAWINGS SHALL NOT BE SCALED.

LEVEL ALL EXPOSED EDGES OF CONCRETE 1" UNLESS OTHERWISE SPECIFIED.

BAR STEEL REINFORCEMENT SHALL BE IMBEDDED 2" CLEAR UNLESS OTHERWISE SHOWN OR NOTED.

THE USE OF STRUCTURAL GRADE BAR STEEL REINFORCEMENT IS PROHIBITED.

ALL CONCRETE MASONRY SHALL BE GRADE "MA" PILING AT ABUTMENTS AND PIERS SHALL BE 10BPST DRIVEN TO REFUSAL.

ALL FIELD CONNECTIONS TO BE EITHER 3/8" RIVETS OR HIGH TENSILE BOLTS.

THE SLOPE OF FILL IN FRONT OF ABUTS. SHALL BE RIPRAPPED AS SHOWN ON THIS SHEET, ON SHEETS X2095, X2095.7, AND AS DIRECTED BY THE ENGINEER.

THE PIERS SHALL BE RIPRAPPED TO THE EXTENT SHOWN ON THIS SHEET, ON X2095.6, AND AS DIRECTED BY THE ENGINEER.

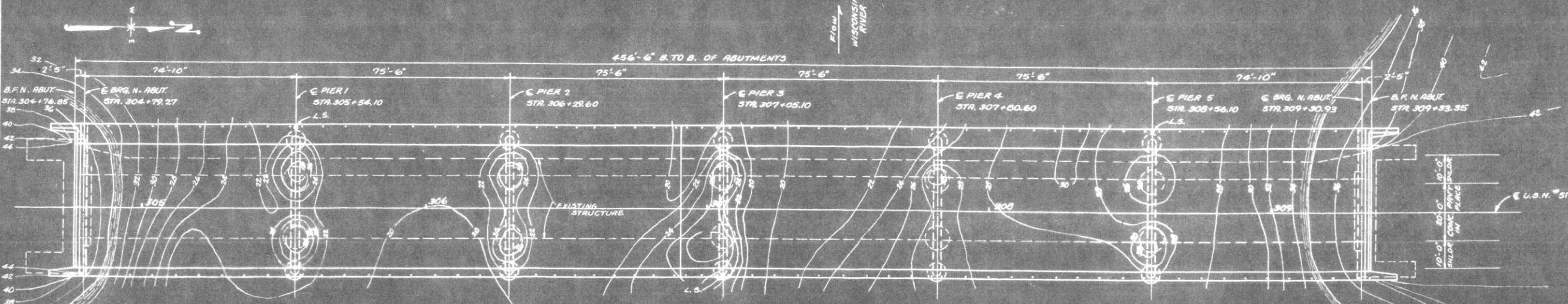

PLAN

6 SPAN CONTINUOUS I-BEAM (74'-10"-75'-6"-75'-6"-75'-6"-74'-10") WITH R.C. FLOOR - 3 LINE STEEL RAILING. EXISTING PIERS AND ABUTS. USED AS SUPPORTS FOR CENTER SECTION OF PIERS AND ABUTMENTS.

TOTAL ESTIMATED QUANTITIES

BID ITEMS	UNIT	SUPERSTRUCTURE	S. ABUT.	PIER 1	PIER 2	PIER 3	PIER 4	PIER 5	N. ABUT.	TOTAL
REMOVING OLD BRIDGE	L.S.									1
EXCAVATION FOR STRUCTURES	C.Y.		60	15	15	15	25	25	100	255
CONCRETE MASONRY	C.Y.	609.0	26.6	59.4	57.0	53.7	40.2	45.9	80.2	1,042.0
BAR STEEL REINFORCEMENT	L.B.	141,520	2,580	2,740	2,740	2,690	2,690	2,630	2,340	159,730
STRUCTURAL CARBON STEEL	L.B.	750,000		12,000	12,000	12,000	12,000	12,000		810,000
BEARING PADS	S.F.	74								74
STEEL TEST PILING (2 @ 40')	L.S.									1
STEEL PILING (DELIVERED)	L.F.		336	200	200	200	200	120	200	1,456
STEEL PILING (DRIVEN)	L.F.		336	200	200	200	200	120	200	1,456
FLOOR DRAINS	EA.	24								24
STEEL RAILING	L.F.	944.0								944.0
HEAVY RIPRAP	C.Y.		200	30	30	30	30	30	70	420
LUBRICATED BRONZE PLATES	L.B.	760								760
LIGHTING SYSTEM	L.S.									1
STEEL PLATE BEAM GUARD	L.F.	913.0								913.0
CONCRETE MASONRY, SEAL	C.Y.			20.9	20.9	20.9	20.9	20.9		104.5
NON-BID ITEMS										
FILLER	SIZE	2"								2"

LIST OF DRAWINGS

- 1. GENERAL PLAN X20947
- 2. SUPERSTRUCTURE X20948
- 3. SUPERSTRUCTURE X20949
- 4. SUPERSTRUCTURE X20950
- 5. SUPERSTRUCTURE X20951
- 6. RAILING & DRAINS X20952
- 7. EXPANSION JOINT X20953
- 8. MISC. DETAIL X20954
- 9. S. ABUT. X20955
- 10. PIERS X20956
- 11. N. ABUT. X20957
- 12. BILL OF BARS X20958
- 13. SUB-SURFACE EXPLORATION X20959

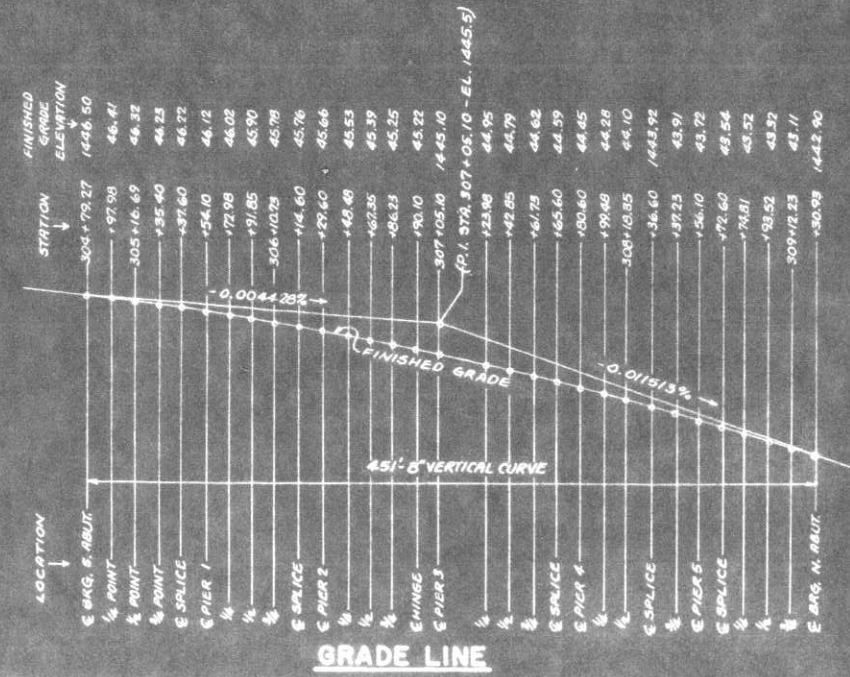

GRADE LINE

* DRIVE ONE AT LOCATION OF EACH ABUTMENT

REVISED	STATE HIGHWAY COMMISSION OF WISCONSIN		
1-22-60	GENERAL PLAN		
1-23-60	CO. LINCOLN	CITY TOWNSHIP	STA. 307+00.00
1-24-60	SECTION 34	TOWN 35 N	RANGE 6E
	DESIGN SPEC. A.R.S.N. 2.57	LOADING 120-36	DATE 1-22-59
	DATE 1-22-59	DESIGN W.G.	DRAWN W.P. CRD. J.F.F.
	SUBMITTED: <i>H. B. Schultz</i>	ENGINEER OF BRIDGES	
	APPROVED: <i>E. C. Ruston</i>	STATE HIGHWAY COMMISSION	
	STRUCTURE B-35-10	SHEET 1	OF 13