



Lincoln County Bermtsen breakaway monument found. (Monument and witnesses verified).

S89° 44' 52" E (S89° 45' 31" E)
1312.85' (1312.26')

NW 1/4 - NE 1/4
Govt Lot 1

NW - NE

GOVT

LOT

SE - SE

Lincoln County monument found N41° 16' W 26.29' from corner.

Lincoln County monument found N13° 14' E 34.76' from corner.

2207.36'
894.51' (895.08')

Section 16
Section 21

Doc. No. 554713

Parcel ID: 004-3506-211-9993

Jersey

City

Flowage

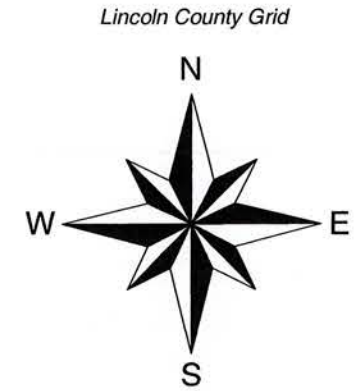

- ⊗ 1" dia. iron pipe found
- 2" dia. iron pipe found
- () Bearing or distance of record
- Wetland

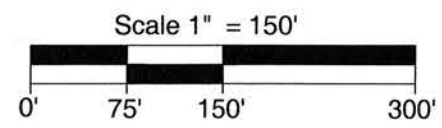

Notes:

- Fieldwork was completed on November 10, 2021.
- Wetlands shown hereon were derived from county topographic data and aerial imagery, they have not been delineated and are for reference only.

Surveyors Certificate

I hereby certify that I have surveyed the property line shown hereon; that this map represents an accurate survey of said property line to the best of my knowledge and belief; and that I have complied with the applicable requirements of the Wisconsin Administrative Code Section A-E 7.

RECEIVED BY LINCOLN COUNTY SURVEYOR THIS 15TH DAY OF June 20 22
Randy Dahl
COUNTY SURVEYOR

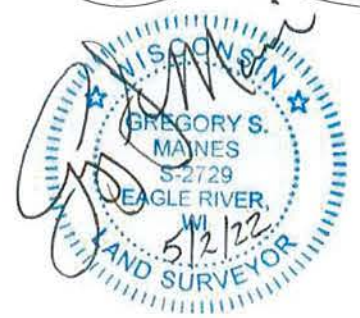

SCALE: 1" = 150'
JOB #: 2021317
DRAWN BY: CJH
DATE: 05/02/2022

CLIENT:
Robert Eisenman

Part of
Government Lot 1
Section 21, T 35 N, R 6 E
Town of Bradley
Lincoln County, Wisconsin

Arbor Vitae, WI 54568
Phone 715.356.9485
Eagle River, WI 54521
Phone 715.479.2570
mainesandassociates.com



SHEET 1 OF 1

S807B