

S2 T31N R8E Rhinelander  
paper Co. Feb. 1965

SHCW

BEARINGS

- nail set
- iron pipe set
- ▲ right-of-way post

Part of the  
**SW 1/4 of the SW 1/4**  
**SECTION 24, T31N, R8E**  
 Lincoln County, Wis.



Scale 1"=100'

March, 1973

Northwoods Surveyors, Inc.

*Robert H. Winat*  
 Land Surveyor

RECEIVED AT LINCOLN COUNTY  
 COURTHOUSE THIS 16<sup>th</sup> DAY  
 OF April 1973  
*Osborn Odegard*  
 TAX DESCRIPTION OFFICE

1/3-24-3/8

nail in fence post  
 N18°E, 59.78'

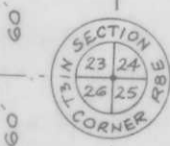

POPLAR AVENUE

nail in tel. pole #425-150  
 S27°E, 62.10'

STATE

N 89-37E

270.5'

TRUNK

N 89-49E

193.1'

HIGHWAY

"64"



55

A