

PLAT OF SURVEY

LOT 7 OF CERTIFIED SURVEY MAP NUMBER 936, RECORDED IN VOLUME 4, ON PAGE 302, AS DOCUMENT NUMBER 349065, FILED IN THE LINCOLN COUNTY REGISTER OF DEEDS OFFICE; BEING PART OF GOVERNMENT LOT 5 OF SECTION 29, TOWNSHIP 31 NORTH, RANGE 7 EAST, TOWN OF PINE RIVER, LINCOLN COUNTY, WISCONSIN.

SURVEYOR'S CERTIFICATE

I JESSE L. ROBERGE, WISCONSIN PROFESSIONAL LAND SURVEYOR S-2958, DO HEREBY CERTIFY TO THE BEST OF MY KNOWLEDGE AND BELIEF: THAT I HAVE SURVEYED AND MAPPED LOT 7 OF CERTIFIED SURVEY MAP NUMBER 936, RECORDED IN VOLUME 4, ON PAGE 302, AS DOCUMENT NUMBER 349065, FILED IN THE LINCOLN COUNTY REGISTER OF DEEDS OFFICE; BEING PART OF GOVERNMENT LOT 5 OF SECTION 29, TOWNSHIP 31 NORTH, RANGE 7 EAST, TOWN OF PINE RIVER, LINCOLN COUNTY, WISCONSIN.

THAT SAID PARCEL CONTAINS 66,037 SQUARE FEET, 1.516 ACRES, MORE OR LESS.

THAT I HAVE MADE THIS SURVEY AND MAP THEREOF AT THE DIRECTION OF NEELY OWEN, AGENT OF SAID PARCEL.

THAT SAID PARCEL IS SUBJECT TO EASEMENTS, RESTRICTIONS, AND RIGHTS-OF-WAY OF RECORD.

THAT I HAVE FULLY COMPLIED WITH THE PROVISIONS OF WISCONSIN ADMINISTRATIVE CODE A-E7.

THAT SAID PARCEL IS A CORRECT AND ACCURATE REPRESENTATION OF THE EXTERIOR BOUNDARY OF SAID PARCEL.

DATED THIS 22nd DAY OF SEPTEMBER, 2021

REI
JESSE L. ROBERGE
WI P.L.S. S-2958

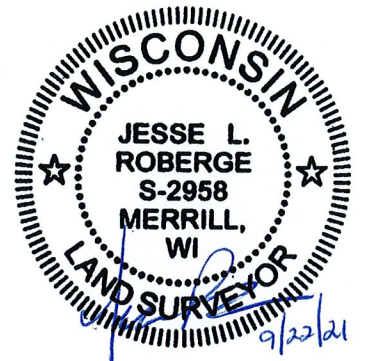

LEGEND

- - 1 IN. O.D. IRON PIPE FOUND
- - 1-1/2 IN. O.D. IRON PIPE FOUND
- - 2 IN. O.D. IRON PIPE FOUND
- × - WOODEN LATH SET ON PROPERTY LINE
- (126') - RECORDED BEARING/LENGTH
- 126.00' - MEASURED BEARING/LENGTH

NOTES:

- BEARINGS ARE BASED ON THE LINCOLN COUNTY COORDINATE SYSTEM, NAD 83(2011) DATUM AND REFERENCED TO THE NORTH LINE OF THE NORTHWEST 1/4 OF SECTION 29, TOWNSHIP 31 NORTH, RANGE 7 EAST, MEASURED TO BEAR SOUTH 89°35'20" WEST.
- FIELD WORK WAS COMPLETED ON 9-21-2021.

CURVE TABLE					
CURVE	ARC LENGTH	RADIUS LENGTH	CENTRAL ANGLE	CHORD BEARING	CHORD LENGTH
CI	89.41'	53.07'	96°32'14"	N42°02'48"W	79.20'
(CI)	(89.86')	(53.066')	(97°01'18")	(N42°05'38"W)	(79.50')

LOT 7
CSM #936
VOL. 4, PG. 302
"VACANT"
66,037 SQ.FT.
1.516 ACRES

LOT 10
CSM #943
VOL. 4, PG. 316
OWNED BY OTHERS

LOT 11
CSM #943
VOL. 4, PG. 316
OWNED BY OTHERS

LOT 8
CSM #936
VOL. 4, PG. 302
OWNED BY OTHERS

RECEIVED BY LINCOLN COUNTY
SURVEYOR THIS 27TH DAY
OF September 20 21
Jerry Dalk
COUNTY SURVEYOR

DRAWING FILE: Q:\10000-10099\10061 - NEELY OWEN - W4460 DAVEY LANE - MERRILL\DRAWING\SURVEY\10061.PLAT OF SURVEY.DWG LAYOUT: PLAT OF SURVEY-11X17 PLOTTED: SEP 22, 2021 - 10:13AM PLOTTED BY: JESSER

REI Engineering, INC.
4080 N. 20TH AVENUE
WAUSAU, WISCONSIN 54401
PHONE: 715.675.9784 FAX: 715.675.4060
EMAIL: MAIL@REIENGINEERING.COM



REI CIVIL & ENVIRONMENTAL ENGINEERING, SURVEYING

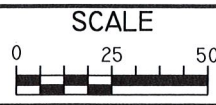

DATE	REVISION	BY	CHK'D

DESIGNED BY:	CHECKED BY: JWP
SURVEYED BY: JJM, B	APPROVED BY: JWP
DRAWN BY: JLR	DATE: 09/22/2021

PLAT OF SURVEY
NEELY OWEN
W4460 DAVEY LANE
MERRILL, WISCONSIN

REI
REI No. 10061
SHEET 1 OF 1

5778A