

SUN RIDGE ACRES

being part of the
NE 1/4 of the NW 1/4
and part of the
SE 1/4 of the NW 1/4
SECTION 20, T31N, R7E
Pine River Township
Lincoln County, Wisconsin

Alan Drum Associates, Inc.
Wausau, Wisconsin

CURVE NO.	RADIUS	CHORD LENGTH	CHORD BEARING	CENTRAL ANGLE	ARC LENGTH
1-4	126.30'	118.23'	S45°57'05.5"E	50°21'25"	197.98'
1-2	126.00'	64.48'	S70°48'46.5"E	29°59'03"	65.21'
2-3	126.00'	115.44'	S49°12'26.5"E	55°30'37"	117.68'
3-4	126.00'	15.38'	S49°02'15.5"E	6°51'45"	15.09'
3-6	61.00'	64.87'	N45°37'05.5"W	90°01'25"	94.27'

LOCATION SKETCH

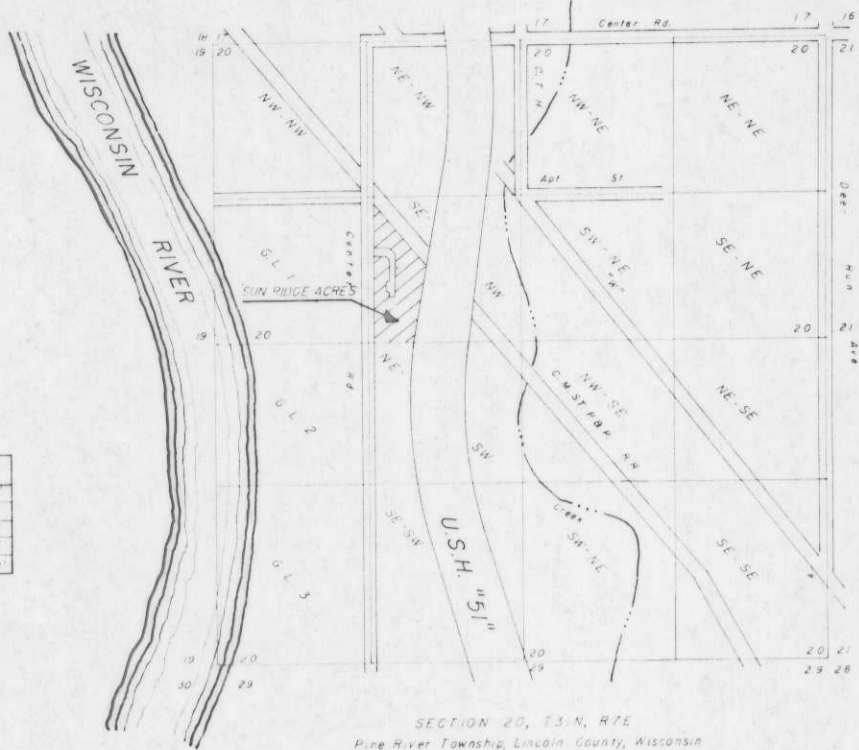

SECTION 20, T31N, R7E
Pine River Township, Lincoln County, Wisconsin



RECEIVED AT LINCOLN COUNTY
COURTHOUSE THIS 25th DAY
OF March 19 80
Pat Schick
TAX DESCRIPTION OFFICE

U.S.H. 51

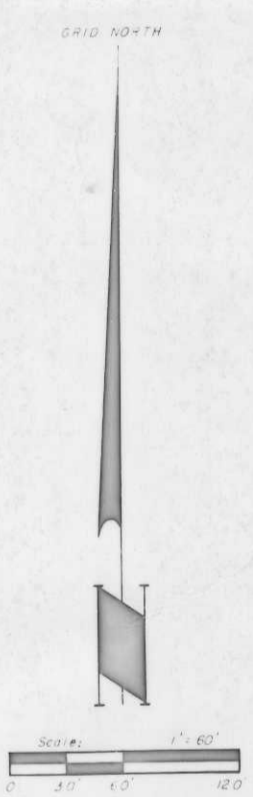

LEGEND
● = 3/4" x 30" solid round iron rod set, 1.50 lb/ft
○ = 1/4" x 30" solid round iron rod set, 4.17 lb/ft

LANDS OWNED BY OTHERS

There are no objections to this plat with respect to Secs. 236.15, 236.16, 236.20 and 236.21 (1) and (2), Wis. Stats., and H. 50 of the Wis. Admin. Code as provided by Sec. 236.12 (6), Wis. Stats.
Certified this 30th day of August, 1979
Robert J. Chittenden
Department of Local Affairs & Development



Sheridan D. Schwark
Registered Land Surveyor S-1205
Dated at Wausau, Wisconsin
This 7th day of August, 1979

CURVE 7-8	RADIUS	CHORD LENGTH	CHORD BEARING	CENTRAL ANGLE	ARC LENGTH
7-8	415.27'	570.27'	S7°27'38"W, 16.82'	10°15'58"	16.82'

East one-quarter corner, Section 20, T31N, R7E
6"x6" stone found by D.O.T. in 1970. Reestablished location for this survey by using D.O.T. flag.

Sheet 1 of 2
Drafted by A. Drum

B