

**Part of the  
NW 1/4 OF THE NW 1/4  
and part of the  
SW 1/4 OF THE NW 1/4  
SECTION 32, T35N, R6E,  
Town of Bradley  
Lincoln County, Wisconsin**

I, Emily K. Pierce, Professional Land Surveyor No. S-2728, hereby certify that I have surveyed the property shown hereon; that this map represents an accurate survey of said property to the best of my knowledge and belief; that I have performed this survey by order of Michael and Kate Kleen; and that I have complied with the requirements of Wisconsin Administrative Code A-E 7.  
STEIGERWALDT LAND SURVEYING, LLC

*Emily K. Pierce*

Professional Land Surveyor No. S-2728  
Dated October 11th, 2019  
Field work completed on October 8, 2019

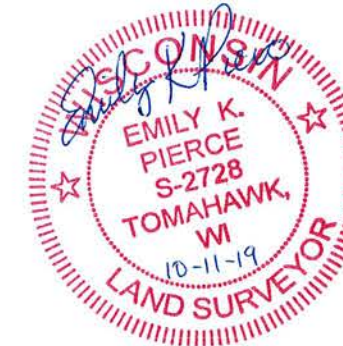

N  
↑  
Bearings Lincoln Co grid  
referenced to the West line of  
the Northwest Quarter, bearing  
S01°03'16"W.

**LEGEND**

- = Found 1.0" Iron Pipe
  - = Found 1.25" Iron Pipe
  - ◐ = Found 1.5" Iron Pipe
  - ◑ = Found 2.0" Iron Pipe
  - ⊙ = Septic Vent/Manhole
  - △ = Computed Position
  - ( ) = Recorded Dimension
- Monument sizes are outside diameter.  
Other corner monuments are as noted.

**STEIGERWALDT LAND SURVEYING, LLC**

856 NORTH 4TH STREET, TOMAHAWK, WI 54487  
PHONE #: (715) 453-3274 FAX #: (715) 453-8325  
www.steigerwaldt.com

JOB #: 6438    DWG #: 6438 Kleen    Sheet 1 of 1

**DOCUMENT #473407**

A survey of a parcel described in Doc. #473407, as recorded in the Lincoln County Register of Deeds, being located in the Northwest Quarter of the Northwest Quarter, and the Southwest Quarter of the Northwest Quarter, all in Section 32, Township 35 North, Range 6 East, Town of Bradley, Lincoln County, Wisconsin, more particularly described as follows:

Commencing at the Northwest Corner of Section 32, marked by a Berntsen Monument, thence S1°03'16"W, along the westerly line of the Northwest Quarter, a distance of 1368.01 feet to a point; thence S88°56'44"E, a distance of 100.63 feet to monumented northerly right of way of Sunset Point Road, being the place of beginning, marked by an iron pipe.

Thence S52°43'35"E, along said monumented northerly right of way, a distance of 100.57 feet to an iron pipe; thence N11°44'53"E, a distance of 89.02 feet to an iron pipe; thence N30°48'12"W, along a meander line of Lake Mohawksin, a distance of 133.54 feet to an iron pipe; thence S11°55'41"W, a distance of 144.05 feet to the place of beginning.

Including all lands between the above described meander line and the water's edge of Lake Mohawksin.

**Doc. # 473407**

± 10,770 Sq. Feet  
± 0.25 Acres  
to water's edge

SECTION CORNER  
Berntsen Monument



MEANDER CORNER  
Berntsen Monument



Impervious Surface Areas:  
Drip line of cabin and concrete patio: 1240 sq. ft  
Boat House: 530 sq. ft.  
Outbuilding: 40 sq. ft.  
Outbuilding: 20 sq. ft.  
Dirt driveway: 470 sq. ft.  
Total Impervious Area: 2300 sq. ft.

RECEIVED BY LINCOLN COUNTY  
SURVEYOR THIS 28<sup>TH</sup> DAY  
OF October 20 19  
*Tony Dall*  
COUNTY SURVEYOR

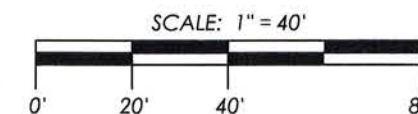

S 703 B