



PROFESSIONAL SERVICES

ARCHITECTURE | ENGINEERING | ENVIRONMENTAL
FUNDING | PLANNING | SURVEYING
1835 North Stevens St Rhinelander, WI 54501
(715) 362-3244 (800) 844-7854 Fax: (715) 362-4116
Web Address: www.msa-ps.com
© MSA Professional Services, Inc.

LANDS BEING PART OF
GOVERNMENT LOT 3,
SECTION 16, T.35.N,
R.5.E, TOWN OF
WILSON, LINCOLN
COUNTY, WI

PROJECT NO.	17911000
DRAWN BY:	KSM
SURVEYOR:	ECU
FILE NO.	-
SHEET NO.	1 OF 2

CLIENT:
ROBERT BARNETZKE

EXHIBIT MAP



BEARINGS REFERENCED TO
ASSUMED NORTH-SOUTH 1/4
LINE TO BEAR N1°10'00" E AS
PER DEED, VOL. 305, PG. 673

THIS MAP AND DESCRIPTION DRAFFED
FOR THE BENEFIT OF EXCHANGE OF
LAND BETWEEN ABUTTING OWNERS.

OWNER PARCEL A:
BRANTWOOD CO-OP PARK ASSOC.

RECEIVER: **ROBERT & PAMELA
BARNETZKE**

KADOW LANE

DRIVEWAY EASEMENT

66'

N-S 1/4 LINE
SEC. 16

VOL. 305
PG. 673

VOL. 281
PG. 347

OWNER:
BRANTWOOD CO-OP
PARK ASSOC.

OWNER: **ROBERT
AND PAMELA
BARNETZKE**

RECEIVED BY LINCOLN COUNTY
SURVEYOR THIS 25TH DAY
OF July 20 16
Tommy Walker
COUNTY SURVEYOR

ASSUMED N 01°10'00" E

GOV'T
LOT 3

MEANDER
CORNER
SEC 16

S 89°03'21" W 53.13'

+/- 28'

PARCEL
"A"

S 49°36'00" E 75.50'

N 05°01'00" W 50.00'

+/- 30'

SOMO
LAKE



S 585A

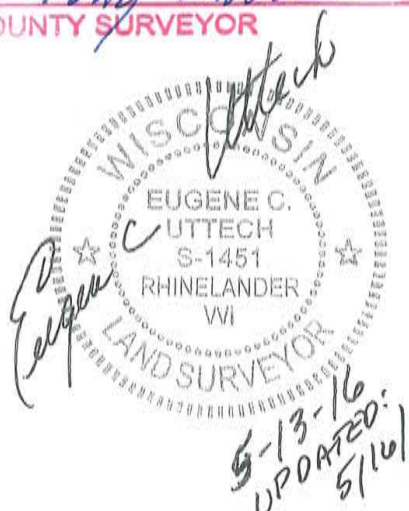

Small vertical text on the left margin: P:\17911000\17911000.dwg, 13 May 2016, 10:48:00 AM

THIS MAP AND DESCRIPTION DRAFTED FOR THE BENEFIT OF EXCHANGE OF LAND BETWEEN ABUTTING OWNERS.

OWNER: Brantwood Co-op Park Association

RECEIVER: Robert and Pamela Barnetzke

PARCEL "A":

This parcel is intended to be an addition to an existing parcel and cannot be sold as a separate parcel.

A parcel of land being part of Government Lot 3 of Section 16, T.35 N., R.5 E., Town of Wilson, Lincoln County, Wisconsin and being more particularly described as follows:

Beginning at the meander corner where the North-South 1/4 line intersects the northerly shore line of Somo Lake; thence S.49°36'00"E., along a meander line, a distance of 75.5 feet to the West line of lands described in Volume 281 of Deeds on Page 347 in the Register of Deeds office; thence N.05°01'00"W., along said West line, a distance of 50.00 feet; thence S.89°03'21"W., a distance of 53.13 feet to the point of beginning. Said parcel includes that land lying between said meander line and the ordinary high-water line of Somo Lake and the lateral extension of the above described lands.

Project No. 17911000

Sheet 2 of 2 Sheets

RECEIVED BY LINCOLN COUNTY
SURVEYOR THIS 25TH DAY
OF July 20 16
Tomy Dalk
COUNTY SURVEYOR

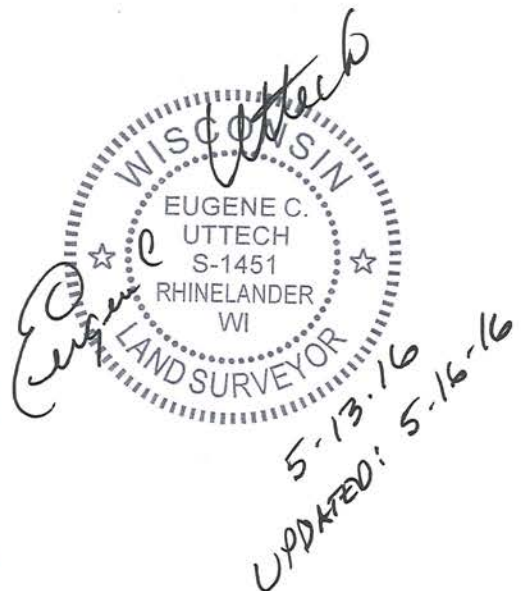

5585B