

N 1/4 SECTION 20
Aluminum Monument (See USPLS Monument Record)

ACCESS EASEMENT

located in the
NW 1/4 of the NE 1/4
SECTION 20, T35N, R6E
Town of Bradley
Lincoln County, Wisconsin

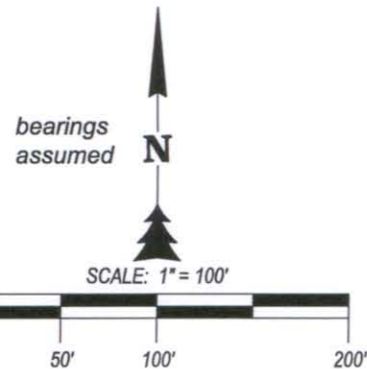

ACCESS EASEMENT (Map #3845Stahmer)

A 66 foot wide access easement across the Northwest Quarter of the Northeast Quarter, Section 20, Township 35 North, Range 6 East, for the purposes of ingress and egress to, and the benefit of the Northeast Quarter of the Northwest Quarter of said Section 20. The centerline of which is more particularly described as follows:

Commencing at the Northeast Corner of Section 20, marked by a survey marker nail in the bituminous surface of Tannery Road; thence along the Section Line between Sections 20 and 21, South 00 degrees 14 minutes 10 seconds East for a distance of 1322.64 feet to the North Sixteenth Corner between said Sections 20 and 21; thence along the south line of the Northeast Quarter of the Northeast Quarter of Section 20, North 89 degrees 44 minutes 15 seconds West for a distance of 1322.03 feet to the place of beginning of said centerline, being the Northeast Sixteenth Corner.

Thence North 61 degrees 23 minutes 17 seconds West for a distance of 80.00 feet, North 77 degrees 55 minutes 19 seconds West for a distance of 157.12 feet, North 89 degrees 44 minutes 15 seconds West for a distance of 276.13 feet, South 29 degrees 07 minutes 43 seconds West for a distance of 42.43 feet, and parallel to the south line of the Northwest Quarter of the Northeast Quarter, North 89 degrees 44 minutes 15 seconds West for a distance of 801.45 feet to the west line of the Northwest Quarter of the Northeast Quarter, and there terminating. The sidelines of the above described 66 foot wide access easement lengthen or shorten to begin on the east and south lines of the Northwest Quarter of the Northeast Quarter, and lengthen or shorten to terminate on the west line of said Northwest Quarter of the Northeast Quarter.

NW - NE
(CITY OF TOMAHAWK)

SW - NE

NE - NW
1293.11'
1326.11'
N 00°09'23"W 2662.21'

SE - ES
1326.11'

CENTER OF SECTION 20
1.25" dia. iron pipe found in place

E 1/16
CORNER
computed position

1321.13'
NE CORNER
SECTION 20
survey marker
nail found in
place (See USPLS
Monument Record)

GREEN BOX
ROAD
NE 1/16
CORNER
computed position

E 1/4 CORNER
SECTION 20
survey marker nail found
in place (See USPLS Monument Record)

S 00°14'10"E 2645.28'
N 00°11'46"W 2648.74'
S 00°14'10"E 2645.28'
N 00°11'46"W 2648.74'

ACCESS EASEMENT

801.45'
N 89°44'15"W

1322.03'

N 89°44'15"W

S 29°07'43"W
42.43'

existing 276.13' drive
N 89°44'15"W

N 77°55'19"W

228.86'
paved road
N 61°23'17"W
80.00'

1322.94'
N 89°48'47"W 2645.88'

1322.94'

SURVEYOR'S CERTIFICATE

I, Theodore G. Sommer, Registered Land Surveyor No. S-2964, hereby certify that I have surveyed the easement shown hereon; that this map represents an accurate survey of said easement to the best of my knowledge and belief; that I have performed this survey by the order of John Stahmer; and that I have complied with the requirements of Wisconsin Administrative Code A.E. 7.

STEIGERWALDT LAND SURVEYING, LLC

Theodore G. Sommer
Registered Land Surveyor No. S-2964
Dated this 13th day of November, 2012

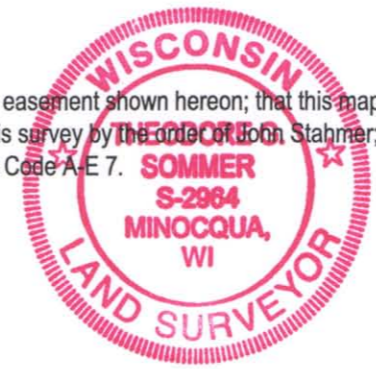

LEGEND

▽ = computed position, not monumented
Other corner monuments are as noted.

RECEIVED BY LINCOLN COUNTY
SURVEYOR THIS 15TH DAY
OF November, 20 12
Jerry Dalko
COUNTY SURVEYOR

STEIGERWALDT LAND SURVEYING, LLC		
856 NORTH 4TH STREET, TOMAHAWK, WI 54487 PHONE #: (715) 453-3274 FAX #: (715) 453-8325 www.slstomahawk.com		
JOB #: 3845	DWG #: 3845Stahmer	REV:

B22645