

# PLAT OF SURVEY

Of a part of the right-of-way of Row Road located in Government Lot 3 of Section 36, Township 32 North, Range 6 East, Town of Merrill, Lincoln County, Wisconsin.

EAST 1/4 CORNER  
SEC. 36, T32N, R6E,  
FOUND BERNTSEN MON.

WEST 1/4 CORNER  
SEC. 36, T32N, R6E,  
FOUND BERNTSEN MON.

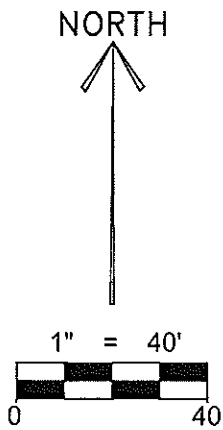

FOUND 3/4" REBAR  
S42°57'27"W - 8.61'  
(S40°54'29"W) (8.50')  
FROM CORNER

**CURVE DATA:**  
ARC LENGTH - 58.19'  
RADIUS - 400.00'  
DELTA - 8°20'06"  
CHORD - 58.14'  
CHORD BEARING - N 66°01'40" W  
(N65°35'52"W)

BEARINGS ARE REFERENCED TO THE  
EAST - WEST 1/4 LINE OF SECTION 36,  
TOWNSHIP 32 NORTH, RANGE 6 EAST,  
MEASURED TO BEAR NORTH 89°54'00" EAST.

CURVE TABLE					
CURVE	ARC LENGTH	RADIUS	CENTRAL ANGLE	CHORD BEARING	CHORD LENGTH
1 - 2	58.13'	185.00'	18°00'08"	N 43°11'32" W	57.89'
2 - 3	58.12'	185.00'	18°00'07"	N 61°11'39" W	57.89'
1 - 3	116.25'	185.00'	36°00'15"	N 52°11'36" W	114.35'
4 - 5	124.81'	235.00'	30°25'50"	S 54°58'48" E (N 54°33'00" W)	123.35'
5 - 6	22.86'	235.00'	5°34'25"	S 36°58'41" E	22.85'
4 - 6	147.67'	235.00'	36°00'15"	S 52°11'36" E	145.25'

LEGEND	
○	- 1-1/4" O.D. x 24" IRON PIPE WEIGHING 1.68 LBS/LIN. FT. SET
●	- FOUND 3/4" REBAR
●	- FOUND 1-1/2" O.D. IRON PIPE
( )	- RECORDED BEARING/LENGTH

## LEGAL DESCRIPTION

Of a part of the right-of-way of Row Road located in Government Lot 3 of Section 36, Township 32 North, Range 6 East, Town of Merrill, Lincoln County, Wisconsin described as follows:  
Commencing at the West 1/4 corner of said Section 36; Thence North 89°54'00" East along the East - West 1/4 line of said Section 36, 1891.38 feet; Thence South 00°06'00" East, 210.09 feet to the East right-of-way line of Row Road, the beginning of a tangential curve to the right and the point of beginning; Thence 147.67 feet along said East right-of-way line and the arc of said curve, said curve having a radius of 235.00 feet, a central angle of 36°00'15" and a chord that bears South 52°11'36" East for a distance of 145.25 feet; Thence continuing along said East right-of-way line South 34°11'28" East, 133.64 feet to the South line of Assessor's Plat of Semling's Subdivision; Thence South 89°54'00" West along the extension of said South line, 60.38 feet to the West right-of-way line of said Row Road; Thence North 34°11'28" West along said West right-of-way line, 99.80 feet to the beginning of a tangential curve to the left; Thence 116.25 feet along said West right-of-way line and the arc of said curve, said curve having a radius of 185.00 feet, a central angle of 36°00'15" and a chord that bears North 52°11'36" West for a distance of 114.35 feet; Thence North 19°48'17" East, 50.00 feet to said East right-of-way line of Row Road and the point of beginning.

That the above described parcel of land contains 12,434 square feet, or 0.285 acres more or less.

## SURVEYOR'S CERTIFICATE:

I, Nathan J. Wincentsen, Registered Land Surveyor S-2539, do hereby certify to the best of my knowledge and belief, that at the direction of the TOWN OF MERRILL, Agent of said lands, I have surveyed and mapped the lands described hereon. I further certify that said survey and map thereof are a correct and accurate representation of the exterior boundaries of said land and that I have fully complied with the provisions of Wisconsin Administrative Code A-E7 in surveying and mapping said lands.

Dated this 20<sup>TH</sup> day of SEPTEMBER 2011

*Nathan J. Wincentsen*  
Riverside Land Surveying, LLC  
Nathan J. Wincentsen  
WI R.L.S. S-2539

## NOTES:

- NO MONUMENTATION COULD BE FOUND ALONG THE SOUTH LINE OF ASSESSOR'S PLAT OF SEMLING'S SUBDIVISION. HELD THE DISTANCE OF 411' SOUTH OF THE EAST - WEST 1/4 LINE AS DESCRIBED IN THE SURVEYOR'S NOTES ON CERTIFIED SURVEY MAP NUMBER 1813.
- THE LOCATION OF THE RIGHT-OF-WAY WAS DETERMINED FROM CERTIFIED SURVEY MAP NUMBER 1813 AND THE EXISTING CENTERLINE WHICH FITS THE DISTANCE TO THE EDGE OF LAKE PESOBIC PER ASSESSOR'S PLAT OF SEMLING'S SUBDIVISION.

UNPLATTED LANDS OWNED BY  
ALLEN SHOLUND

UNPLATTED LANDS  
OWNED BY WDNR

(± 180')  
± 175'  
SOUTH LINE OF ASSESSOR'S PLAT OF  
SEMLING'S SUBDIVISION (SEE NOTE 1)

UNPLATTED LANDS OWNED BY  
HERBERT & RAMONA HORNISCHER

RECEIVED BY LINCOLN COUNTY  
SURVEYOR THIS 13<sup>TH</sup> DAY  
OF October 20 11  
*Terry Dahl*  
COUNTY SURVEYOR

LANDS OWNED BY  
HERBERT & RAMONA HORNISCHER

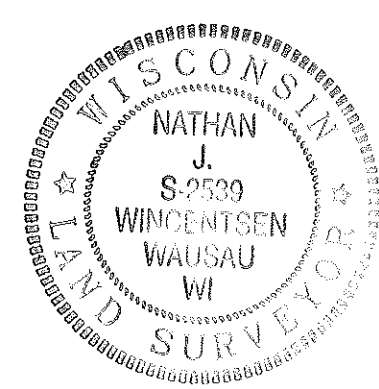

PROJECT No.  
**1816**

6304 KELLY PLACE WESTON, WI 54476  
PH 715-241-7500 - FAX 715-355-6894  
EMAIL - MAIL@RIVERSIDELANDSURVEYING.COM



DESIGNED BY: NJW/JML  
SURVEYED BY: NJW/JML  
DRAWN BY: NJW/JML  
CHECKED BY: NJW  
APPROVED BY:  
DATE: SEPT. 20, 2011

PLAT OF SURVEY OF ROW ROAD  
SEC. 36, T32N, R6E,  
TOWN OF MERRILL, LINCOLN COUNTY

SHEET  
**1 OF 1**

**5442B**

LAKE PESOBIC  
WATER EDGE