

LEGEND
 ○ 1" x 48" iron pipe set
 ● 1 1/4" iron pipe found unless noted otherwise
 X steel fence post set
 Note: distances between fence posts set on line have been rounded to the nearest foot.
 — line brushed open & marked with steel fence posts

Note: In 2004, I surveyed this line for Chuck Swan, former owner of the land now owned by Bob Crucius. A copy of that survey is on file in the Lincoln County Surveyors office. This line now had to be re-surveyed because the marks set along this line were removed by someone since the 2004 survey. I now re-set the Center West 1/16th corner and set steel fence posts along the line as shown.

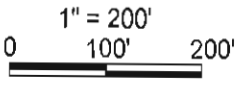

I, David E. Tlusty, hereby certify that, under the direction of Bob Crucius, owner, I have made a survey of the South line of the NW 1/4 of Section 24, Township 33 North, Range 8 East, Lincoln County, Wisconsin, as shown hereon. I further certify that this map is a true and correct representation of said survey and that this survey is correct to the best of my knowledge and belief.

May 28, 2011
David E. Tlusty
 David E. Tlusty
 Wisconsin Registered Land Surveyor S-1390

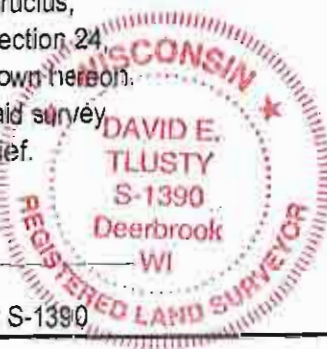

RECEIVED BY LINCOLN COUNTY
 SURVEYOR THIS 13th DAY
 OF June 20 11
Tammy Dalt
 COUNTY SURVEYOR

David E. Tlusty, RLS Deerbrook, Wisconsin 54424	Survey for Bob Crucius. The South line of the NW 1/4 of Section 24, T. 33 N., R. 8 E., Lincoln County, WI.		
	SCALE: 1" = 200'	DATE: May 2011	DRAWN BY: dt
		MAP #:	

Surveyed May 26, 2011

5436B

Co Surveyor Copy 5/27/11