

PLAT OF SURVEY

OF

THE NORTHWEST QUARTER OF THE SOUTHEAST QUARTER OF SECTION 32,
TOWNSHIP 33 NORTH, RANGE 4 EAST, TOWN OF CORNING, LINCOLN COUNTY,
WISCONSIN

UNPLATTED LANDS OWNED BY OTHERS

N 87°10'02" E
1367.64'

N 87°10'02" E
1367.64'

FOUND 2 INCH
IRON PIPE
W/WOOD POST



N 87°10'02" E
2735.79'

FOUND 2 INCH IRON
PIPE W/WOOD POST
2.58' SOUTH
93.51' WEST

FOUND
BERTNSEN
MONUMENT



S 03°24'59" E
2651.64'

FOUND
BERTNSEN
MONUMENT



FOUND 1" IRON PIPE
12.04' SOUTH
140.79' WEST

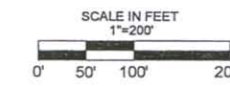

BEARINGS ARE BASED ON THE
LINCOLN COUNTY COORDINATE SYSTEM

LEGEND

●	SET 1" X 18" IRON PIPE
⊙	FND 2.0" INCH IRON PIPE
○	FND 1.0 INCH IRON PIPE
---	SIXTEENTH LINE
---	QUARTER LINE
---	BOUNDARY LINE

UNPLATTED LANDS OWNED BY OTHERS

N 03°24'59" W

1323.05'

NW/SE
SEC. 32,
T33N-R4E

1345.61'

S 03°02'52" E

UNPLATTED LANDS OWNED BY OTHERS

NOTES

- SECTION SUBDIVISION IS BASED ON SECTION SUMMARY FOR SECTION 32 COMPLETED BY CWE, INC. FOR THE TOWN OF CORNING AND ON FILE AT THE LINCOLN COUNTY SURVEYORS OFFICE.
- SURVEY CONSISTED OF MARKING THE EXTERIOR LINE OF THE NORTHWEST QUARTER OF THE SOUTHEAST QUARTER OF SECTION 32 WITH FLAGGING ON THE NEAREST TREE.
- IMPROVEMENTS, ROADWAYS, WATERWAYS, OR TRAILS WERE NOT LOCATED AS PART OF THIS SURVEY.

STATE OF WISCONSIN
COUNTY OF MARATHON

I, RONALD K. JACOBSON, DO HEREBY CERTIFY THAT I AM A REGISTERED LAND SURVEYOR, LICENSED IN THE STATE OF WISCONSIN; THAT THE SURVEY OF THIS PLAT WAS MADE UNDER MY DIRECTION; THAT THE SURVEY IS TRUE AND COMPLETE AS SHOWN TO THE BEST OF MY KNOWLEDGE AND BELIEF; AND THAT ALL MONUMENTS AND MARKS ARE OF THE CHARACTER AND OCCUPY THE POSITION SHOWN THEREON.

DATE MAY 13, 2010

FOUND 2" IRON PIPE
W/WOOD POST
1.20' SOUTH
47.51' WEST

FOUND 2"
IRON PIPE



N 03°24'59" W
1323.05'

1359.40'
S 88°07'15" W

UNPLATTED LANDS OWNED BY OTHERS

FOUND 1" IRON PIPE
W/WOOD POST
2.67' NORTH
73.32' WEST

RECEIVED BY LINCOLN COUNTY
SURVEYOR THIS 14TH DAY
OF May 20 10
Zany Dab...
COUNTY SURVEYOR

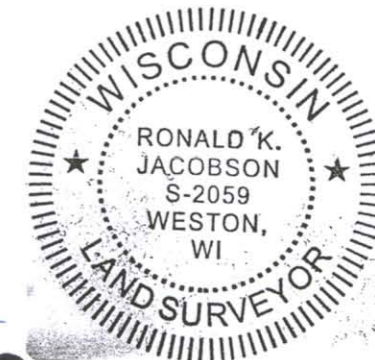

S421B

CWE, Inc.
5707 SCHOFIELD AVE.
WESTON, WISCONSIN 54476
PHONE: (715) 359-9400 FAX:
(715) 355-4199
general@cwengineers.com
www.cwengineers.com

PROJECT:

PLAT OF SURVEY
STEVE PETERSON
NW/SE SEC. 32 T33N R4E
TOWN OF CORNING
LINCOLN COUNTY, WISCONSIN

REVISIONS:

PROJECT NO.	41001000
DRAWN BY:	T.R.
CHECKED BY:	R.J.
APPROVED BY:	R.J.
DATE:	05/13/10
SHEET:	1 OF 1