

R.E.I. 4080 N. 20th AVE WAUSAU, WI 54401 (715)675-9784

LINCOLN CO. PLAT OF SURVEY

OF LOT 1 OF LINCOLN COUNTY CERTIFIED SURVEY MAP NUMBER 299 AND OF PART OF THE SOUTHWEST 1/4 OF THE SOUTHEAST 1/4, SECTION 28, TOWNSHIP 33 NORTH, RANGE 8 EAST, VILLAGE OF GLEASON, LINCOLN COUNTY, WISCONSIN.

SURVEYOR'S CERTIFICATE

I, David A. Renaud Registered Land Surveyor S-2142, do hereby certify to the best of my knowledge and belief: That I have surveyed, and mapped Lot 1 of Lincoln County Certified Survey Map Number 299 and a part of the Southwest 1/4 of the Southeast 1/4, Section 28, Township 33 North, Range 8 East, Village of Gleason, Lincoln County, Wisconsin, the exterior boundary of this survey described as follows:

Commencing at the South 1/4 corner of said Section 28; Thence North 89°50'04" East along the the South line of said Southwest 1/4 of the Southeast, 313.60 feet; Thence North 00°09'56" West 33.00 feet to the North right-of-way line of County Highway "X", and the point of beginning; Thence North 00°00'00" East 74.25 feet; Thence South 89°50'04" West 98.82 feet; Thence North 00°24'48" East, 214.05 feet; Thence South 89°55'25" East, 16.50 feet; Thence North 0°00'17" East, 115.80 feet; Thence North 62°26'07" East, 180.00 feet; Thence North 13°12'35" West, 125.62 feet to the South right-of-way line of State Highway "17", and the beginning of a non-tangential curve; Thence 173.50 feet along the arc of said curve having a radius of 5696.58 feet, an included angle of 1°44'42", and a chord that bears North 63°14'36" East for a distance of 173.50 feet; Thence continuing along said right-of-way of said State Highway "17" South 00°55'34" West, 30.27 feet; Thence continuing along said right-of-way of State Highway "17" North 64°31'18" East, 73.67 feet to the East line of CSM # 299; Thence South 00°55'34" West along said East line of CSM # 299, 421.20 feet to the South line of said CSM # 299; Thence South 89°50'04" West along said South line of CSM # 299, 66.00 feet; Thence South 00°55'34" West, 267.05 feet to said North right-of-way line of County Highway "X"; Thence South 89°50'04" West along said North right-of-way line of County Highway "X", 193.91 feet to the point of beginning.

The above described parcel contains 4.051 acres more or less;

That said parcel is subject to all easements, right-of-ways, and restrictions of record;

That I have made this survey and map thereof by the direction of Ellen Ganz and Bruce Pollack, OWNERS of said parcels;

That I have fully complied with the provisions of Wisconsin Administrative Code A-E7 surveying, and mapping said parcel;

That said map is correct and accurate representation of the exterior boundaries of said parcel.

Dated this 12th day of December, 2002

David Renaud
REI Engineering
David A. Renaud (agent)
WI R.L.S. S-2142

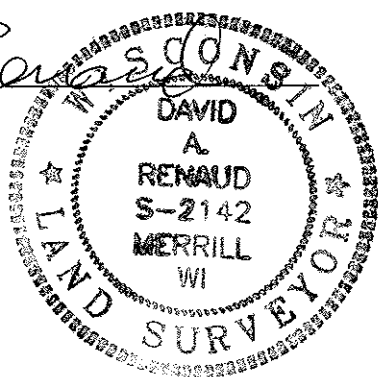

RECEIVED AT LINCOLN COUNTY
COURTHOUSE THIS 12TH DAY
OF December 20 02
Tony Dalko
LAND INFORMATION OFFICE