

CERTIFIED SURVEY MAP

I, David L. Osterbrink, Registered Land Surveyor, hereby certify that I have surveyed and mapped at the direction of Doug Kufahl, buyer, that part of the Northeast $\frac{1}{4}$ of the Northwest $\frac{1}{4}$ of Section 31, Township 32 North, Range 7 East, Town of Merrill, Lincoln County, Wisconsin, described as follows:

Lot -4- Commencing at the Northwest corner of said Section 31; thence N88°00'17"E along the North line of the Northwest $\frac{1}{4}$ of Section 31, 1611.41 feet to the West line of the Northeast $\frac{1}{4}$ of the Northwest $\frac{1}{4}$ of Section 31 and the point of beginning; thence S1°09'10"E along said line, 665.79 feet to the South line of the North $\frac{1}{2}$ of the Northeast $\frac{1}{4}$ of the Northwest $\frac{1}{4}$ of Section 31; thence N88°09'29"E along said line, 43.22 feet to the West right-of-way of Maplewood Road; thence N2°17'43"W along said right-of-way, 665.84 feet to the North line of the Northeast $\frac{1}{4}$ of the Northwest $\frac{1}{4}$ of Section 31; thence S88°00'17"W along said line, 29.95 feet to the point of beginning.

Lots 1, 2, & 3 Commencing at the Northwest corner of said Section 31; thence N88°00'17"E along the North line of the Northwest $\frac{1}{4}$ of Section 31, 1611.41 feet to the West line of the Northeast $\frac{1}{4}$ of the Northwest $\frac{1}{4}$ of Section 31; thence S1°09'10"E along said line, 665.79 feet to the South line of the North $\frac{1}{2}$ of the Northeast $\frac{1}{4}$ of the Northwest $\frac{1}{4}$ of Section 31; thence N88°09'29"E along said line, 109.22 feet to the East right-of-way of Maplewood Road and the point of beginning; thence N2°17'43"W along said right-of-way, 437.43 feet; thence continuing along said right-of-way along the arc of a curve whose long chord bears N42°35'47"E, 258.36 feet; thence N87°29'17"E along the South right-of-way of White Birch Road, 916.21 feet to the Westerly right-of-way of U.S. Highway "51"; thence S47°15'25"E along said right-of-way, 129.52 feet; thence S2°00'07"E, continuing along said right-of-way, 541.68 feet to the South line of the North $\frac{1}{2}$ of the Northeast $\frac{1}{4}$ of the Northwest $\frac{1}{4}$ of Section 31; thence S88°09'29"W along said line, 1187.33 feet to the point of beginning.

Subject to easements and roadways of record.

That such map is a correct representation of all exterior boundaries of the land surveyed. That I have fully complied with the provisions of Section 236.34 of the Wisconsin Statutes. That this survey is correct to the best of my knowledge and belief.

Prepared By:
Northwoods Surveying
623 Jefferson Street
Wausau, WI 54403
715-845-1249

David L. Osterbrink RLS No. S-2014
Survey completed January 20, 1996

Page 2 of 2

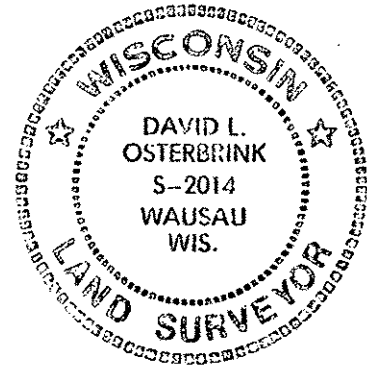

S383B