

R.E.I. 4080 N. 20th AVE WAUSAU, WI 54401 (715)675-9784

# Plat of Survey

## SURVEYOR'S CERTIFICATE

I, David A. Renaud, Wisconsin Registered Land Surveyor S-2142, do hereby certify that: To the best of my knowledge and belief, that I have surveyed the following described parcel of land and that I have fully complied with the provisions of Wisconsin Administrative Code Chapter A-E7, and that this map accurately depicts the exterior boundaries of said parcel.

That I have made this survey and the map thereof at the direction of Park City Auto Spa, LLC, owner of the following described parcel.

Dated this 5th day of JANUARY, 2000

David Renaud  
David A. Renaud, R.L.S. S-2142  
REI Engineering

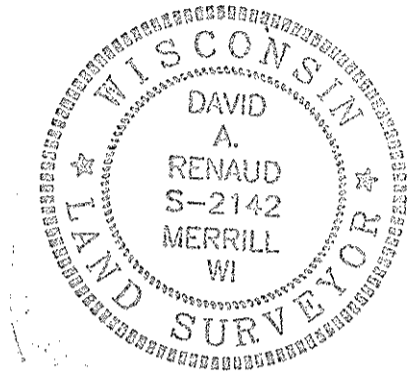

## LEGAL DESCRIPTION

A part of the Southeast Quarter of the Southeast Quarter (SE 1/4 SE 1/4) of Section Eleven (11), Township Thirty-one (31) North, Range Six (6) East, in the City of Merrill, Lincoln County, Wisconsin, described as follows:

Assessor's Plat Lot 321 of the Assessor's Plat of the City of Merrill, Lincoln County, Wisconsin, described as follows: Beginning 66 feet South of the Southeast corner of Block Five (5), of the Plat of T.B. Scott Lumber Company's Addition to Merrill, and running thence West from said point 50 feet; thence South to the Prairie River; thence Southeasterly along the said Prairie River to the West line of Logan Street, extended South; thence North to the place of beginning.

AND

That part of Assessor's Plat 320 of the Assessor's Plat of the City of Merrill, Lincoln County, Wisconsin, described as follows: Commencing at a point in the southerly line of First Street, 50 feet West of the intersection of the southerly line of First Street and the West line of Logan Street, extended, which is the place of beginning of the parcel herein described; thence continuing Westerly along the Southerly line of First Street 20 feet; thence Southerly at right angles to the Southerly line of First Street to the bank of the Prairie River; Thence Easterly along the meander line of said river to a point which is directly South of the point of beginning; thence North to the place of beginning. Subject to those restrictions set forth in Vol. 142 of Deeds on page 563.

AND

Beginning 66 feet South of the Southeast corner of Block Five (5), of T.B. Scott Lumber Company's Addition to Merrill, Wisconsin, as aforesaid, and running thence East along the South line of East First Street a distance of 20 feet to the alley established by Resolution No. 308 of the Common Council of the City of Merrill, Wisconsin, on the 9th. day of March, 1976; thence South parallel to the West boundary of Logan Street extended to the North line of the East-West alley extended and parallel with and South of East First Street; thence 20 feet West along the North line of the East-West alley extended and parallel with and South of East First Street; thence North on the East line of Assessor's Plat No. 321 of the Assessor's Plat of the City of Merrill, Wisconsin, to the place of beginning.

Said parcel is subject to public right-ofway, highways and other easements of record.

S325B