

INDEX OF SHEETS

- Sheet No. 1 Title
- Sheet No. 2-2.6 Typical Sections and Details
- Sheet No. 3 Estimate of Quantities
- Sheet No. 3A Miscellaneous Quantities
- Sheet No. 4-4.2 Right of Way Plot
- Sheet No. 5 Plan and Profile
- Sheet No. 6-6.18 Standard Detail Drawings
- Sheet No. 7 Sign Plates
- Sheet No. 8-8.11 Structure Plans
- Sheet No. 9 Computer Earthwork Data
- Sheet No. 9.1-9.10 Cross Sections

TOTAL SHEETS = 55

STATE OF WISCONSIN  
DEPARTMENT OF TRANSPORTATION  
**PRAIRIE RIVER BRIDGE  
& APPROACHES**

S.T.H. 17  
LINCOLN COUNTY

STATE PROJECT	FEDERAL PROJECT	
	PROJECT	CONTRACT
9031-09-70		

METRIC PROJECT

13-33-8  
SW SW

CONTRACTOR: *EARTH, INC.*  
SUBCONTRACTORS: *AEIFFER BROS.*  
*CONST. CO., AMERICAN ASPHALT of*  
*WI., PORT EDWARDS CONC., STRAIGHT*  
*ARCON CONST. CO., BARRICADE*  
*FLASHER SERVICE*  
PROJ. ENG.: *JAMIE RICE*  
PROJ. STAFF: *PROJ. DIR. 97-12*  
START DATE: *AUG. 13, 1997*  
SUSPEND DATE: *NOV. 7, 1997*  
RESUME DATE: *APRIL 7, 1998*  
DATE COMPLETED: *MAY 22, 1998*

STATE PROJECT NUMBER  
9031-09-70

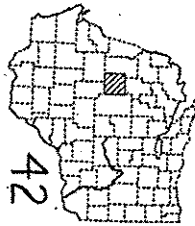

BEGIN PROJECT  
STA. 24+505.969 @ STH 17  
X = 641,860.168m  
Y = 166,891.884m

DESIGN DESIGNATION

A.D.T. 1997	2500
A.D.T. 2017	3200
D.A.V.	522
D.	60/40
T.	5.7%
DESIGN SPEED	100km/h
ESALS	642,400

CONVENTIONAL SYMBOLS

COUNTY LINE	CONSTRUCTIBLE FLUIDS	
CORPORATE LIMITS	UNDERGROUND UTILITIES	
PROPERTY LINE	GAS	
LOT LINE	ELECTRIC	
LIMITED EASEMENT	TELEPHONE OR TELEGRAPH	
EXISTING RIGHT OF WAY	SERVICE PEDESTAL	
PROPOSED OR AER R/W LINE	CABLE MARKER	
SURVEY LINE	POWER POLE	
SLOPE INTERCEPT	TELEPHONE POLE	
ORIGINAL GROUND	RAILROAD	
MARSH OR ROCK PROFILE	MARSH AREA	
EXISTING CULVERT	WOODED OR SHRUB AREA	
PROPOSED CULVERT	SILT FENCE	
CULVERT (Profile View)	SILT SCREEN	

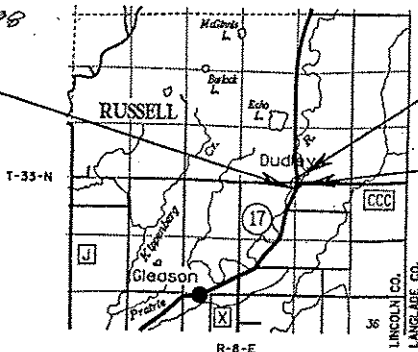

END PROJECT  
STA. 25+100 @ STH 17

STRUCTURE B-35-0101  
STA. 24+753

COORDINATES ON THIS PLAN ARE REFERENCED TO THE WISCONSIN COORDINATE SYSTEM, CENTRAL ZONE. COORDINATE DATA IS MAD 1983 (1991).

COORDINATES ARE BASED ON NATIONAL GEODETIC VERTICAL DATUM 1929 ADJUSTMENT (NGVD 29).

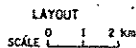

TOTAL NET LENGTH OF CENTERLINE = 0.598 km RURAL

STATE OF WISCONSIN  
DEPARTMENT OF TRANSPORTATION

PREPARED BY: *JACK B. WALKER*  
DESIGNER: *MICHAEL D. GRACE*  
DISTRICT ENGINEER: *WILLIAM S. STEIN*  
DISTRICT SUPERVISOR: *DAVID D. BERGER*  
PROJ. DES. ENGINEER: *J.E. WALKER*  
C.D. EXAMINER: *N.E. APPELLET*

APPROVED FOR DISTRICT OFFICE  
DATE: *5/17/98* *Jay E. Schulz*  
Signature

AUTHORIZED FOR CENTRAL OFFICE DESIGN  
DATE: *10-30-96* *N. E. Appellet*  
Signature

FILE NAME: DT W03109MTRIC.DGN

WIDDOT: MSHT10

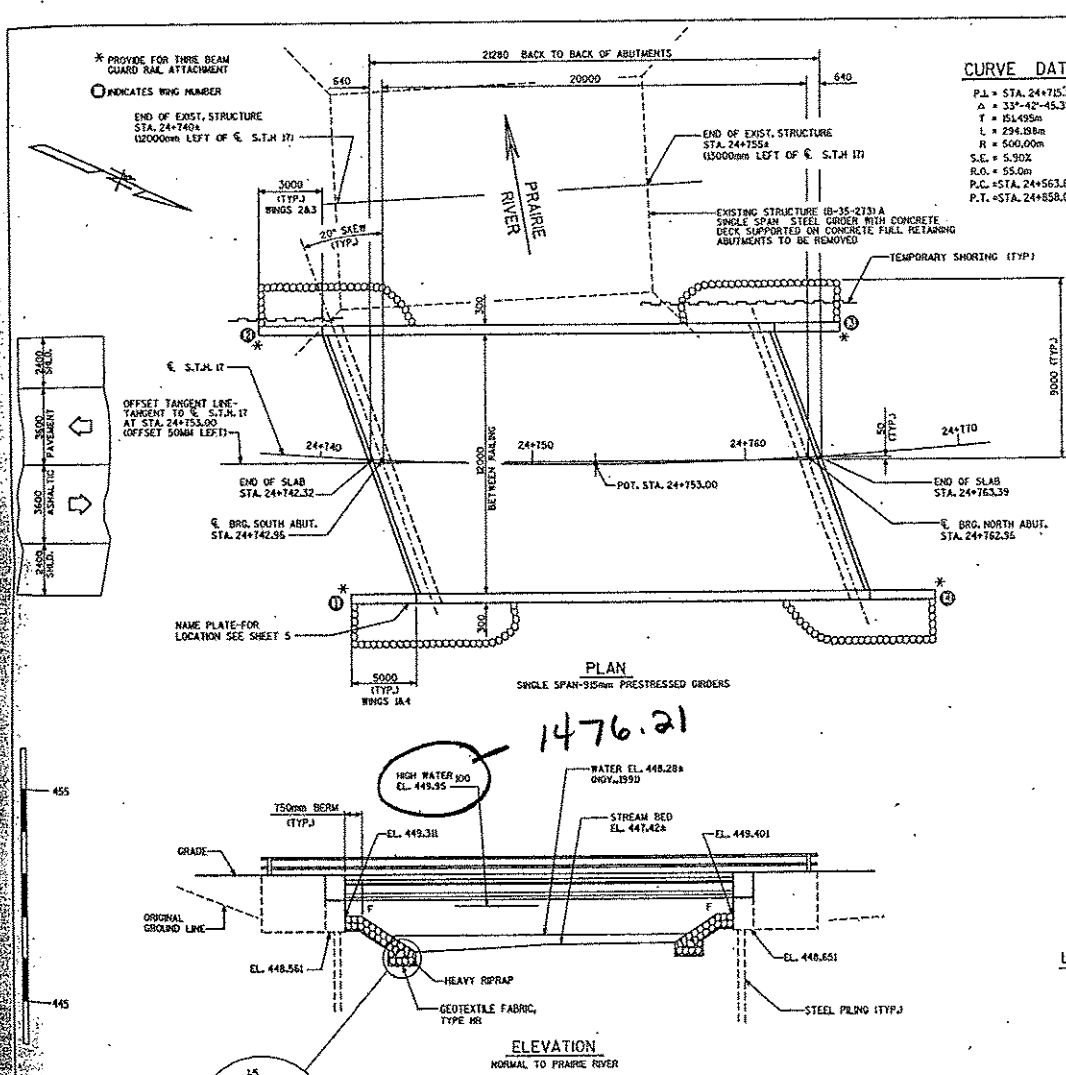

CURVE DATA

P.L. = STA. 24+715.31
Δ = 33°-42'-45.33"
T = 154.495m
L = 294.198m
R = 500.00m
S.C. = 5.302
R.O. = 55.0m
P.C. = STA. 24+563.82
P.T. = STA. 24+858.02

DESIGN DATA

LIVE LOAD:  
DESIGN RATING: MS-18  
INVENTORY RATING: MS-21  
OPERATIONAL RATING: MS-35  
MAXIMUM STANDARD PERMIT VEHICLE LOAD = 100 kN  
STRUCTURE IS DESIGNED FOR A FUTURE WEARING SURFACE OF 1.0 kN/m<sup>2</sup>.

ULTIMATE DESIGN STRESSES:  
CONCRETE MASONRY SLAB — f<sub>c</sub> = 28 MPa ALL OTHER — f<sub>c</sub> = 24 MPa  
BAR STEEL REINFORCEMENT, GRADE 400 — f<sub>y</sub> = 400 MPa  
915 mm PRESTRESSED ORDERS, CONCRETE MASONRY — f<sub>c</sub> = 42 MPa  
STRANDS — 13 mm DIA. WITH ULTIMATE TENSILE STRENGTH OF 1860 MPa

FOUNDATION DATA

ABUTMENTS TO BE SUPPORTED ON HP 250x62 STEEL PILING DRIVEN TO A MINIMUM BEARING VALUE OF 450 kN PER PILE. ESTIMATED 5.0m LONG.

HYDRAULIC DATA

100 YEAR FREQUENCY  
Q<sub>100</sub> = 52.7 m<sup>3</sup>/s  
VEL = 3.2 m/s  
HW = EL. 448.95  
WATERWAY AREA = 16.4 m<sup>2</sup>  
DRAINAGE AREA = 159.0 km<sup>2</sup>  
ROAD OVERTOPPING = NA  
SCOUR CRITICAL CODE = B

TRAFFIC VOLUME

S.T.H. 17  
A.D.T. = 3,200 (2007)  
R.D.S. = 100 km/h  
**1476.21** AMSL

BENCH MARK:

NO.	STATION	DESCRIPTION	ELEV.
2	24+738	BRASS CAP S.E. WINGWALL B-35-273	451.952

BRIDGE OFFICE CONTACT:  
VU THANG (608) 1266-5090  
KENT A. BARKER (608) 266-8490

LIST OF DRAWINGS

1. GENERAL PLAN
2. CROSS SECTION & QUANTITIES
3. SUBSURFACE EXPLORATION
4. SOUTH ABUTMENT
5. SOUTH ABUTMENT DETAILS
6. NORTH ABUTMENT
7. NORTH ABUTMENT DETAILS
8. 915 mm PRESTRESSED GIRDER DETAILS
9. STEEL DIAPHRAGM
10. SUPERSTRUCTURE
11. SUPERSTRUCTURE DETAILS
12. TUBULAR RAILING TYPE "F"

NO.	DATE	REVISION	BY
STATE OF WISCONSIN DEPARTMENT OF TRANSPORTATION DIVISION OF HIGHWAYS			
<b>STRUCTURE B-35-101</b>			
S.T.H. 17 OVER PRAIRIE RIVER			
COUNTY	LINCOLN	TOWNSHIP	RUSSELL
DESIGN SPEC.	AASHTO 1994	LOAD	MS-18
DESIGNED BY	SDR	DESIGN	NGW
DRAWN BY	RIES	PLANS	GGP
APPROVED	<i>David H. Anderson</i>	DATE	10-30-96
CHIEF BRIDGE DESIGN ENGINEER			DATE
GENERAL PLAN			SHEET 1 OF 12
			DATE: APR '96

S302A

I.D. 9031-09-00

SCALE: 100  
FILE: J0309.DGN

1482.78