

PLAT OF SURVEY

OF
THE NORTHWEST QUARTER OF THE NORTHWEST QUARTER
OF SECTION 23, TOWNSHIP 33 NORTH, RANGE 4 EAST,
TOWN OF CORNING, LINCOLN COUNTY, WISCONSIN

NW CORNER
SECTION 23
T33N R4E

1431.45'
N 89°06'52" W

N 89°06'52" W 1431.45'

N ¼ CORNER
SECTION 23
T33N R4E

NORTH LINE SECTION 23
T33N R4E

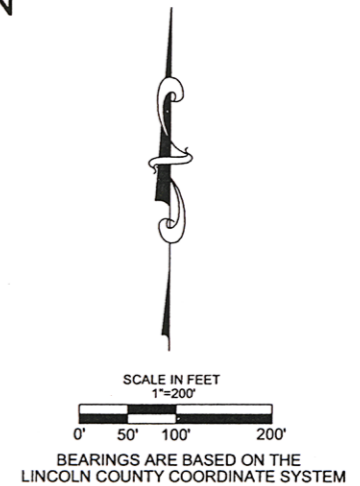

NW/NW

JAMES & TERRY
PATRICK

2,119,322 SQ. FT.
48.653 ACRES

1494.16'
N 01°19'39" W

1474.11'
N 01°08'08" W

LEGEND

---	SECTION LINE
---	SIXTEENTH LINE
---	BOUNDARY LINE
●	SET 1.25" O.D. X 18" IRON PIPE 1.68 LBS./LIN. FT.
⊗	FOUND LINCOLN COUNTY BERNSTEIN MONUMENT
○	CALCULATED CORNER FROM SECTION 14 SUMMARY AT LINCOLN COUNTY SURVEYOR'S OFFICE

STATE OF WISCONSIN
COUNTY OF MARATHON

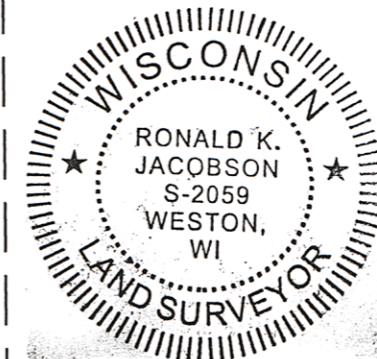

I, RONALD K. JACOBSON, DO HEREBY CERTIFY THAT I AM A REGISTERED LAND SURVEYOR, LICENSED IN THE STATE OF WISCONSIN; THAT THE SURVEY OF THIS PLAT WAS MADE UNDER MY DIRECTION; THAT THE SURVEY IS TRUE AND COMPLETE AS SHOWN TO THE BEST OF MY KNOWLEDGE AND BELIEF; AND THAT ALL MONUMENTS AND MARKS ARE OF THE CHARACTER AND OCCUPY THE POSITION SHOWN THEREON.

RECEIVED BY LINCOLN COUNTY SURVEYOR THIS 26TH DAY OF November 20 08
Tommy Dahl
COUNTY SURVEYOR

WEST LINE SECTION 23
T33N R4E

N 89°54'44" W
1425.88'

S289A



CWE, Inc.

5707 SCHOFIELD AVE.
WESTON, WISCONSIN
54476

PHONE: (715) 359-9400
FAX: (715) 355-4199

general@cwengineers.com
www.cwengineers.com

PROJECT:

PLAT OF SURVEY
NW/NW, SECTION 23
TOWN OF CORNING
LINCOLN COUNTY, WISCONSIN

REVISIONS:

CWEA Project No.:
39310800

DRAWN BY:
T.G.R.

CHECKED BY:
RJ

APPROVED BY:
RJ

DATE:
11/25/2008

SHEET:
1 OF 1