

PREPARED FOR:
Michael Schellinger
3151 Senn Road
Omro, WI 54963
Sheet 2 of 2

PREPARED BY:
MSA Professional Services, Inc.
1835 N. Stevens Street
Rhineland, WI 54501
January 23, 2007

**LEGAL DESCRIPTION
(Michael Schellinger Parcel)**

Lands being part of the Northwest quarter of the Southeast quarter of the Southeast quarter of Section 24, Township 35 North, Range 6 East, Town of Bradley, Lincoln County, Wisconsin, more fully described as:

Commencing at the Southeast (SE) corner of Section 24; thence N88°58'13"W, along the South line of Section 24, a distance of 1314.13 feet to the West line of the Southeast quarter of the Southeast quarter of Section 24; thence N00°19'58"W, along said West line, a distance of 658.91 feet to the South line of the Northwest quarter of the Southeast quarter of Section 24 and the POINT OF BEGINNING; thence continuing N00°19'58"W, along said West line, a distance of 658.91 feet to the North line of the Southeast quarter of the Southeast quarter of Section 24; thence S89°03'55"E, along said North line, a distance of 600.00 feet; thence S00°56'05"W, a distance of 200.00 feet; thence N89°03'55"W, a distance of 225.33 feet; thence S04°38'52"W, a distance of 223.16 feet; thence S67°49'28"E, a distance of 42.68 feet; thence S00°56'05"W, a distance of 191.85 feet; thence N89°03'55"W, a distance of 130.00 feet; thence S00°56'05"W, a distance of 28.96 feet to the South line of the Northwest quarter of the Southeast quarter of the Southeast quarter of Section 24; thence N89°01'04"W, along said South line, a distance of 255.43 feet to the POINT OF BEGINNING. Containing 6.61 acres more or less and subject to all easements, restrictions, reservations and rights-of-way of record.

**LEGAL DESCRIPTION
(Parcel to be deeded to Weyers)**

Lands being part of the Northwest quarter of the Southeast quarter of the Southeast quarter of Section 24, Township 35 North, Range 6 East, Town of Bradley, Lincoln County, Wisconsin, more fully described as:

Commencing at the Southeast (SE) corner of Section 24; thence N88°58'13"W, along the South line of Section 24, a distance of 1314.13 feet to the West line of the Southeast quarter of the Southeast quarter of Section 24; thence N00°19'58"W, along said West line, a distance of 1317.82 feet to the North line of the Southeast quarter of the Southeast quarter of Section 24; thence S89°03'55"E, along said North line, a distance of 600.00 feet; thence S00°56'05"W, a distance of 200.00 feet; thence N89°03'55"W, a distance of 200.00 feet to the POINT OF BEGINNING; thence continuing N89°03'55"W, a distance of 25.33 feet; thence S04°38'52"W, a distance of 223.16 feet; thence S67°49'28"E, a distance of 42.68 feet; thence N00°56'05"E, a distance of 238.15 feet to the POINT OF BEGINNING. Containing 0.17 acres more or less and subject to all easements, restrictions, reservations and rights-of-way of record.

RECEIVED BY LINCOLN COUNTY
SURVEYOR THIS 26TH DAY
OF January 20 07
Tommy Dahl
COUNTY SURVEYOR

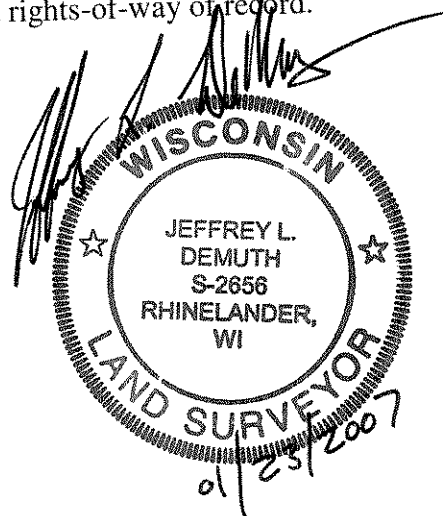

S247B