



P.K. nail in power pole S84°E 18.87'
 P.K. nail in 6" spruce N40°E 37.19'
 P.K. nail in power pole S15°W 81.66'

50'

ROAD
 CREEK
 CAIN

N1°00'W
 2624.0'

50'



P.K. nail in fence post S88°E 23.58'
 P.K. nail in fence post S22°W 51.35'
 P.K. nail in fence post West 22.91'

Scale 1" = 60'

August, 1972

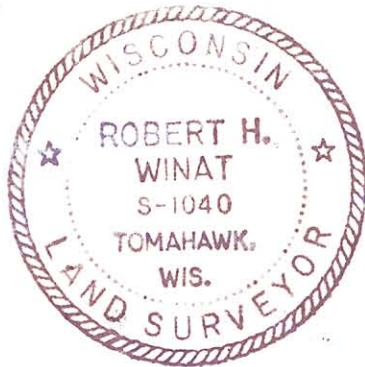

Northwoods Surveyors Inc.

Robert H. Winat
 Land Surveyor

N89°00'E
 208.7'

existing fence line

1.5 acres

N1°00'W
 313.1'

S1°00'E
 313.1'

208.7'
 S89°00'W

Part of the

NW 1/4 of the NW 1/4
 SECTION 9, T31N, R8E

Lincoln County, Wis.

○ = iron pipe set

■ = 6"x6" red granite monument found in place.

RECEIVED AT LINCOLN COUNTY
 COURTHOUSE THIS 18th

OF *Jaw* 1973
Isaac Degeard
 TAX DESCRIPTION OFFICE

SI A

Tomahawk Division