

RECEIVED AT LINCOLN COUNTY
COURTHOUSE THIS DAY
OF 1994

PLAT OF SURVEY

I, David L. Osterbrink, Registered Land Surveyor, hereby certify that i have surveyed and mapped Lots 68 through 79 of Rapel's Subdivision, locvated in the Southeast $\frac{1}{4}$ of Section 4, Township 35 North, Range 6 East, Town of Bradley, Lincoln County, Wisconsin. That I have set the Irons as shown on Page 1 of this document. That I have calculated the acreage of the Lots up to the Meander line with Lake Nokomis.

Subject to easements and roadways of record.
That this survey is correct to the best of my knowledge and belief.

Prepared By:
Northwoods Surveying
623 Jefferson Street
Wausau, WI 54403
715-845-1249

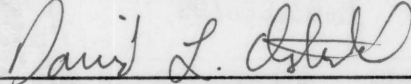
David L. Osterbrink RLS No. S-2014
Survey completed 6-16-94

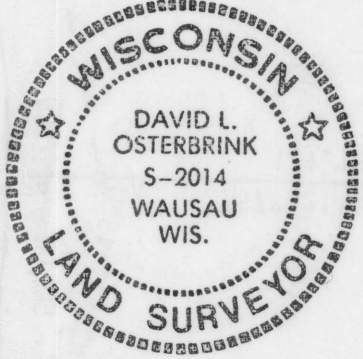

^A
S126