

RECEIVED BY LINCOLN COUNTY
 SURVEYOR THIS 17TH DAY
 OF August 20 23
Zany Paul
 COUNTY SURVEYOR

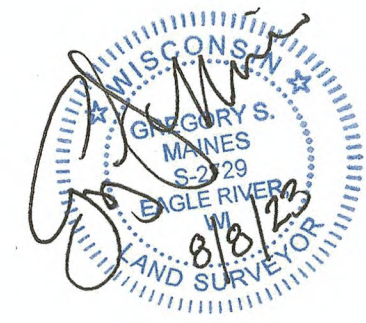

Surveyors Certificate

I hereby certify that I have surveyed the property shown hereon; that this map represents an accurate survey of said property to the best of my knowledge and belief; and that I have complied with the applicable requirements of the Wisconsin Administrative Code Section A-E 7.

Notes:

1. This survey was done without the benefit of a title commitment, there may or may not be easements of record that benefit or burden the subject property.
2. Fieldwork was completed on July 6, 2023.

Lincoln County Grid Bearings:
 Referenced to the west line of the
 NE 1/4 of the NW 1/4 of Section 32
 as bearing N00°05'41"W



- △ Computed position
- ⊗ 1" dia. iron pipe found
- ⊙ 1-1/4" dia. iron pipe found
- ⊕ Electric meter
- () Bearing or distance of record

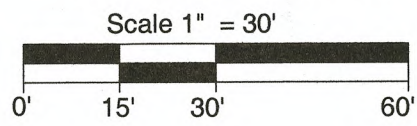

Record Legal Description

The North one-half (N-1/2) of all that part of the Southwest quarter (SW-1/4) of the Northeast quarter (NE-1/4) of the Northwest quarter (NW-1/4) of Section thirty-two (32), Township thirty-five (35) North of Range seven (7) East, in the Town of King, Lincoln County, Wisconsin, which is not overflowed by means of the dam now located in Section 25-35-6.

Position per Lincoln County published coordinates

<p>SHEET 1 OF 1</p> <p>MAP #: 2023200</p> <p>DRAWN BY: JWD</p> <p>DATE: 08/08/2023</p>	<p>Part of the NE 1/4 of the NW 1/4 Section 32, T 35 N, R 7 E Town of King Lincoln County, Wisconsin</p>	<p>PREPARED FOR:</p> <p>Eric and Kimberly Mathewson</p>	 <p>Arbor Vitae, WI 54568 Phone 715.356.9485</p> <p>Eagle River, WI 54521 Phone 715.479.2570</p> <p>www.mainesandassociates.com</p>
--	--	---	--

M 711 B