

**SURVEYOR'S CERTIFICATE**

I, ANTHONY R. JONES, WISCONSIN PROFESSIONAL LAND SURVEYOR No. S-2508, DO HEREBY CERTIFY THAT I HAVE MADE THIS SURVEY UNDER THE DIRECTION OF TOM HERZIGER, THAT THIS MAP, IN MY OPINION, IS A TRUE AND CORRECT REPRESENTATION OF THAT SURVEY AND THAT I HAVE COMPLIED WITH THE PROVISIONS OF CHAPTER AE-7 OF THE WISCONSIN ADMINISTRATIVE CODE.

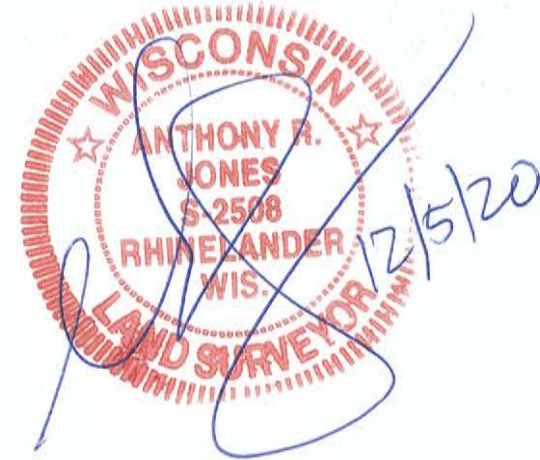

LINCOLN CO. GRID

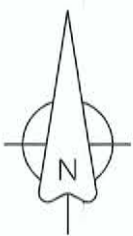

RECEIVED BY LINCOLN COUNTY SURVEYOR THIS 21<sup>ST</sup> DAY OF December 20 20  
*James Dull*  
 COUNTY SURVEYOR



THE INTENT OF THIS SURVEY IS TO RECOVER AND STAKE THE SOUTH EAST LINE OF LOT FOUR OF C.S.M No. 325 AND ESTABLISH THE LOCATION OF THE EXISTING GARAGE/CONCRETE PAD.

**LEGEND**  
 ○ FOUND 1 1/4" IRON PIPE  
 X SET FIBERGLASS POST ON LINE  
 (XXX) DIMENSION OF RECORD -C.S.M. 325

DRAWN BY: ARJ	DATE: 12/05/2020	TOM HERZIGER SITE: FORRESTER RD TRIPOLI, WI 54564 PIN: 03235051629986	PART OF LOT 4, LINCOLN COUNTY CERTIFIED SURVEY MAP No. 325, GOV'T LOT 1, SECTION 16 TOWNSHIP 35 NORTH, RANGE 5 EAST, TOWN OF WILSON, LINCOLN COUNTY, WISCONSIN	A.R. JONES LAND SURVEYING, LLC 2788 SCHWARZ RD. RHINELANDER, WI 54501 715.894.7231 arjsurvey@charter.net
FIELD WORK COMPLETED ON:	DATE: 12/05/2020			
SCALE: 1"=60'	SHEET: 1/1	PROJECT NUMBER: 2020-124		

**M 686 A**