

Bearing Lincoln County Grid,  
based on GPS survey and  
referenced to the north line  
of the NE 1/4, bearing  
S89°54'31"W

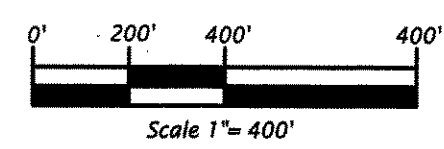

**Legend**  
 ○ = 0.6" dia. x 24" long iron rod set.  
 — = Line brushed & flagged January, 2007.  
 Other corner monuments are as noted.  
 Existing improvements have not  
 been shown hereon.

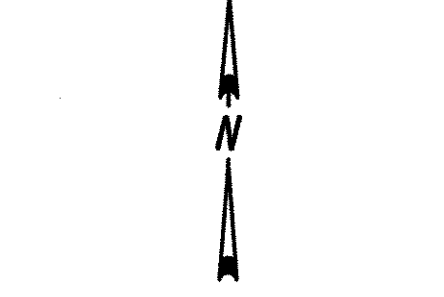
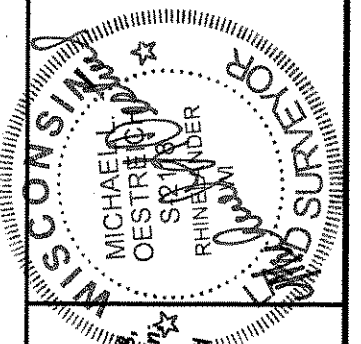

**SURVEYOR'S CERTIFICATE**  
 I, Michael L. Oestreich, Registered Land Surveyor No. 5-2113, hereby certify that I have surveyed the property shown hereon, that this map represents an accurate survey of said property to the best of my knowledge and belief; that I have performed this survey by order of Matt Woller, and that I have complied with the requirements of Wisconsin Administrative Code A-E-7.  
 Date: 2/02/07

**Oestreich Surveying & Mapping, LLC**  
 Rhinelander, WI 54501  
 5946 Forest Lane  
 Tel. (715) 362-5538  
 RLS2118@charter.net

Drafted by: M. Oestreich  
 File No. 1-2-337  
 Map No. 07-02  
 Sheet 1 of 1 sheet

THE  
**NE 1/4 OF THE NE 1/4**  
**SECTION 2, T33N, R7E**  
 BIRCH TOWNSHIP  
 LINCOLN COUNTY, WISCONSIN

RECEIVED BY LINCOLN COUNTY  
 SURVEYOR THIS 6<sup>TH</sup> DAY  
 OF February 2007  
Tom Dahl  
 COUNTY SURVEYOR

M534A