

Burma Road

M532B

NW - NE

NE - NE

SW - NE

SE - NE

NW 1/4

NE 1/4

6" x 6" granite mon.  
found in place.



N0°16'31"E 2597.10'

Corner position  
not monumented.  
1.6" dia. well point  
bears N82°10'E 57.74'



CE 1/16 Corner  
Corner position  
not monumented.

6" x 6" granite mon.  
found in place.



1" dia. iron rod  
found in place.



1334.68'

N89°28'21"E 2669.36'

1334.68'



N89°50'11"E 2554.34'

1328.67'

N89°50'11"E 2657.34'

1328.67'

Bearings Lincoln County Grid,  
based on GPS survey data.



0' 200' 400' 800'

Scale 1" = 400'

Corner monuments are as noted.

NW - SE

NE - SE

CS 1/16 Corner  
Set 0.6" dia. x 36"  
long iron rod.

SE 1/16 Corner  
Set 0.6" dia. x 36"  
long iron rod.

S 1/16 Corner  
Corner position  
not monumented.

2623.30'

N0°16'31"E

erroneous blaze line

erroneous blaze line



6" x 6" granite mon.  
found in place.

1318.31'

N89°49'59"W 2636.62'

1318.31'

E 1/16 Corner  
Set 0.6" dia. x 36"  
long iron rod.  
1.6" dia. iron pipe  
bears S52°47'W 19.01'

6" x 6" granite mon.  
found in place.



THE SOUTH LINE OF THE  
**SW 1/4 OF THE NE 1/4  
SECTION 35**  
THE NORTH AND WEST LINE OF THE  
**SW 1/4 OF THE SE 1/4  
SECTION 36**  
**T33N, R5E**  
HARDING TOWNSHIP  
LINCOLN COUNTY, WISCONSIN

**SURVEYOR'S CERTIFICATE**

I, Michael L. Oestreich, Registered Land Surveyor No. S-2118, hereby certify that I have surveyed the property shown herein; that this map represents an accurate survey of said property to the best of my knowledge and belief; that I have performed this survey by order of Timothy Oestreich; and that I have complied with the requirements of Wisconsin Administrative Code A-E 7.

Date: 12/06/06

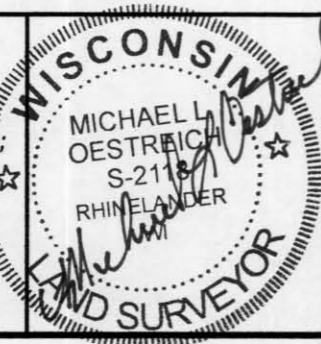

**Oestreich Surveying & Mapping, LLC**

5946 Forest Lane Rhineland, WI 54501  
Tel. (715) 362-5538 RLS2118@charter.net

File No. 35 & 36-335

Drafted by: M. Oestreich

Map No. 05-08

Sheet 1 of 1 sheet

RECEIVED BY LINCOLN COUNTY  
SURVEYOR THIS 3<sup>RD</sup> DAY  
OF January 20 07  
Timothy Oestreich  
COUNTY SURVEYOR