

Part of the
NW 1/4 of the NE 1/4 of the NW 1/4
and all of the
S 1/2 of the SE 1/4 of the NW 1/4
Section 13, T 34 N, R 05 E
Tomahawk Township
Lincoln County, Wisconsin

SECTION SUBDIVISION DETAIL

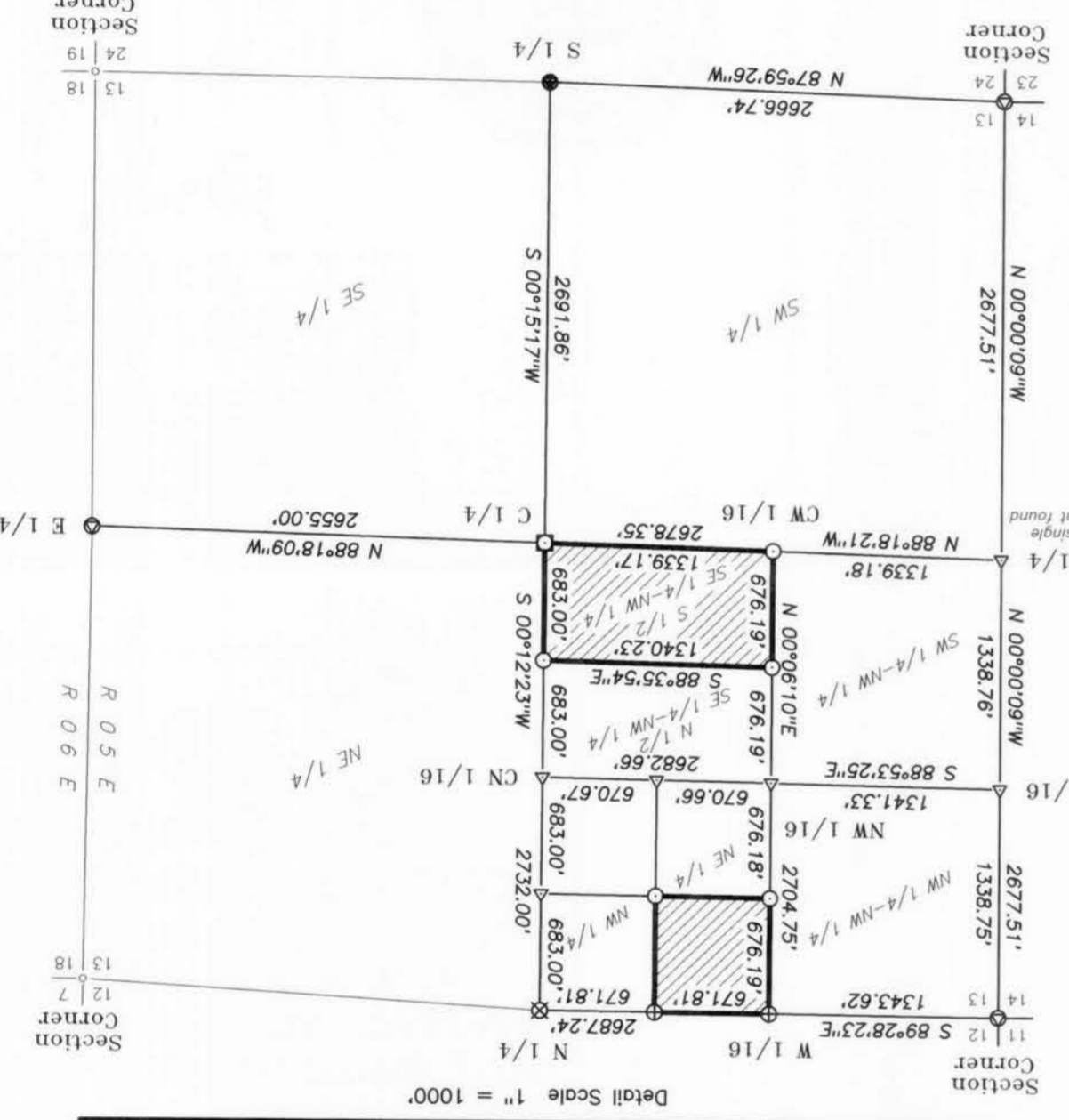

Detail Scale 1" = 1000'

ASSUMED NORTH:
referenced to the north line of
Northwest 1/4 of Section 13 per
map of survey by R.C. Wylie, dated
August 1990, Dwg. No. 89003-A
i.e. S 89°28'23"E.

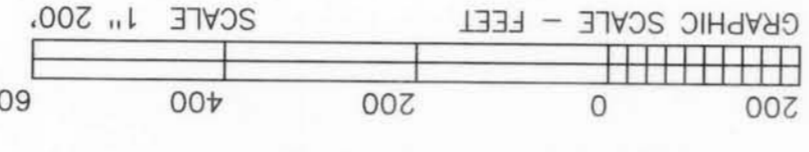
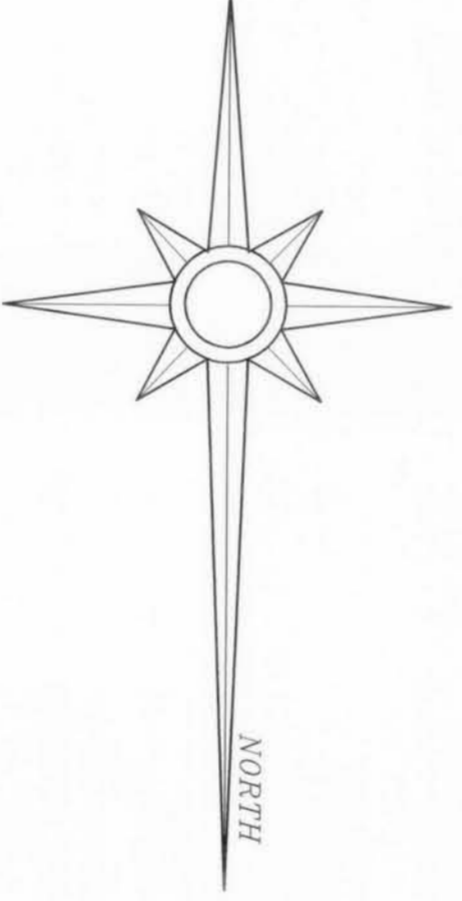

LEGEND:
○ 1-1/4" diameter iron pipe set
⊕ steel survey pin set in highway pavement
⊗ steel survey pin found in highway pavement
● 1" diameter iron pipe found
□ 2" diameter iron pipe found
⊙ 3" diameter capped Bernsten monument found
△ computed position, no monument set or found

I hereby certify that I have surveyed the property shown hereon; that this map represents an accurate survey and that I have complied with the applicable requirements of the Wisconsin Administrative Code Section A-E 7. Legal descriptions provided on a separate sheet.
Date 12-14-04
David A. Konopacky
Registered Land Surveyor No. 2566



BOUNDARY SURVEY FOR:
Paul Reid, LLC
P.O. Box 997
Eagle River, WI 54521
NORTHWOODS SURVEYING
P.O. BOX 1002
LAND O'LAKES, WISCONSIN 54540
MAP NO. 228
SCALE: 1" = 200'
DATE: 12/14/04
DRAFTED BY: DAK

RECEIVED BY LINCOLN COUNTY
SURVEYOR THIS 26TH DAY
OF April 20 05
Tom Reid
COUNTY SURVEYOR

M500A

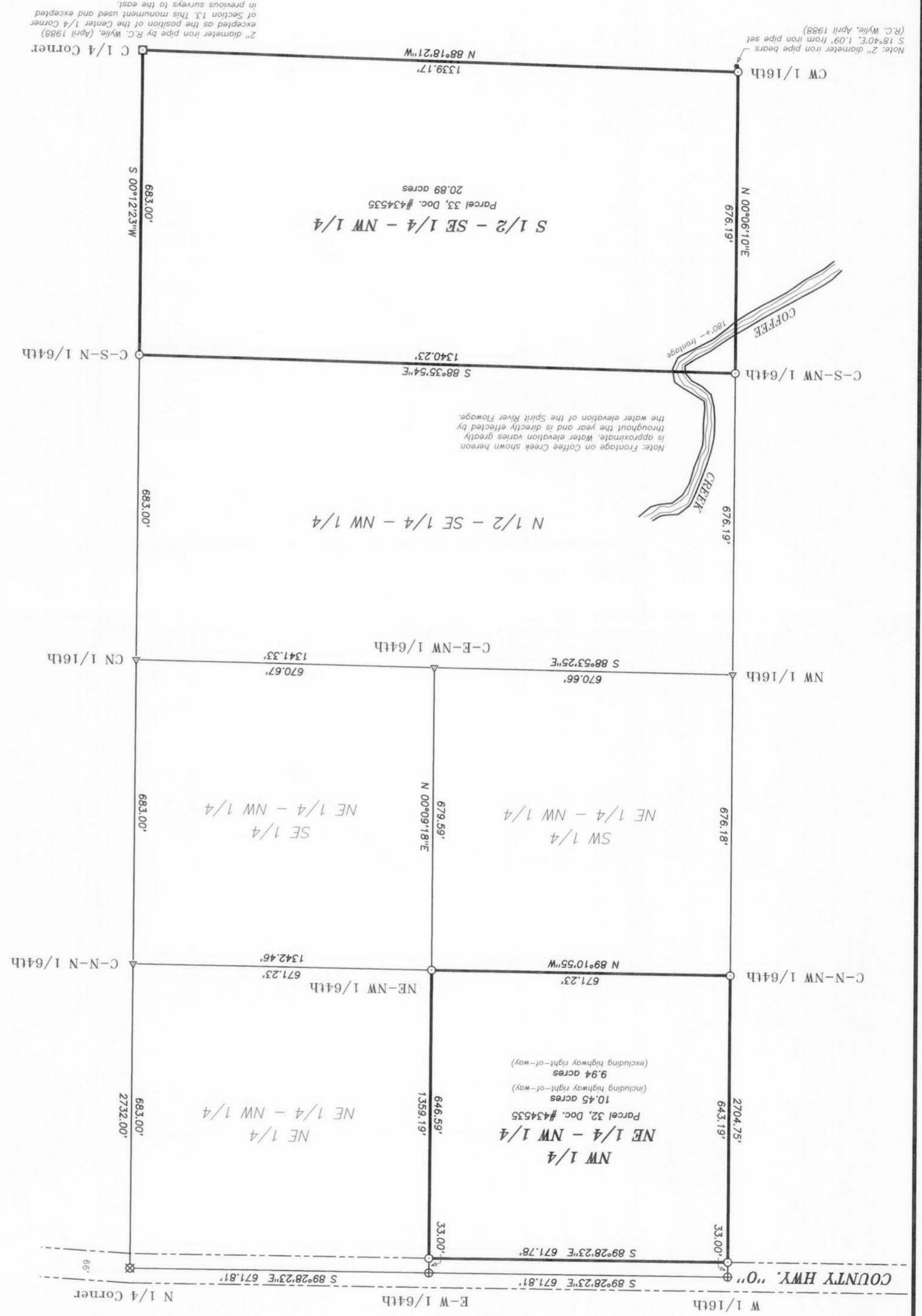

Note: 2" diameter iron pipe set
S 18°40'E, 1.09' from iron pipe set
(R.C. Wylie, April 1988)
Note: Fringe on Coffee Creek shown hereon
is approximate. Water elevation varies greatly
throughout the year and is directly effected by
the water elevation of the Spirit River Flowage.

2" diameter iron pipe by R.C. Wylie, (April 1988)
excepted as the position of the Center 1/4 Corner
of Section 13. This monument used and excepted
in previous surveys to the east.

Parcel 32, Doc. #434535
10.45 acres
(including highway right-of-way)
9.94 acres
(excluding highway right-of-way)

Parcel 33, Doc. #434535
20.89 acres

Parcel 33, Doc. #434535
20.89 acres

Parcel 33, Doc. #434535
20.89 acres

Parcel 33, Doc. #434535
20.89 acres

Parcel 33, Doc. #434535
20.89 acres

Parcel 33, Doc. #434535
20.89 acres

Parcel 33, Doc. #434535
20.89 acres

Parcel 33, Doc. #434535
20.89 acres

Parcel 33, Doc. #434535
20.89 acres

Parcel 33, Doc. #434535
20.89 acres

Parcel 33, Doc. #434535
20.89 acres

Parcel 33, Doc. #434535
20.89 acres

Parcel 33, Doc. #434535
20.89 acres

Parcel 33, Doc. #434535
20.89 acres

Parcel 33, Doc. #434535
20.89 acres

Parcel 33, Doc. #434535
20.89 acres

Parcel 33, Doc. #434535
20.89 acres

Parcel 33, Doc. #434535
20.89 acres

Parcel 33, Doc. #434535
20.89 acres

Parcel 33, Doc. #434535
20.89 acres

Parcel 33, Doc. #434535
20.89 acres

Parcel 33, Doc. #434535
20.89 acres