

REPLACED WITH LINCOLN CO. MONUMENT

LOCATED IN THE SE 1/4 OF THE NW 1/4, SECTION 29, T35N, R6E, TOWN OF BRADLEY, LINCOLN CO. WI

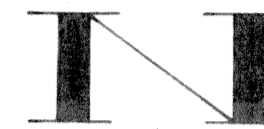

BEARINGS REFERENCED TO THE NORTH LINE OF SECTION 29, T35N, R6E, ASSUMED TO BE AN N 88°01'23" E

**LEGEND:**

- FOUND 1" IRON PIPE
- ⊙ FOUND 2" IRON PIPE
- FOUND 1 1/2" IRON PIPE
- ▲ FOUND R/W POST
- FOUND BERNTSEN MONUMENT
- SET 1" X 24" IRON PIPE
- △ SET R/R SPIKE
- △ CALCULATED POSITION
- △ FOUND NAIL REPLACED WITH LINCOLN CO. MONUMENT

RECEIVED AT LINCOLN COUNTY COURTHOUSE THIS 13<sup>TH</sup> DAY OF August 20 01  
*Jerry Dush*  
 LAND INFORMATION OFFICE

I, RUSSELL F. BROWN, HEREBY CERTIFY THAT I HAVE SURVEYED THE ABOVE PARCEL OF LAND UNDER THE DIRECTION OF DENISE HARKNESS AND THAT THE ABOVE MAP IS A TRUE AND CORRECT REPRESENTATION OF THE LANDS SURVEYED TO THE BEST OF MY KNOWLEDGE AND BELIEF THAT I HAVE PROVIDED A DESCRIPTION OF THE PARCEL ON A SEPARATE SHEET, AND THAT I HAVE COMPLIED WITH THE PROVISIONS OF AE 7 OF THE WISCONSIN ADMINISTRATIVE CODE.

*Russell F. Brown* 8/23/00  
 RUSSELL F. BROWN DATE

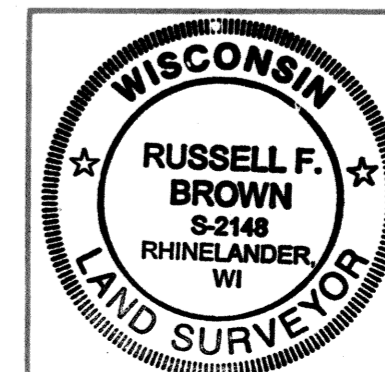

SURVEY FOR  
**RONALD & DENISE HARKNESS**

SCALE 1" = 200' DATE 8/23/00 DWN. BY JB

DWG. NO. 10191 GENISOT AND ASSOCIATES, INC. RHINELANDER, WIS.

M455