

Part of the  
**SW 1/4, of the SW 1/4**

**SECTION 8**

**T. 34 N., R. 6 E.**

Town of Bradley

Lincoln County, Wis.

**Belliveau Road**

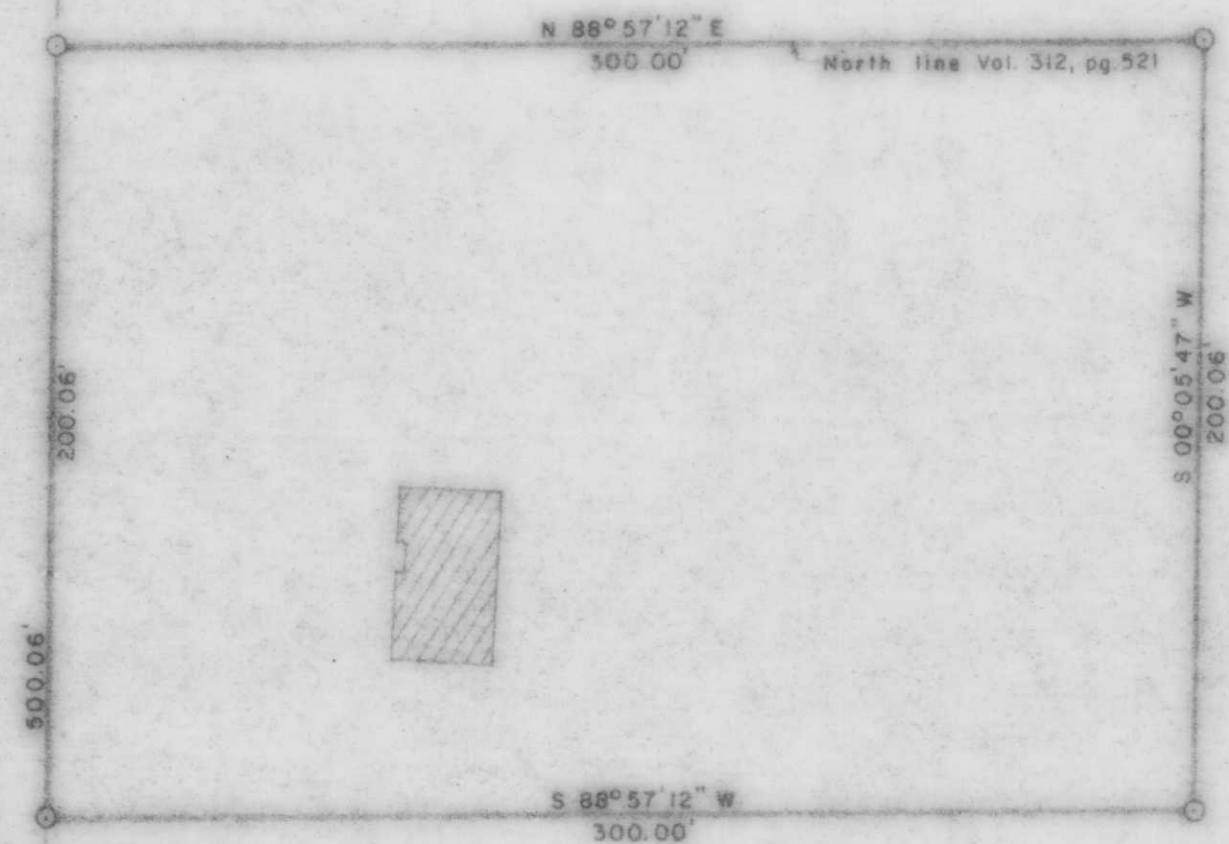

BEARINGS SOLAR

**LEGEND**

- ▣ RAILROAD SPIKE FOUND IN PLACE.
- 1 1/4" IRON PIPE SET THIS SURVEY.
- ▨ DENOTES BUILDING.

Section Line

SW Cor., Sec. 8

RECEIVED AT LINCOLN COUNTY  
 COURTHOUSE THIS 23rd DAY  
 OF Oct 1985.  
Pat Prieb  
 TAX DESCRIPTION OFFICE

<b>TIMBERLAND SURVEYORS, INC.</b> TOMAHAWK WIS. SURVEY FOR <b>LEROY BRUMMEL</b> <b>ROUTE 4</b> <b>TOMAHAWK, WIS.</b>	
	DATE 20 JUN 83 DWN. BY L.J.S. SCALE 1" = 50' REVISED BY DWG. NO. REVISED BY <b>497</b>

**B**